



High Hilden Close, Tonbridge, Kent, TN10 3DA
Guide: £230,000 – Freehold

JAMES MILLARD
INDEPENDENT ESTATE AGENTS



- *Detached One Bedroom Bungalow
- *Potential to develop plot subject to planning permission
- *Quiet Yet Convenient Location Walkable to Town & Station
- *Double Bedroom with French Doors
- *Open Plan Living Space & Modern Kitchen
- *Refurbished Contemporary Shower Room
- *Attractive Private Garden
- *Ideal Investment or First Purchase

Description

This smart one bedroom bungalow is situated on the private lane of High Hilden Close, yet within walking distance of the town and station offering fast services to London. This tucked away bungalow is presented in lovely order throughout, enjoying an impressive private and mature garden with scope to extend/ develop subject to planning permissions. Offered for sale with no onward chain.

Accommodation

- The front of the property is approached over the private garden and mature shrub/tree boundaries. There is space to add in off street parking.
- You enter the bungalow directly into the living area through wooden framed French doors which is neutrally decorated with characterful Parquet flooring running throughout and into the double bedroom that also has doors leading out to a separate private courtyard area.
- Contemporary refitted shower room fitted with a white suite comprising shower cubicle with wall mounted electric shower, close coupled toilet and pedestal basin. Neutrally decorated walls with contrasting feature tile splashback and underfloor heating.
- The compact kitchen leads directly off the living area and is semi-open plan with delightful views over the garden through the pretty wooden French doors. Recently refitted with a contemporary feel there is a fitted undercounter oven and microwave, electric hob, space for an undercounter fridge and modern metro tiled splash back. With a range of under counter and wall mounted shaker style cupboards.



- The attractive south facing private garden has a real cottage feel about it and is laid to lawn interspersed with mature tree and shrubs/ flower borders, a pretty pond, pathways and seating areas to enjoy. Fenced and mature hedge boundaries provide privacy.
- Services & Points of Note: Mains water, electricity. Electric heaters.
- Council Tax Band: TBC – Tonbridge & Malling Borough Council
- EPC: F

Situation

Conveniently situated on the borders of the village of Hildenborough with main line station, shops and local amenities and Tonbridge a market and commuter town situated on the banks of the river Medway with Norman castle and riverside park. The town offers a good range of shops, supermarkets, restaurants, bars and cafes, leisure centres, a swimming pool and tennis courts. There are excellent primary and secondary schools locally in both state and private sectors including Weald of Kent, Tonbridge and Judd grammar schools, as well as Hillview and Hayesbrook secondary schools. Tonbridge main line station provides fast services to Cannon Street/ London Bridge/Charing Cross in about 40 minutes. The A21 and A26 linking to the M25 and M20 are easily accessible.



Viewing Strictly By Appointment

01732 834835

www.jamesmillard.co.uk
hildenborough@jamesmillard.co.uk

The Annexe, 34 London Road

Gross Internal Area : 28.6 sq.m (307 sq.ft.)

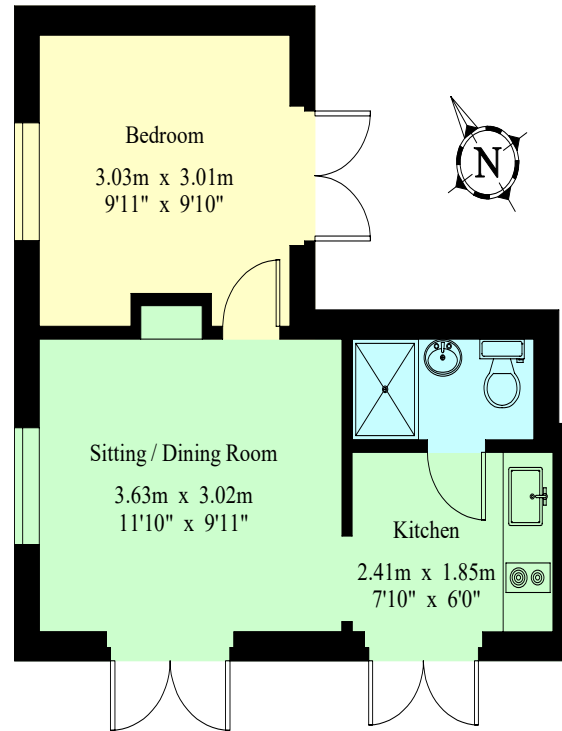

Ground Floor

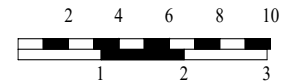

For Identification Purposes Only.
© 2026 Trueplan (UK) Limited (01892) 614 881

James Millard Independent Estate Agents, their clients and any joint agents give notice that: 1.They have no authority to make or give any representations or warranties in relation to the property. These particulars are given in good faith and are to be treated as a general guide only and do not constitute any part of an offer or a contract and must not be relied upon as statements or representations of fact. All statements contained in these particulars are made without any responsibility on the part of James Millard Independent Estate Agents or the vendor or lessor of this property. Any intending purchasers must satisfy themselves by inspection or otherwise as to the correctness of each of the statements contained in these particulars. If any points are particularly relevant to your interest in the property please ask for further information. 2. Any areas, measurements or distances are approximate. The text, photographs and plans are for guidance only and are not necessarily comprehensive. It should not be assumed that the property has all necessary planning, building regulation or other consents. 3. It should not be assumed that any contents, furnishings, furniture etc photographed are included in the sale, nor that the property remains as displayed in the photographs. No assumptions should be made with regard to parts of the property that have not been photographed. 4. Prospective purchasers are advised to satisfy themselves as to the working order of any apparatus, equipment, fixtures and fittings or services where applicable. Whilst they may be mentioned in the particulars, they have not been tested by the Agents. J205

