



jordan fishwick

24 Waterways Avenue, Macclesfield, SK11
PCM £1,350 PCM



Waterways Avenue Cheshire SK11 7NF

£1,350 PCM



*****LET IN 24 HOURS*****

This stunning 3 bedroom semi detached house is located on this quiet cul de sac and is only a short walk from the Macclesfield town centre and the train station.

Entrance hall, living room, kitchen / diner, downstairs WC. To the first floor three well proportioned bedrooms, main bedroom with ensuite shower room and a family bathroom.

Private fully enclosed garden rear garden. Off road parking for two cars.

Contact Macclesfield 01625 502222

EPC rating B

Cheshire East C

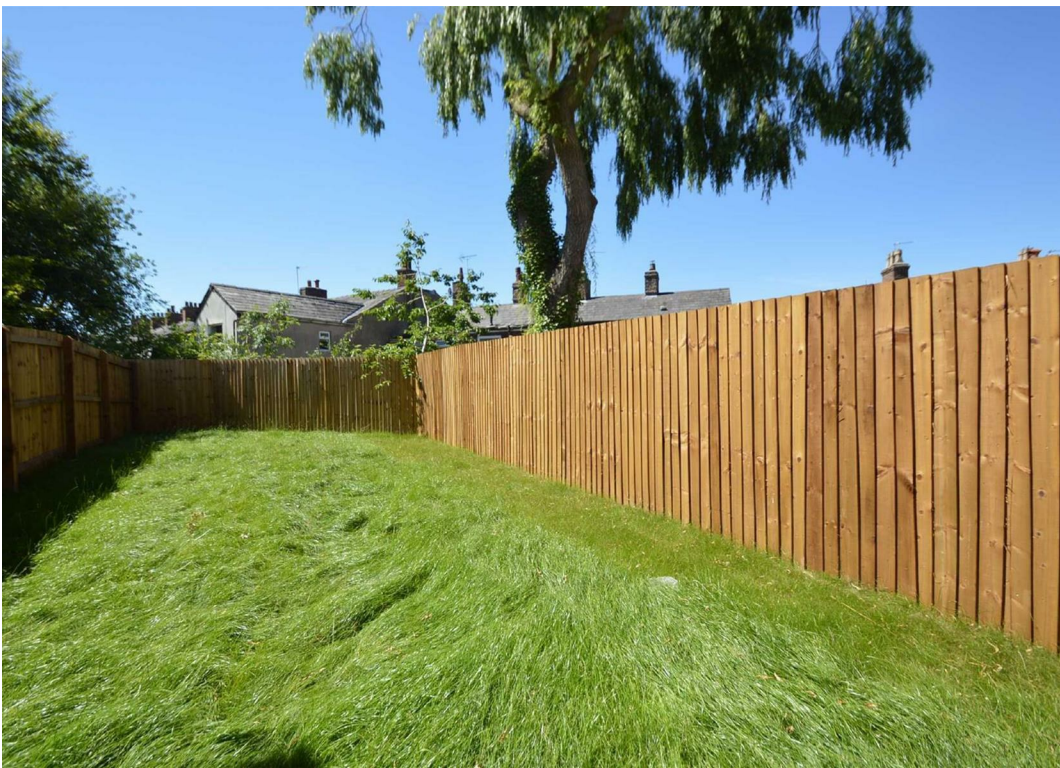

- THREE BEDROOMS
- MODERN INTERIOR
- TWO BATHROOMS
- ENCLOSED SUNNY REAR GARDEN
- EPC B
- COUNCIL TAX C



Energy Efficiency Rating		
	Current	Potential
Very energy efficient - lower running costs		
(92 plus) A		97
(81-91) B	84	
(69-80) C		
(55-68) D		
(39-54) E		
(21-38) F		
(1-20) G		
Not energy efficient - higher running costs		
England & Wales	EU Directive 2002/91/EC	



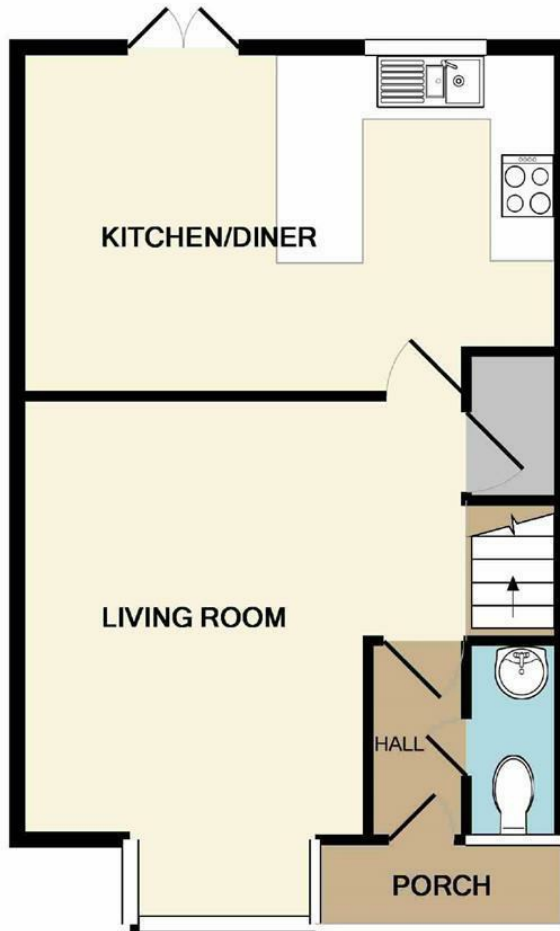

GROUND FLOOR

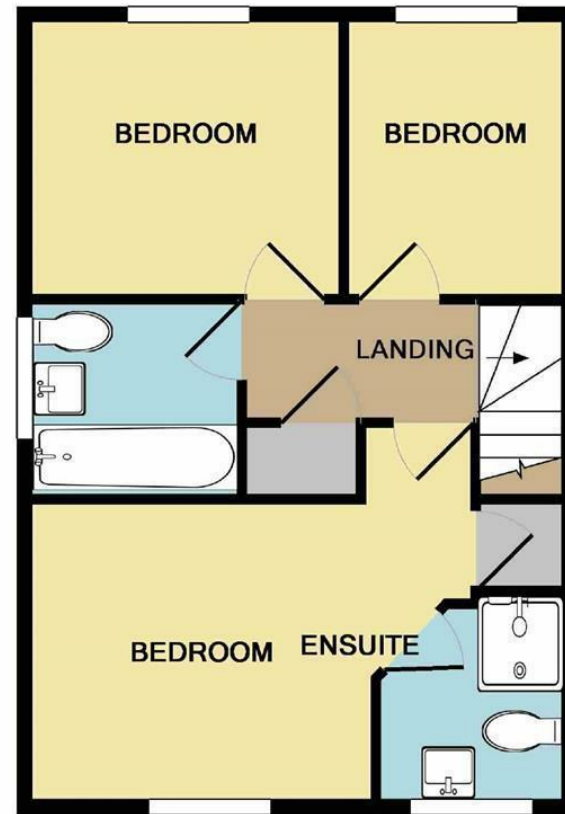

1ST FLOOR

Measurements are approximate. Not to scale. Illustrative purposes only
Made with Metropix ©2018



These particulars are believed to be accurate but they are not guaranteed and do not form a contract. Neither Jordan Fishwick nor the vendor or lessor accept any responsibility in respect of these particulars, which are not intended to be statements or representations of fact and any intending purchaser or lessee must satisfy himself by inspection or otherwise as to the correctness of each of the statements contained in these particulars. Any floorplans on this brochure are for illustrative purposes only and are not necessarily to scale.

Offices at: Chorlton, Didsbury, Disley, Hale, Glossop, Macclesfield, Manchester Deansgate, Manchester Whitworth Street, New Mills, Sale, Wilmslow and Withington

36-38 Alderley Road, Wilmslow SK91JX
01625 532000

wilmslow@jordanfishwick.co.uk
www.jordanfishwick.co.uk