



*jordanfishwick*

Hurdsfield Road

£795 Per Month





## Hurdsfield Road, Macclesfield, SK10 2PY

**£795 Per Month**

PART FURNISHED AVAILABLE MID JUNE

This charming 1-bedroom cottage is located on Hurdsfield Road and benefits from being within walking distance of the town centre and train station along with being within easy reach of open countryside and Macclesfield canal.

With a cozy reception room and a modern kitchen to the ground floor with gas cooker, fridge and freezer and stable door leading to a small communal garden.

A really nice sized double bedroom along with a spacious bathroom with separate shower cubicle to the first floor will make this property an ideal choice for the single professional or couple.

Don't miss out on the opportunity to make this lovely house your home on this extremely popular road in Macclesfield.

Call Macclesfield 01625 502 222 £795.00pcm

Council Tax A

EPC D

### LOCATION

Within easy reach of AstraZeneca and in walking distance of Macclesfield train station, this property is ideal for a single professional or couple.

Set in Cheshire's plains, on the fringe of the Peak District National Park, Macclesfield combines the old with the new. Originally a medieval town, Macclesfield became the country's 'Silk' capital in the 1750's, whilst it still retains that heritage, in recent years it has grown to become a thriving business centre. Macclesfield is a modern shopping centre with a range of leisure facilities to suit most tastes. There is a popular monthly Treacle Market which is a bustling Arts, Antiques, Crafts, Food and Drink Market, held on the cobbles of the town centre with around 140 stalls of exceptional food and drink, unique crafts and vintage items along with information from the Macclesfield community. There are many independent and state primary and secondary schools. The access points of the North West Motorway network system, Manchester International Airport and some of Cheshire's finest countryside are close at hand. Intercity rail links to London Euston and Manchester Piccadilly can be found at Macclesfield and Wilmslow railway stations as well as commuter rail links to the local business centres.

### DIRECTIONS

Proceed from Macclesfield town centre onto Hibel Road. At the Tesco roundabout, go straight across onto Hurdsfield Road. Continue on Hurdsfield Road until Hurdsfield Church is on the right and the property will be found on the left hand side.

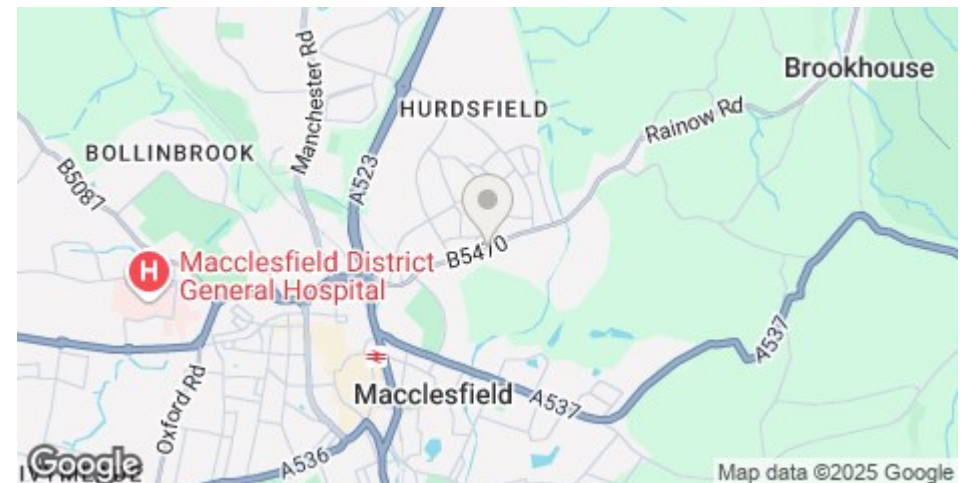



- ATTRACTIVE COTTAGE
- ONE BEDROOM
- COMMUNAL GARDEN
- WELL PROPORTIONED BEDROOM AND BATHROOM
- COUNCIL TAX A
- EPC D

Postcode - SK10 2PY

EPC Rating - D

Floor Area - sq ft

Local Authority - Cheshire East

Council Tax - A



GROUND FLOOR

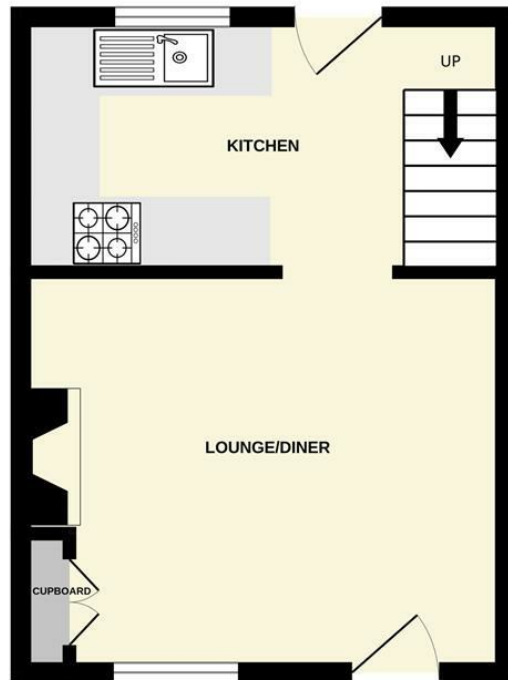

1ST FLOOR

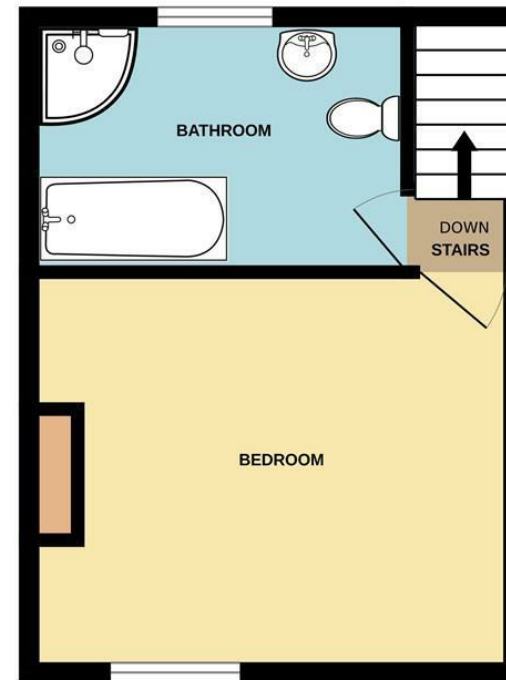

Measurements are approximate. Not to scale. Illustrative purposes only  
Made with Metropix ©2025



These particulars are believed to be accurate but they are not guaranteed and do not form a contract. Neither Jordan Fishwick nor the vendor or lessor accept any responsibility in respect of these particulars, which are not intended to be statements or representations of fact and any intending purchaser or lessee must satisfy himself by inspection or otherwise as to the correctness of each of the statements contained in these particulars. Any floorplans on this brochure are for illustrative purposes only and are not necessarily to scale.

Offices at: Offices at Chorlton, Didsbury, Disley, Hale, Glossop, Macclesfield, Manchester Deansgate, Manchester Whitworth Street, New Mills, Sale, Wilmslow and Withington

01625 502222 letting