



jordan fishwick

26 Sagars Road, SK9 3EE
Guide Price £599,950



Sagars Road Handforth SK9 3EE

Guide Price £599,950



Located within walking distance of Handforth Village this extended and beautifully presented four bedroom detached property is located on popular Sagars Road which is a tree lined and established road within this sought after area. Handforth village offers a number of local shopping facilities restaurants and train station. Wilmslow is a short drive away offering additional amenities with Wilmslow train station providing a direct service to London Euston and Manchester City centre. This spacious property consists in brief of an entrance hallway which provides level access to four bedrooms and the stunning open plan living, dining and kitchen area. This amazing space spans the entire of the rear of the property and is a massive highlight. There are three well-proportioned double bedrooms with the principal bedroom boasting an ensuite shower room and a generously proportioned walk in wardrobe, with the fourth bedroom currently being used as a study. The spacious and highly sociable open plan living space features a modern and quality fitted kitchen with large island unit providing extra worktops and food preparation surfaces. There are a number of ceiling skylights providing a source of natural light whilst creating a very modern aesthetic. There is ample space for a dining room table and chair set and further space for living room furniture. Two separate sets of sliding patio doors provide access to the rear garden. There is a staircase providing access to the loft space which is a versatile area offering extra storage for the property and has a WC and bathroom. Externally, the property benefits from a mature and enclosed rear garden with large detached garage providing extra storage. To the front of the property there is off-road parking for several vehicles and a further mature front garden with lawn area.



- Detached Property
- Four Bedrooms
- Ensuite and Walk in Wardrobe
- Spacious Open plan Kitchen and living space
- Detached Garage
- Off road parking
- Garden
- Village Location



Energy Efficiency Rating		
	Current	Potential
Very energy efficient - lower running costs		
(92 plus) A		
(81-91) B		81
(69-80) C	70	
(55-68) D		
(39-54) E		
(21-38) F		
(1-20) G		
Not energy efficient - higher running costs		
England & Wales		EU Directive 2002/91/EC 



GROUND FLOOR

1ST FLOOR

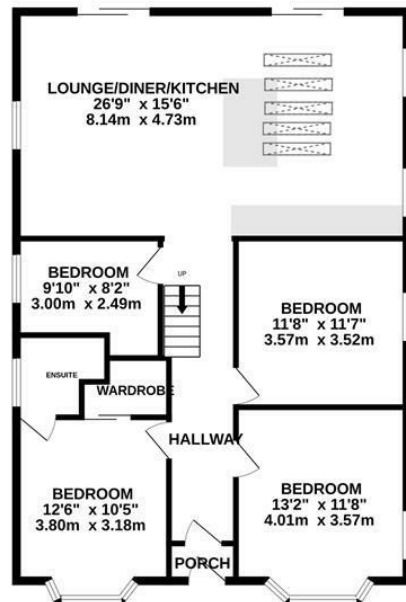
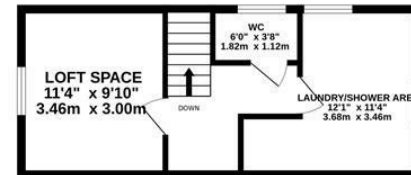
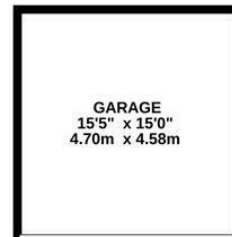

Measurements are approximate. Not to scale. Illustrative purposes only
Made with Metropix ©2025



These particulars are believed to be accurate but they are not guaranteed and do not form a contract. Neither Jordan Fishwick nor the vendor or lessor accept any responsibility in respect of these particulars, which are not intended to be statements or representations of fact and any intending purchaser or lessee must satisfy himself by inspection or otherwise as to the correctness of each of the statements contained in these particulars. Any floorplans on this brochure are for illustrative purposes only and are not necessarily to scale.

Offices at: Chorlton, Didsbury, Disley, Hale, Glossop, Macclesfield, Manchester Deansgate, Manchester Whitworth Street, New Mills, Sale, Wilmslow and Withington

36-38 Alderley Road, Wilmslow SK91JX
01625 532000

wilmslow@jordanfishwick.co.uk
www.jordanfishwick.co.uk