



jordan fishwick

13b Wilton Road, M21 9GS
Guide Price £1,080 Per Calendar Month



Wilton Road Chorlton M21 9GS

£1,080 Per Calendar Month



The Property

**** AVAILABLE **** We are delighted to offer this spacious one bedroom first floor apartment situated on one of Chorlton Greens popular roads and within walking distance to Beech Road with an array of bars, restaurants and Transport links. The accommodation offered is ideal for a professional couple or individual, briefly comprises; own private entrance with large hall, modern fully fitted kitchen, large lounge, double bedroom, modern bathroom. The apartment has double glazing, gas central heating and a security alarm installed. and is offered on an unfurnished basis.

***** To arrange a viewing please call 0161 393 7539 *****

- Council Tax band A - EPC D
- Stylish First Floor Apartment
- Modern Kitchen & Bathroom
- One Double Bedroom
- Unfurnished
- Chorlton Green location
- Available October



Energy Efficiency Rating		
	Current	Potential
Very energy efficient - lower running costs		
(92 plus) A		77
(81-91) B		
(69-80) C		
(55-68) D	66	
(39-54) E		
(21-38) F		
(1-20) G		
Not energy efficient - higher running costs		
England & Wales		EU Directive 2002/91/EC 



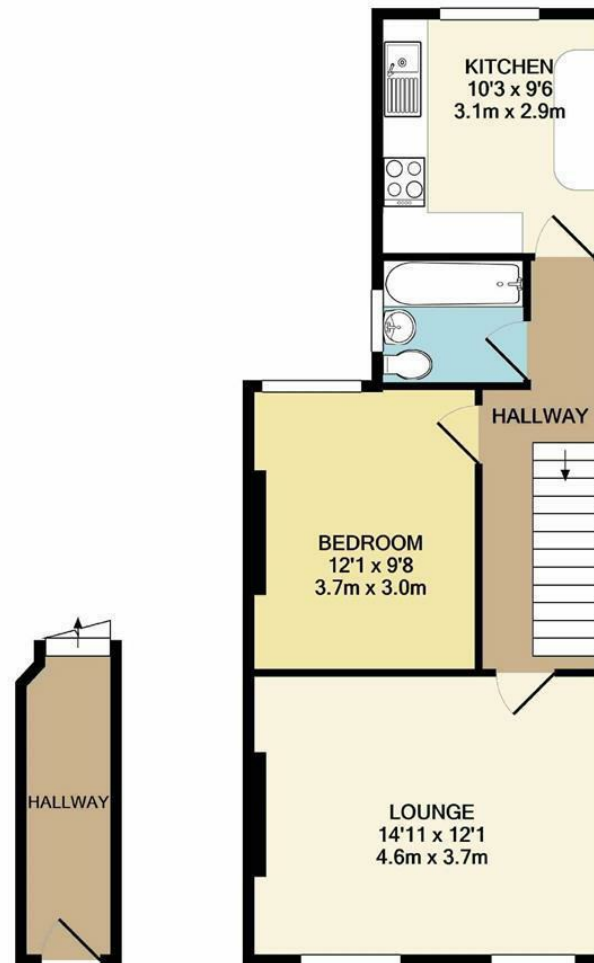

GROUND FLOOR
APPROX. FLOOR
AREA 53 SQ.FT.
(4.9 SQ.M.)

1ST FLOOR
APPROX. FLOOR
AREA 502 SQ.FT.
(46.7 SQ.M.)

TOTAL APPROX. FLOOR AREA 555 SQ.FT. (51.6 SQ.M.)

Measurements are approximate. Not to scale. Illustrative purposes only
Made with Metropix ©2021



These particulars are believed to be accurate but they are not guaranteed and do not form a contract. Neither Jordan Fishwick nor the vendor or lessor accept any responsibility in respect of these particulars, which are not intended to be statements or representations of fact and any intending purchaser or lessee must satisfy himself by inspection or otherwise as to the correctness of each of the statements contained in these particulars. Any floorplans on this brochure are for illustrative purposes only and are not necessarily to scale.

Offices at: Chorlton, Didsbury, Disley, Hale, Glossop, Macclesfield, Manchester Deansgate, Manchester Whitworth Street, New Mills, Sale, Wilmslow and Withington