



jordan fishwick

NORTHENDEN
Cedarwood Close



Cedarwood Close, Northenden, M22 4QJ

£385,000



The Property

An impressive semi detached townhouse forming part of a purpose built development by Bett Homes, with a convenient location which is within easy reach of Northenden Village, the motorway network, Manchester Airport and city centre. The spacious living space is presented to a high standard and arranged over three floors, extending over 1336 sq ft with numerous noteworthy features including four double bedrooms, two modern bathrooms, a lovely & light breakfast kitchen with a comprehensive range of units, useful utility/cloaks, two additional reception rooms, uPVC double glazing and gas central heating. In addition, there is an easy to maintain garden with decked seating area and a driveway providing parking.

Directions

M22 4QJ



- Impressive semi detached townhouse
- Living space over three floors
- High level of presentation
- Four double bedrooms
- Two modern bathrooms
- Superb breakfast kitchen
- Gas central heating
- uPVC double glazing
- Driveway & enclosed garden
- Close to Northenden Village

Postcode - M22 4QJ

EPC Rating - C

Floor Area - 1336.00 sq ft

Local Authority - Manchester City Council

Council Tax - D



GROUND FLOOR
478 sq.ft. (44.4 sq.m.) approx.

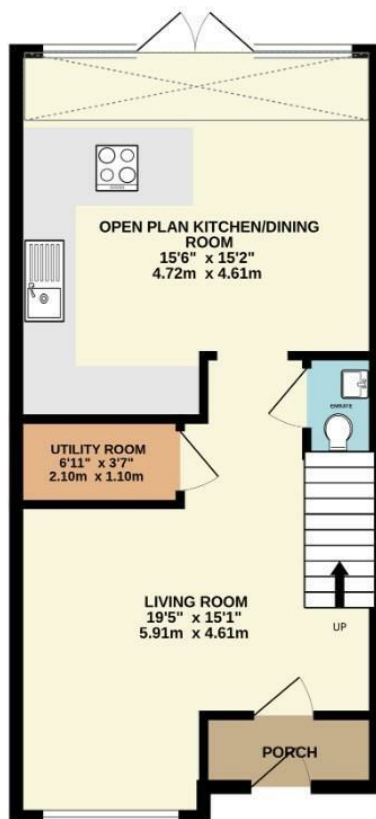

1ST FLOOR
424 sq.ft. (39.4 sq.m.) approx.

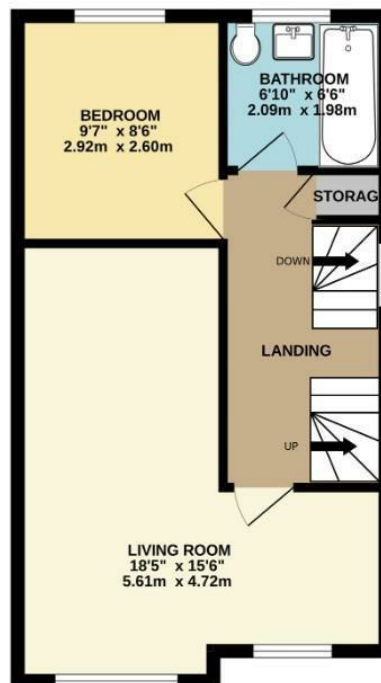

2ND FLOOR
434 sq.ft. (40.3 sq.m.) approx.

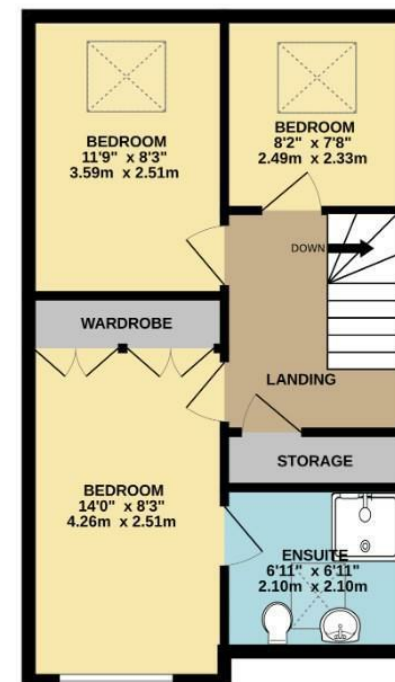

TOTAL FLOOR AREA : 1336 sq.ft. (124.2 sq.m.) approx.
Measurements are approximate. Not to scale. Illustrative purposes only
Made with Metropix ©2025



These particulars are believed to be accurate but they are not guaranteed and do not form a contract. Neither Jordan Fishwick nor the vendor or lessor accept any responsibility in respect of these particulars, which are not intended to be statements or representations of fact and any intending purchaser or lessee must satisfy himself by inspection or otherwise as to the correctness of each of the statements contained in these particulars. Any floorplans on this brochure are for illustrative purposes only and are not necessarily to scale.

Offices also at: Wilmslow, Macclesfield, Hale, Sale, Chorlton, Glossop, Manchester & Salford

757-759 Wilmslow Road, Didsbury Village, Manchester

0161 445 4480

didsbury@jordanfishwick.co.uk
www.jordanfishwick.co.uk