



jordanfishwick

6 Old Moat Lane, M20 3GF
£1,100 Per Calendar Month



Old Moat Lane Withington M20 3GF

£1,100 Per Calendar Month



The Property

*** AVAILABLE FEBRUARY *** This delightful two bedroomed first floor apartment is conveniently located in the heart of Withington village and is offered on a fully furnished basis, making it ideal for a couple or professional sharers alike. Modern, light and airy, with the benefit of a balcony off the main living area. The kitchen is fully fitted and includes white goods. Both of the bedrooms are doubles, and the separate bathroom comprises of a modern white suite, including a shower over bath. Gated, unallocated on-site parking subject to availability. On street parking available without the need for a permit from the council, at the time of writing. Viewings a must to appreciate this ideally located apartment, please call 0161 438 2411.

View our Virtual Tour Here - https://youtu.be/SLz_p3rbif8

EPC Rating B / Council Tax Band B

- Available February
- Two Double Bedrooms
- First Floor Apartment
- Furnished
- Ideal for Couples or Sharers
- Great Location of Withington
- Walking Distance to all Amenities
- Parking subject to Availability
- Council Tax Band B
- EPC Rating B



Energy Efficiency Rating		
	Current	Potential
Very energy efficient - lower running costs		
(92 plus) A		
(81-91) B	82	82
(69-80) C		
(55-68) D		
(39-54) E		
(21-38) F		
(1-20) G		
Not energy efficient - higher running costs		
England & Wales	EU Directive 2002/91/EC 	



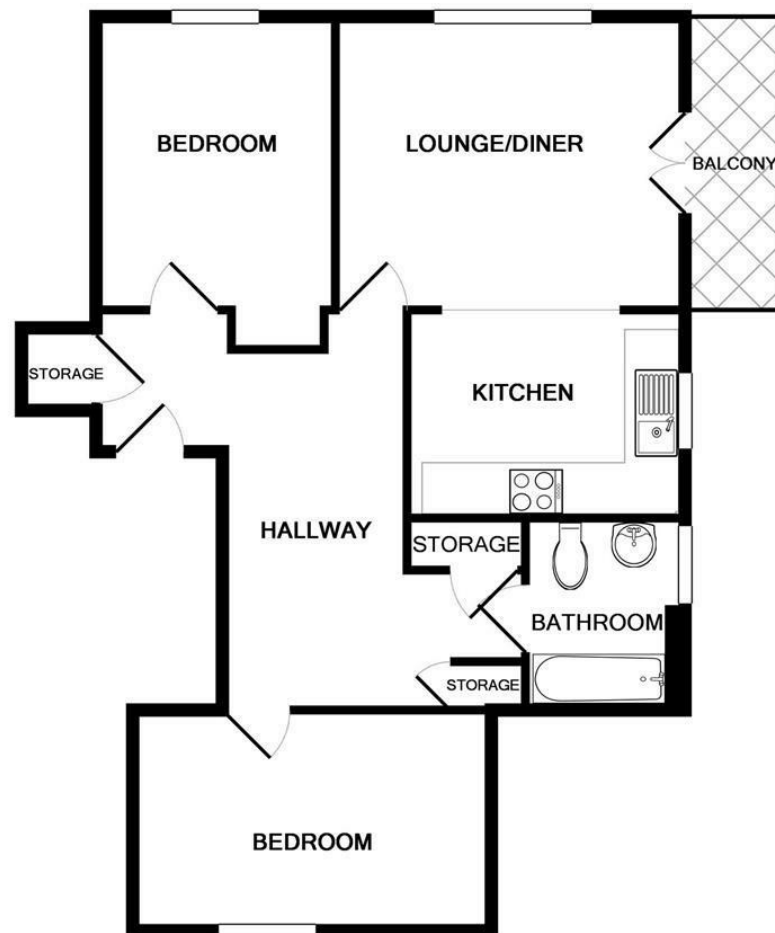

TOTAL APPROX. FLOOR AREA 614 SQ.FT. (57.1 SQ.M.)

Whilst every attempt has been made to ensure the accuracy of the floor plan contained here, measurements of doors, windows, rooms and any other items are approximate and no responsibility is taken for any error, omission, or mis-statement. This plan is for illustrative purposes only and should be used as such by any prospective purchaser. The services, systems and appliances shown have not been tested and no guarantee as to their operability or efficiency can be given
Made with Metropix ©2015



These particulars are believed to be accurate but they are not guaranteed and do not form a contract. Neither Jordan Fishwick nor the vendor or lessor accept any responsibility in respect of these particulars, which are not intended to be statements or representations of fact and any intending purchaser or lessee must satisfy himself by inspection or otherwise as to the correctness of each of the statements contained in these particulars. Any floorplans on this brochure are for illustrative purposes only and are not necessarily to scale.

Offices at: Offices at Chorlton, Didsbury, Disley, Hale, Glossop, Macclesfield, Manchester Deansgate, Manchester Whitworth Street, New Mills, Sale, Wilmslow and Withington