

Colebrook Road, Solihull



Contact us for more information 0121 777 7211





## Directions



Klarico Estate Agents are excited to introduce this exceptional 3-bedroom semi-detached home, perfectly positioned in a desirable Solihull location. Featuring a spacious and well-maintained rear garden, this property also offers ample driveway space for multiple cars. With two bathrooms and no upward chain, it's ready for immediate move-in.

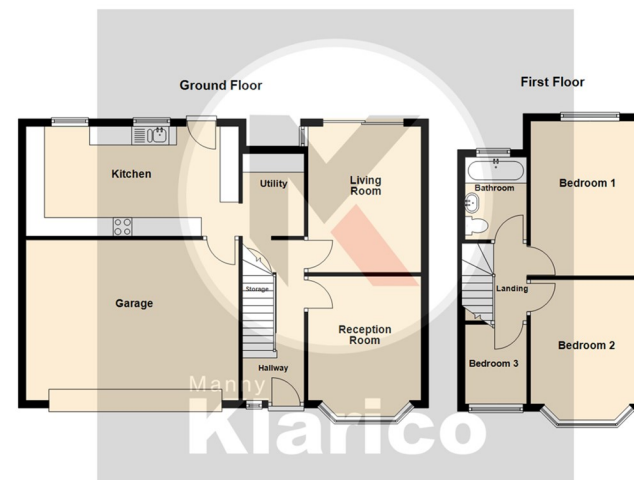

Total area: approx. 113.2 sq. metres (1218.9 sq. feet)

This plan is not to scale and is given merely as a guide to show the approximate location of one room to another. This is only used for illustration purposes and should be as such by any other party that no responsibility is taken for any error, omission or misstatement. Any appliances, fixtures, systems etc have not been tested and therefore no guarantee can be provided.  
Plan produced using PlanIt.

### Reception Room

3.34m x 3.04m (10'11" x 10'0")

### Living Room

4.13m x 3.03m (13'7" x 9'11")

### Kitchen

2.95m x 5.72m (9'8" x 18'9")

### Utility

2.22m x 1.66m (7'3" x 5'5")

### Garage

4.30m x 5.72m (14'1" x 18'9")

### Bedroom 1

4.16m x 3.11m (13'8" x 10'2")

### Bedroom 2

3.34m x 3.08m (10'11" x 10'1")

### Bedroom 3

2.14m x 1.66m (7'0" x 5'5")

### Bathroom

2.25m x 1.65m (7'5" x 5'5")

### Garden