

Greenside Road,



Contact us for more information 0121 750 0390



Directions



KLARICO Estate Agents are delighted to present this stunning 5 bedroom detached property located within a prominent part of Birmingham. Features an impressive ground floor rear extension and dormer loft conversion. An impressive family home with off-road parking for multiple vehicles.

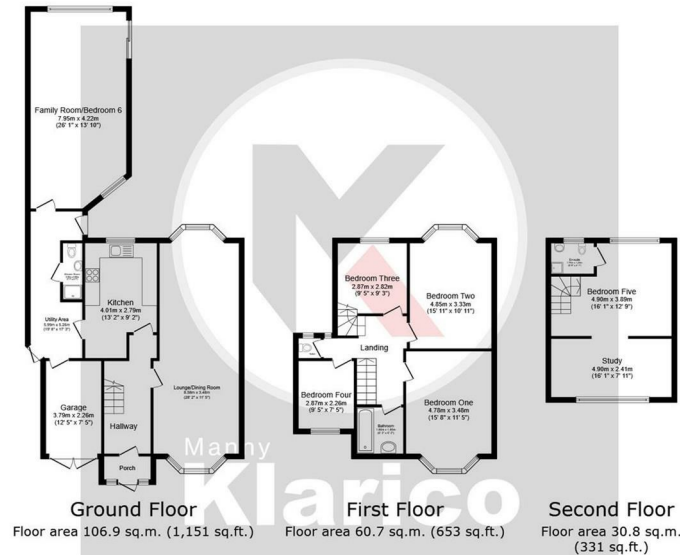

Total floor area: 198.4 sq.m. (2,135 sq.ft.)

This floor plan is for illustrative purposes only. It is not drawn to scale. Any measurements, floor areas (including any total floor area), openings and orientations are approximate. No details are guaranteed, they cannot be relied upon for any purpose and do not form any part of any agreement. No liability is taken for any error, omission or misstatement. A party must rely upon its own inspection(s).

GROUND FLOOR

Lounge/Dining Room
8.58m x 3.48m (28'1" x 11'5")

Kitchen
4.01m x 2.79m (13'1" x 9'1")

Family Room
7.95m x 4.22m (26'0" x 13'10")

Garage
3.79m x 2.26m (12'5" x 7'4")

Utility Area
5.99m x 2.26m (19'7" x 7'3")

Shower Room (Ground Floor)
3.30m x 1.83 (10'9" x 6'0")

FIRST FLOOR

Bedroom One
4.78m x 3.48m (15'8" x 11'5")

Bedroom Two
4.85m x 3.33m (15'10" x 10'11")

Bedroom Three
2.87m x 2.82m (9'4" x 9'3")

Bedroom Four
2.87m x 2.26m (9'4" x 7'4")

Bathroom
1.90m x 1.90m (6'2" x 6'2")

Toilet