



Baldslow Road, Hastings TN34 2EZ

Offers in excess of £135,000



Bright ONE BEDROOM APARTMENT set on the first floor of this attractive residence with an OUTLOOK TOWARDS ALEXANDRA PARK. This fab apartment is ideally positioned for access in to Hastings Town centre with its mainline Railway station and beach. The living space is open to the kitchen with large windows enjoying the GREEN VISTA and letting the natural light seep in. There is a GENEROUS DOUBLE BEDROOM and a fitted bathroom. You can enjoy the use of the COMMUNAL GARDENS and being sold with a LONG LEASE it's not one to be missed.

GROUND FLOOR 481.38 sq. ft.
(44.72 sq. m.)

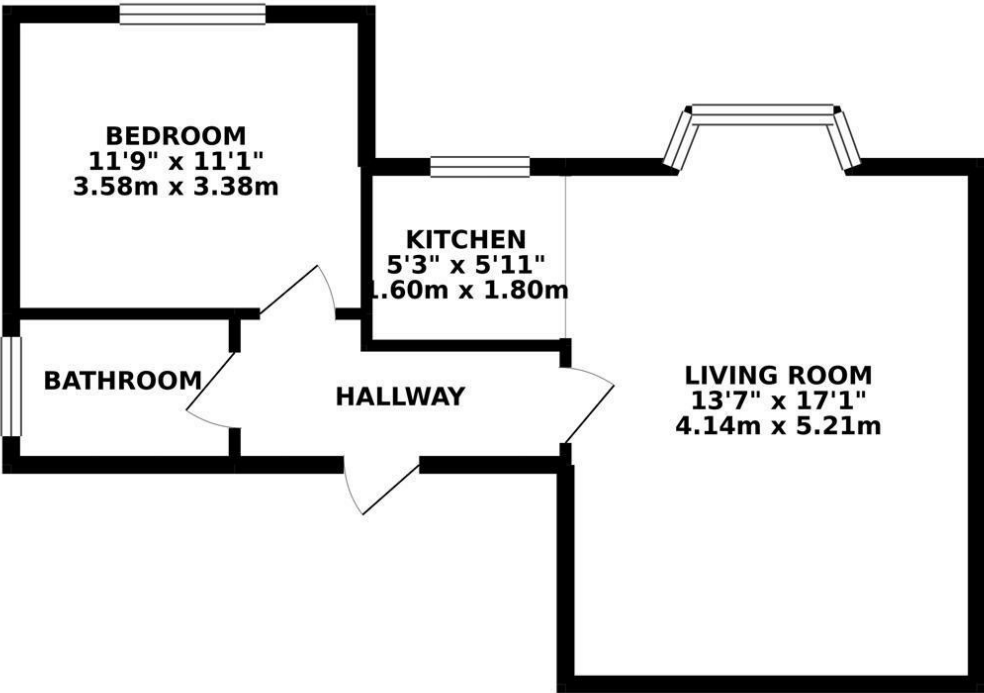

TOTAL FLOOR AREA : 481.38 sq. ft. (44.72 sq. m.) approx.
Whilst every attempt has been made to ensure the accuracy of the floorplan contained here, measurements of doors, windows, rooms and any other items are approximate and no responsibility is taken for any error, omission or mis-statement. This plan is for illustrative purposes only and should be used as such by any prospective purchaser. The services, systems and appliances shown have not been tested and no guarantee as to their operability or efficiency can be given.
Made with Metropix ©2019

