



Priory Avenue, Hastings TN34 1UG

Offers in excess of £150,000



Spacious ONE BEDROOM apartment set on the FIRST FLOOR of this period residence, it's ENVIABLY LOCATED just a short stroll from Hastings Town Centre, the beach, Alexandra Park and Linton Gardens. The accommodation here enjoys GENEROUS PROPORTIONS and is arranged as a BAY FRONTED LIVING SPACE which is open to the kitchen, separated with a breakfast bar. From the front of the property there is a BEAUTIFUL OUTLOOK TOWARDS THE SEA. The double bedroom is served by a bathroom where there is a bath with a shower over. Being sold with NO ONWARD CHAIN and enjoying a long lease this charming property would make the PERFECT FIRST TIME HOME or investment.

FIRST FLOOR
489 sq.ft. (45.4 sq.m.) approx.

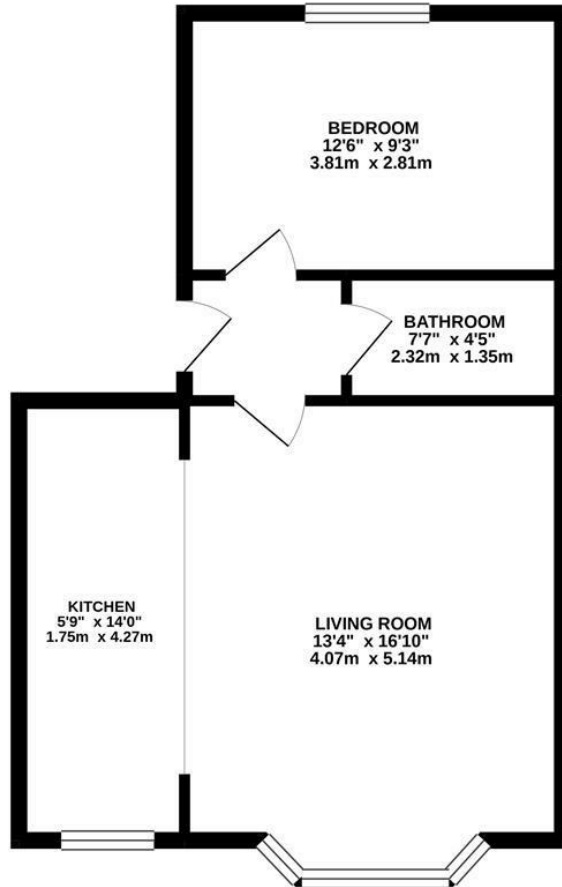

TOTAL FLOOR AREA: 489 sq.ft. (45.4 sq.m.) approx.

Whilst every attempt has been made to ensure the accuracy of the floorplan contained here, measurements of doors, windows, rooms and any other items are approximate and no responsibility is taken for any error, omission or mis-statement. This plan is for illustrative purposes only and should be used as such by any prospective purchaser. The services, systems and appliances shown have not been tested and no guarantee as to their operability or efficiency can be given.
Made with Metropix ©2021.

