



Pelham Crescent, Hastings TN34 3AF

Offers in excess of £150,000



Immaculately presented FIRST FLOOR APARTMENT found a mere stones throw from Hastings beach and Old Town, this STYLISH RESIDENCE forms part of this characterful, GRADE II listed building. The OPEN PLAN living space showcases PANORAMIC SEA VIEWS with gorgeous windows and door which frame the fantastic outlook and open on to a FULL BALCONY. The PRIVATE BALCONY comfortably fits a bistro table and chairs where you can enjoy the unrivalled views, relax with a glass of wine and watch the sun go down. With a bright DOUBLE BEDROOM, well equipped kitchen and fitted shower room we can see why this SEASIDE HAVEN is in high demand. Being sold with a SHARE OF FREEHOLD and a long lease it's not one to be missed.

GROUND FLOOR
450 sq. ft. (41.8 sq. m.) approx.

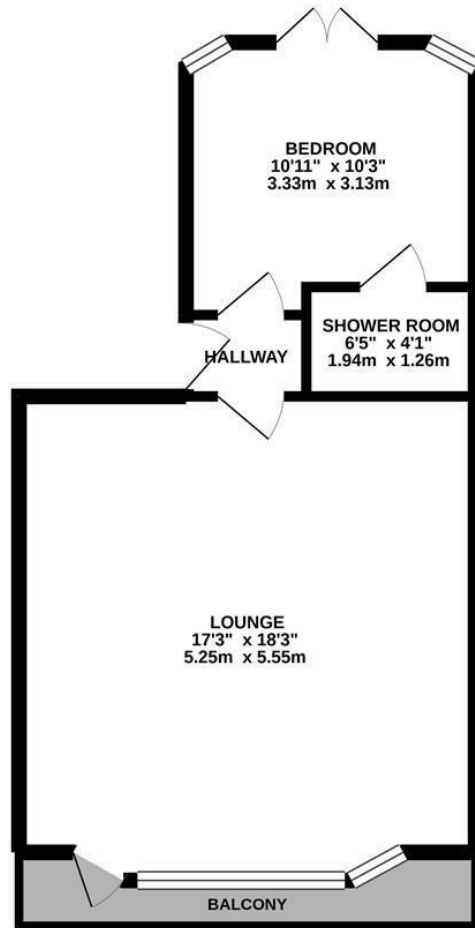

TOTAL FLOOR AREA : 450 sq. ft. (41.8 sq. m.) approx.

Whilst every attempt has been made to ensure the accuracy of the floorplan contained here, measurements of doors, windows, rooms and any other items are approximate and no responsibility is taken for any error, omission or mis-statement. This plan is for illustrative purposes only and should be used as such by any prospective purchaser. The services, systems and appliances shown have not been tested and no guarantee as to their operability or efficiency can be given.
Made with Metropix ©2020

