



Winchelsea Road, Hastings TN35 4JT

Offers in excess of £170,000



This charming three bedroom house offers huge SCOPE FOR POTENTIAL with accommodation spanning two storeys and a PRIVATE REAR GARDEN. The accommodation here is arranged as a BAY FRONTED LIVING ROOM with a front aspect, there is a separate kitchen breakfast room and a ground floor bedroom with a handy downstairs cloakroom. On the first floor there are two double bedrooms along with a family bathroom. There is a low maintenance LEVEL GARDEN at the rear. Being sold with NO ONWARD CHAIN this fantastic property would make the PERFECT FIRST TIME HOME.

GROUND FLOOR
454 sq.ft. (42.2 sq.m.) approx.

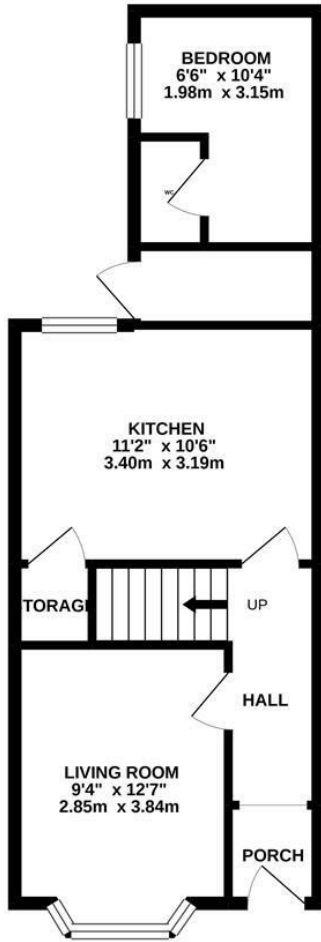

1ST FLOOR
388 sq.ft. (36.0 sq.m.) approx.



TOTAL FLOOR AREA : 842 sq.ft. (78.2 sq.m.) approx.

Whilst every attempt has been made to ensure the accuracy of the floorplan contained here, measurements of doors, windows, rooms and any other items are approximate and no responsibility is taken for any error, omission or mis-statement. This plan is for illustrative purposes only and should be used as such by any prospective purchaser. The services, systems and appliances shown have not been tested and no guarantee as to their operability or efficiency can be given.
Made with Metropix ©2021.

