



Manor Road, Hastings TN34 3LL

Offers in excess of £235,000



Well presented three bedroom FAMILY HOME arranged over THREE FLOORS which flow well with BRIGHT and SPACIOUS accommodation. This SEASIDE STYLE terrace property is CONVENIENTLY placed for local transport and shopping facilities and with a short stroll down to the TOWN CENTRE and SEAFRONT it will appeal to most buyers. There is front aspect lounge with FOCAL FIREPLACE, dining room with access to the ground floor COURTYARD area and the kitchen. The first floor features a bedroom served by a large family bathroom, separate W.C and a utility room as well as a rear hallway leading out to the BEAUTIFULLY PRESENTED and well designed ENCLOSED GARDEN with a raised decked area to relax in the sun. Sat on the second floor there are two further double bedrooms.

GROUND FLOOR 37.44 sq. m.
(403.00 sq. ft.)

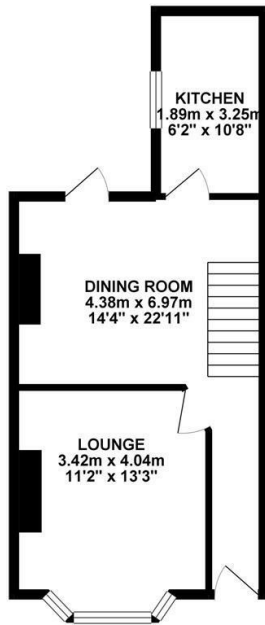

1ST FLOOR 36.02 sq. m.
(387.73 sq. ft.)

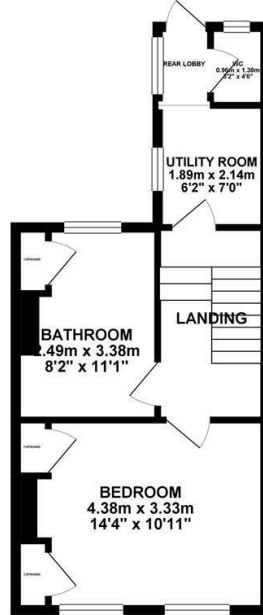

2ND FLOOR 29.83 sq. m.
(321.13 sq. ft.)

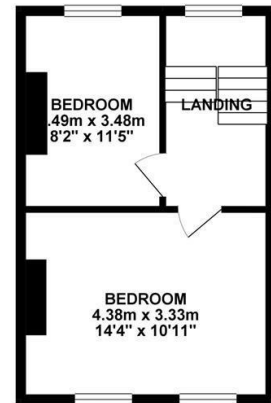

TOTAL FLOOR AREA : 103.30 sq. m. (1111.86 sq. ft.) approx.

Whilst every attempt has been made to ensure the accuracy of the floorplan contained here, measurements of doors, windows, rooms and any other items are approximate and no responsibility is taken for any error, omission or mis-statement. This plan is for illustrative purposes only and should be used as such by any prospective purchaser. The services, systems and appliances shown have not been tested and no guarantee as to their operability or efficiency can be given.

Made with Metropix ©2019

