



The Ridge, Hastings TN34 2RT

£285,000



We adore this EXCEPTIONALLY BEAUTIFUL two bedroom family home. The accommodation here has undergone EXTENSIVE RESTORATION to offer a charming living space with patio doors out to the garden, a STYLISH KITCHEN and a LUXURY BATHROOM with traditional fittings. There is also a SEPARATE DINING ROOM which enjoys a front aspect. Sat on the first floor there are TWO GENEROUS BEDROOMS. The rear garden is a particular feature measuring over 100ft in length. With a large patio area it's perfect for al-fresco dining and there is also a large, level lawn. The DETACHED STUDIO at the end of the garden creates the perfect space for those who work from home. Nestled back from the road with OFF ROAD PARKING for two vehicles it would make the perfect first time or family home. Being sold with NO ONWARD CHAIN its not to be missed.

GROUND FLOOR
568 sq.ft. (52.8 sq.m.) approx.

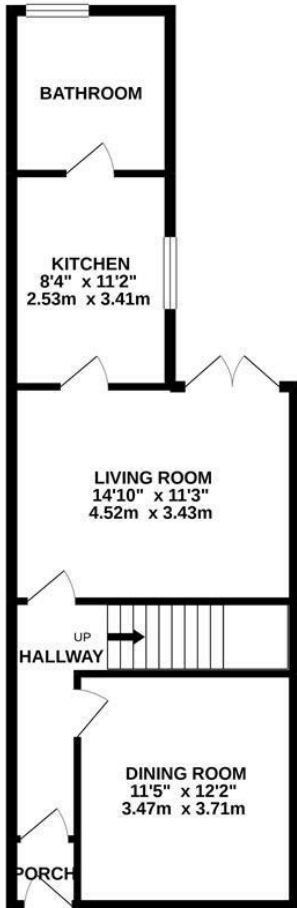

1ST FLOOR
404 sq.ft. (37.5 sq.m.) approx.

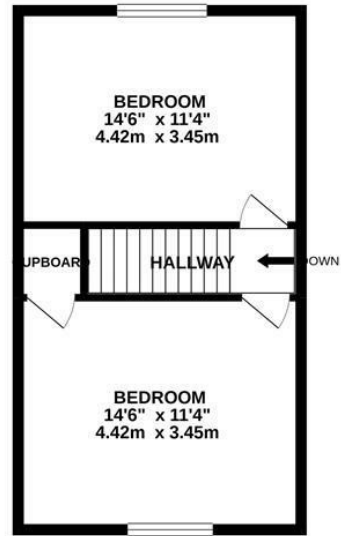

TOTAL FLOOR AREA: 972 sq.ft. (90.3 sq.m.) approx.

Whilst every attempt has been made to ensure the accuracy of the floorplan contained here, measurements of doors, windows, rooms and any other items are approximate and no responsibility is taken for any error, omission or mis-statement. This plan is for illustrative purposes only and should be used as such by any prospective purchaser. The services, systems and appliances shown have not been tested and no guarantee as to their operability or efficiency can be given.
Made with Metropix ©2020

