



Silverlands Road, St. Leonards-On-Sea TN37 7DE

Offers in excess of £260,000



Well presented and spacious three bedroom VICTORIAN HOME located in Silverhill, right around the corner from local shops, popular Schools and transport links. This charming property enjoys WELL PROPORTIONED and bright characterful accommodation arranged as a bay fronted living room with a WORKING FIREPLACE, there is a SEPARATE DINING ROOM and a generous eat in kitchen. There is also a HANDY UTILITY AREA and a SUN ROOM which leads to the rear garden and enjoys a downstairs cloakroom. Sat on the first floor are THREE DOUBLE BEDROOMS along with a family bathroom and separate cloakroom. There is a WALLED GARDEN to the rear which offers the perfect space for outdoor dining.

GROUND FLOOR  
641 sq.ft. (59.5 sq.m.) approx.

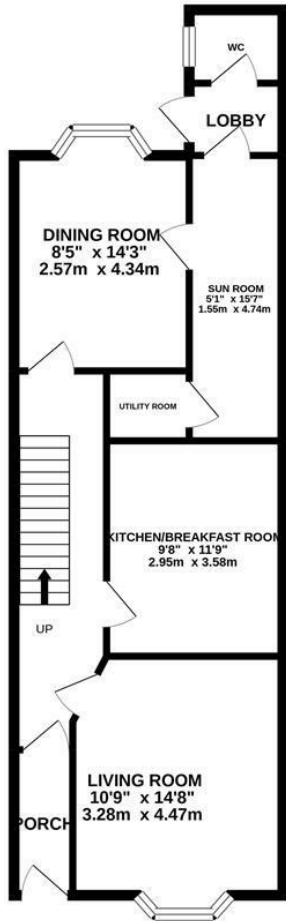

1ST FLOOR  
516 sq.ft. (48.0 sq.m.) approx.



TOTAL FLOOR AREA: 1157 sq.ft. (107.5 sq.m.) approx.

Whilst every attempt has been made to ensure the accuracy of the floorplan contained here, measurements of doors, windows, rooms and any other items are approximate and no responsibility is taken for any error, omission or mis-statement. The plan is for illustrative purposes only and should be used as such by any prospective purchaser. The services, systems and appliances shown have not been tested and no guarantee as to their operability or efficiency can be given.  
Made with Metropix ©2020

