



Victoria Avenue, Hastings TN35 5BT

Offers in excess of £215,000



This CHARMING three bedroom FAMILY HOME offers heaps of space with a gorgeous OPEN LIVING AND DINING SPACE which flows through to the kitchen at the rear. The kitchen is generously proportioned and enjoys patio doors leading out to a raised deck which overlooks the LAWNED REAR GARDEN, at the far end of the garden is a LARGE SUMMERHOUSE. Sat on the first floor there are THREE BEDROOMS with a fitted bathroom. Set on the Northern outskirts of Hastings it is ideally positioned for access to local shops, transport links and popular Schools. This property is found WELL PRESENTED THROUGHOUT and offers the perfect space for family life.

GROUND FLOOR 44.65 sq. m.  
( 480.57 sq. ft. )

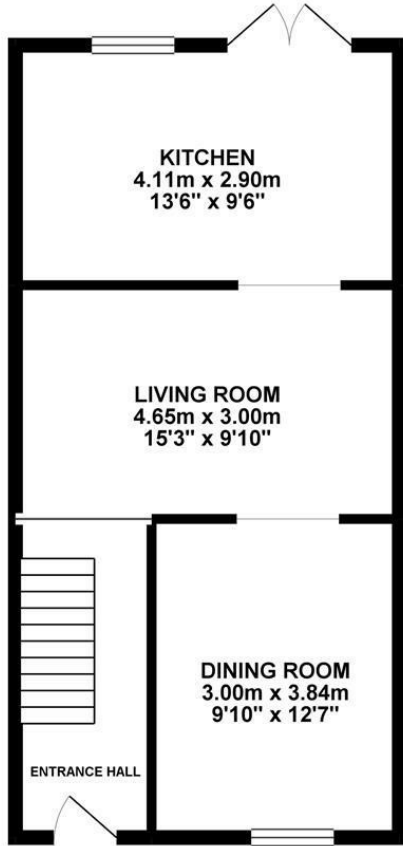

1ST FLOOR 31.12 sq. m.  
( 335.02 sq. ft. )

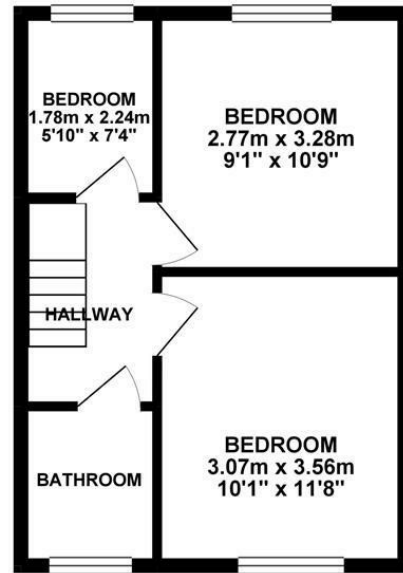

TOTAL FLOOR AREA : 75.77 sq. m. ( 815.59 sq. ft. ) approx.

Whilst every attempt has been made to ensure the accuracy of the floorplan contained here, measurements of doors, windows, rooms and any other items are approximate and no responsibility is taken for any error, omission or mis-statement. This plan is for illustrative purposes only and should be used as such by any prospective purchaser. The services, systems and appliances shown have not been tested and no guarantee as to their operability or efficiency can be given.  
Made with Metropix ©2019

