



Grosvenor Crescent, St. Leonards-On-Sea TN38 0AA

Offers in the region of £290,000



Beautiful two bedroom, first floor seafront apartment with glorious sea views across West Marina Gardens. The generous sized accommodation is arranged as the perfect seaside retreat with a large bay fronted living room, two double bedrooms and nautical styled kitchen and bathroom. There is a South facing balcony off of the living room, perfect for enjoying a glass of wine and watching the sun set. This stunning home enjoys high ceilings and character features throughout, it is being sold with the added benefit of a share of freehold and no onward chain.

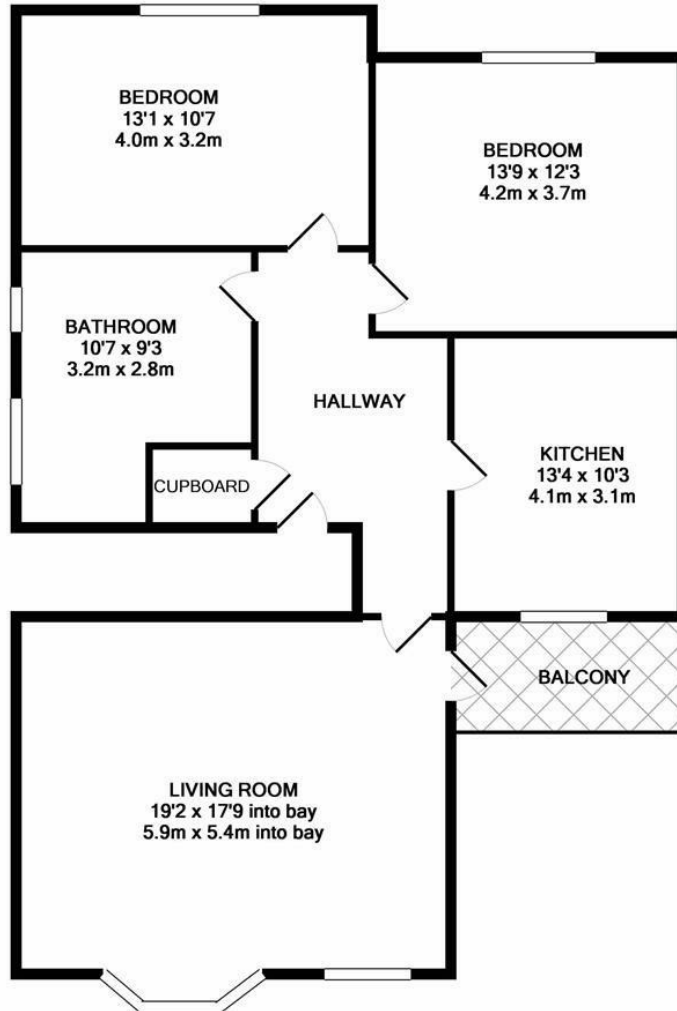

TOTAL APPROX. FLOOR AREA 1013 SQ.FT. (94.1 SQ.M.)

Whilst every attempt has been made to ensure the accuracy of the floor plan contained here, measurements of doors, windows, rooms and any other items are approximate and no responsibility is taken for any error, omission, or mis-statement. This plan is for illustrative purposes only and should be used as such by any prospective purchaser. The services, systems and appliances shown have not been tested and no guarantee as to their operability or efficiency can be given
Made with Metropix ©2018

