

Dorset Place, Hastings TN34 1LG

Offers in excess of £230,000



Two bedroom MAISONNETTE with PANORAMIC SEA VIEWS set in a prime location just moments from the beach and Hastings Town centre. Spanning the FIRST AND SECOND STOREY of this period building the accommodation here enjoys CHARACTERFUL QUIRKS throughout. The first floor enjoys a spacious DUAL ASPECT LIVING ROOM with far reaching sea views from Rock-A-Nore across to Beachy Head. The exposed brickwork in the kitchen compliments the CONTEMPORARY KITCHEN UNITS creating a homely space with plenty of room for a full dining table. There is also a NEWLY FITTED FAMILY BATHROOM on this level. Sat on the upper floor there are TWO DOUBLE BEDROOMS. Properties of this style, in this UNRIVALLED POSITION are a complete rarity and being sold with NO ONWARD CHAIN it's not to be missed.

1ST FLOOR
506 sq.ft. (47.0 sq.m.) approx.

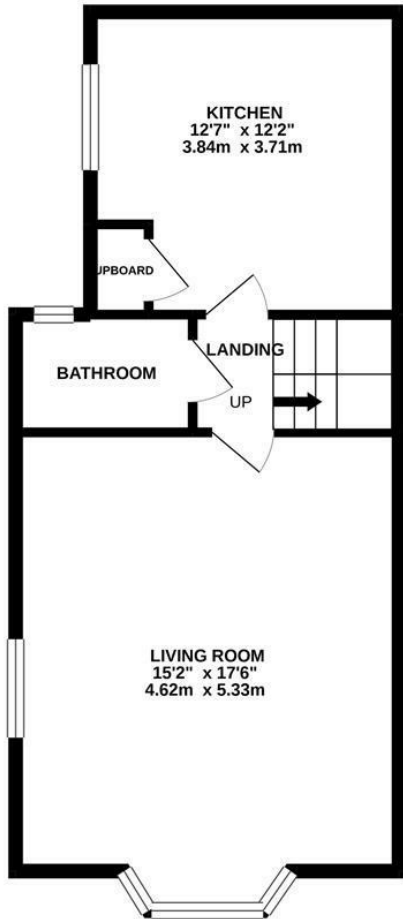

2ND FLOOR
475 sq.ft. (44.1 sq.m.) approx.

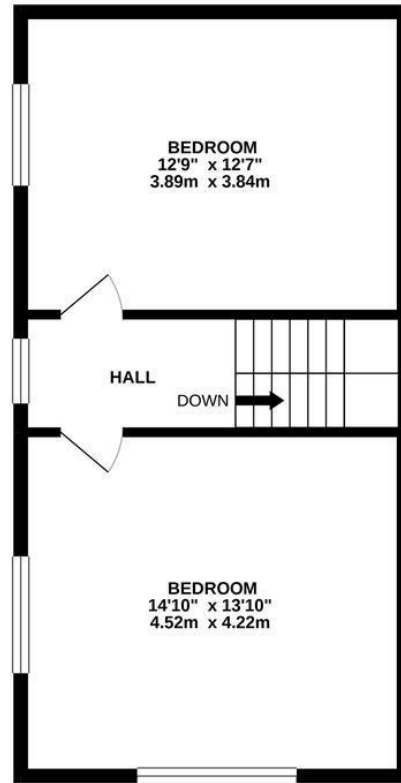

TOTAL FLOOR AREA: 981 sq.ft. (91.2 sq.m.) approx.

Whilst every attempt has been made to ensure the accuracy of the floorplan contained here, measurements of doors, windows, rooms and any other items are approximate and no responsibility is taken for any error, omission or mis-statement. This plan is for illustrative purposes only and should be used as such by any prospective purchaser. The services, systems and appliances shown have not been tested and no guarantee as to their operability or efficiency can be given.
Made with Metropix ©2020

