



## Caves Road, St. Leonards-On-Sea TN38 0BY

Offers in excess of £180,000



This TWO BEDROOM end of terraced house sits in a quiet spot just MOMENTS FROM THE BEACH. The accommodation here is BEAUTIFULLY PRESENTED with a contemporary EAT IN KITCHEN at the back of the house opening on to the enclosed rear garden. There are two bedrooms sat on the first floor with a MODERN SHOWER ROOM. This fantastic property benefits from a level, South facing rear garden and OFF ROAD PARKING to the front making it the PERFECT FIRST TIME HOME.

GROUND FLOOR 20.28 sq. m.  
(218.25 sq. ft.)

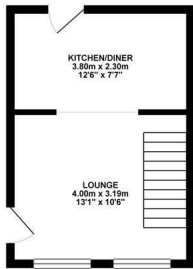

1ST FLOOR 20.28 sq. m.  
(218.25 sq. ft.)

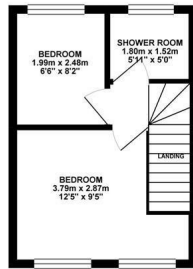

TOTAL FLOOR AREA : 40.55 sq. m. ( 436.51 sq. ft. ) approx.

Whilst every attempt has been made to ensure the accuracy of the floorplan contained here, measurements of doors, windows, rooms, and any other items are approximate and no responsibility is taken for any error, omission or mis-statement. This plan is for illustrative purposes only and should be used as such by any prospective purchaser. The services, systems and appliances shown have not been tested and no guarantee as to their operability or efficiency can be given.  
Made with Metropix ©2019

