



Robert Tressell Close, Hastings TN34 1UP

Offers in excess of £240,000



Three bedroom FAMILY HOME found in a quiet CUL-DE-SAC location. Being within walking distance to Alexandra Park and Hastings Town centre this fab house would make the PERFECT FIRST TIME HOME or suit those with an expanding family. The kitchen is GENEROUSLY PROPORTIONED and enjoys a front aspect while the living room sits at the rear of the property and is open to the SOUTH FACING CONSERVATORY with patio doors opening on to the LOW MAINTENANCE REAR GARDEN. There are THREE BEDROOMS to the first floor as well as a family bathroom. With ALLOCATED PARKING available to the front, this property is not one to be missed.

GROUND FLOOR
485 sq. ft. (45.0 sq. m.) approx.

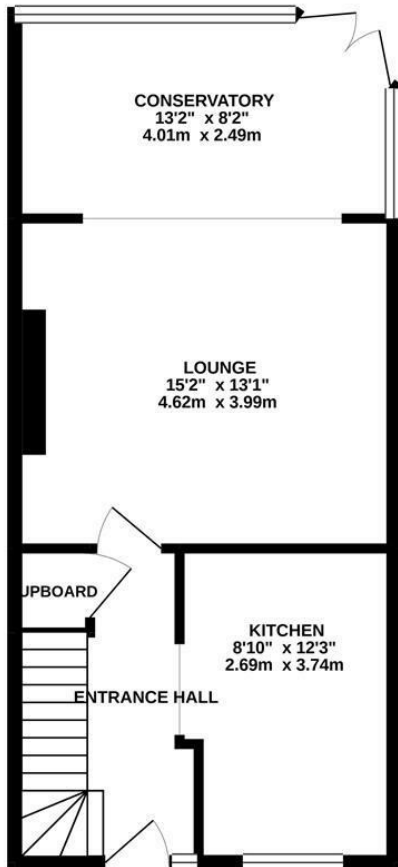

1ST FLOOR
371 sq. ft. (34.5 sq. m.) approx.

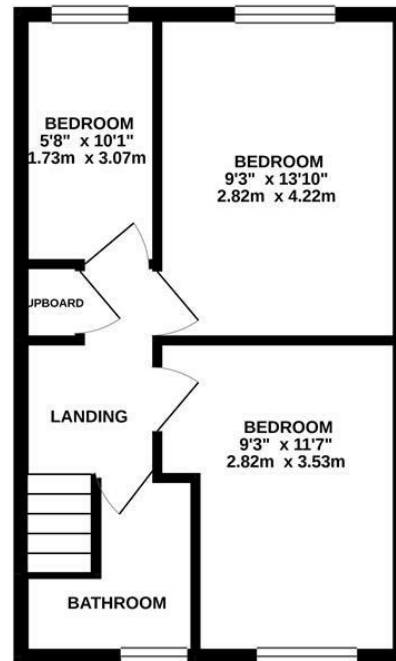

TOTAL FLOOR AREA : 856 sq. ft. (79.5 sq. m.) approx.

Whilst every attempt has been made to ensure the accuracy of the floorplan contained here, measurements of doors, windows, rooms and any other items are approximate and no responsibility is taken for any error, omission or mis-statement. This plan is for illustrative purposes only and should be used as such by any prospective purchaser. The services, systems and appliances shown have not been tested and no guarantee as to their operability or efficiency can be given.
Made with Metropix ©2019

