



North Road, St. Leonards-On-Sea TN37 6RD

Offers in excess of £290,000



Spacious four bedroom, THREE STOREY FAMILY HOME set in a central location within easy reach of Hastings Town centre, the hub of St. Leonards on sea where there is a mainline railway station and local shops at Bohemia Road. The accommodation here spans three well proportioned storeys with the lower level arranged as a BAY FRONTED LIVING SPACE with a separate EAT IN KITCHEN at the rear which enjoys access out to the LEVEL REAR GARDEN. Sat on the first floor there are two bedrooms along with a family bathroom and a further two double bedrooms are housed on the upper floor. Externally the rear garden enjoys a patio area and two handy OUTDOOR STORAGE CUOBOARDS, there is an expanse of lawn and a garden shed. Enjoying GENEROUS PROPORTIONS with character features it offers the PERFECT SPACE FOR FAMILY LIFE.

LOWER GROUND FLOOR
468 sq.ft. (43.5 sq.m.) approx.

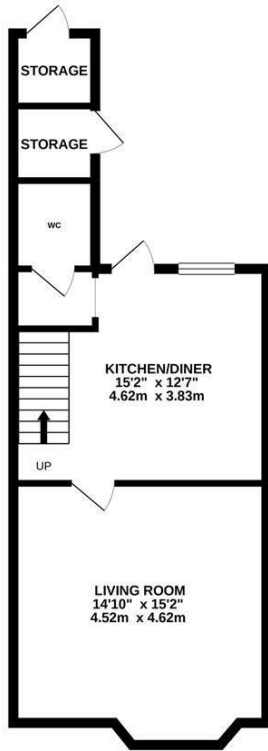

GROUND FLOOR
402 sq.ft. (37.4 sq.m.) approx.

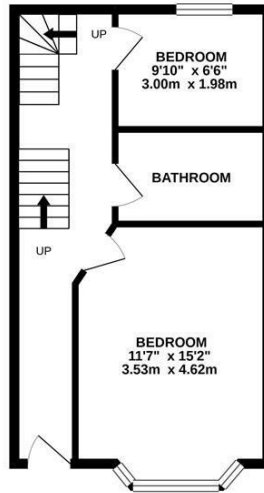

2ND FLOOR
368 sq.ft. (34.2 sq.m.) approx.

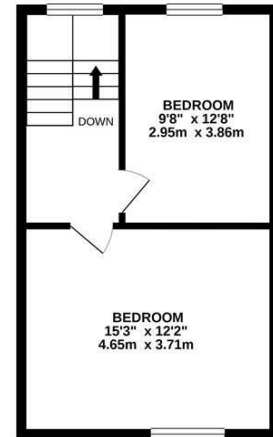

TOTAL FLOOR AREA: 1239 sq.ft. (115.1 sq.m.) approx.

Whilst every attempt has been made to ensure the accuracy of the floorplan contained here, measurements of doors, windows, rooms and any other items are approximate and no responsibility is taken for any error, omission or mis-statement. This plan is for illustrative purposes only and should be used as such by any prospective purchaser. The services, systems and appliances shown have not been tested and no guarantee as to their operability or efficiency can be given.
Made with Metropix ©2020

