



Lovat Mead, St. Leonards-On-Sea TN38 8EH

Offers in excess of £125,000



Beautiful one bedroom apartment set on the FIRST FLOOR of this purpose built block. The STYLISH ACCOMMODATION here is arranged as a front facing living room with a JULIETTE BALCONY and there is a SEPARATE KITCHEN with on trend brass fixtures. The bedroom enjoys BUILT IN WARDROBES and is served by the MODERN BATHROOM, which has been recently refitted. Being sold with a long lease and an ALLOCATED PARKING SPACE this would make an IDEAL FIRST TIME HOME or investment property.

GROUND FLOOR
365 sq.ft. (33.9 sq.m.) approx.

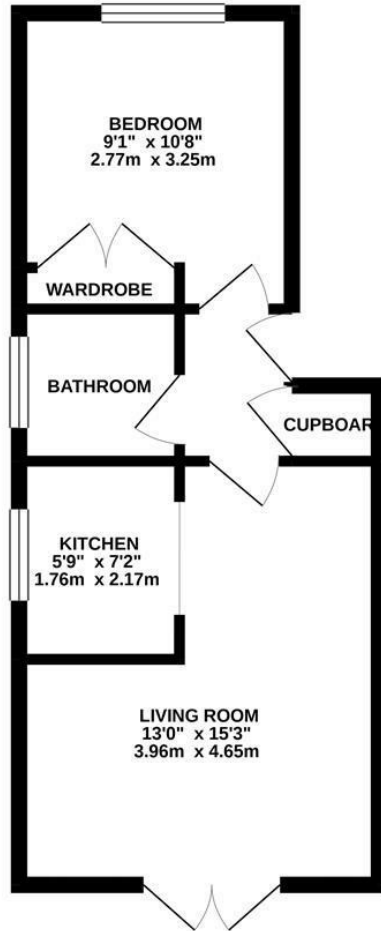

TOTAL FLOOR AREA : 365 sq.ft. (33.9 sq.m.) approx.

Whilst every attempt has been made to ensure the accuracy of the floorplan contained here, measurements of doors, windows, rooms and any other items are approximate and no responsibility is taken for any error, omission or mis-statement. This plan is for illustrative purposes only and should be used as such by any prospective purchaser. The services, systems and appliances shown have not been tested and no guarantee as to their operability or efficiency can be given.
Made with Metropix ©2020

