



Priory Road, Hastings TN34 3JE

Offers in excess of £250,000



Positioned on the WEST HILL close to local schools and amenities with the beautiful scenic walks just around the corner. This fantastic FOUR BEDROOM end of terrace home is perfect for a growing family and being well presented throughout is ready to move into and enjoy. Accommodation of entrance lobby and hallway, modern fitted kitchen, rear aspect I-shaped lounge/diner, large utility room, bedroom and a good sized conservatory to finish a spacious a ground floor. Upstairs there are a further three double bedrooms, a family bathroom and a separate W.C to beat those early morning queues. To the front of the house there is off road parking with side access to a side garden and rear garden area.

GROUND FLOOR
658 sq. ft. (61.1 sq. m.) approx.

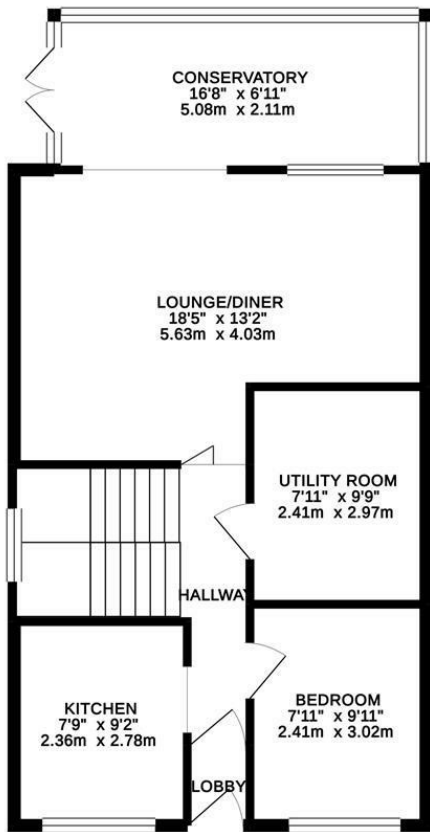

1ST FLOOR
483 sq. ft. (44.9 sq. m.) approx.

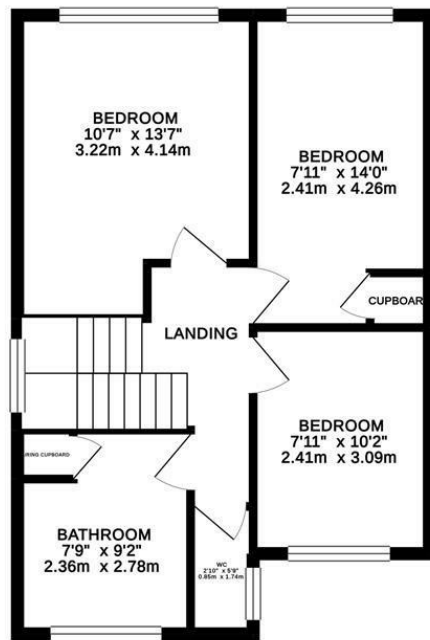

TOTAL FLOOR AREA : 1141 sq. ft. (106.0 sq. m.) approx.

Whilst every attempt has been made to ensure the accuracy of the floorplan contained here, measurements of doors, windows, rooms and any other items are approximate and no responsibility is taken for any error, omission or mis-statement. This plan is for illustrative purposes only and should be used as such by any prospective purchaser. The services, systems and appliances shown have not been tested and no guarantee as to their operability or efficiency can be given.
Made with Metropix ©2019

