



## Eversfield Place, St. Leonards-On-Sea TN37 6DD

Offers in excess of £125,000



Charming one bedroom apartment set on the FIRST FLOOR of this period residence in a prime position on St. Leonards seafront. It's IDEALLY LOCATED for the beach and access to both Hastings Town Centre and the hub of St. Leonards On sea where there is a mainline railway station. The accommodation here enjoys a MODERN, OPEN PLAN LIVING SPACE with a CONTEMPORARY FITTED KITCHEN, there is a large double bedroom measuring 18'3 x 7'1 and a bathroom with a shower and screen over the bath. Enjoying LIFT ACCESS and a LONG LEASE this fantastic property would make the PERFECT FIRST TIME HOME or seaside retreat.

FIRST FLOOR  
410 sq.ft. (38.1 sq.m.) approx.

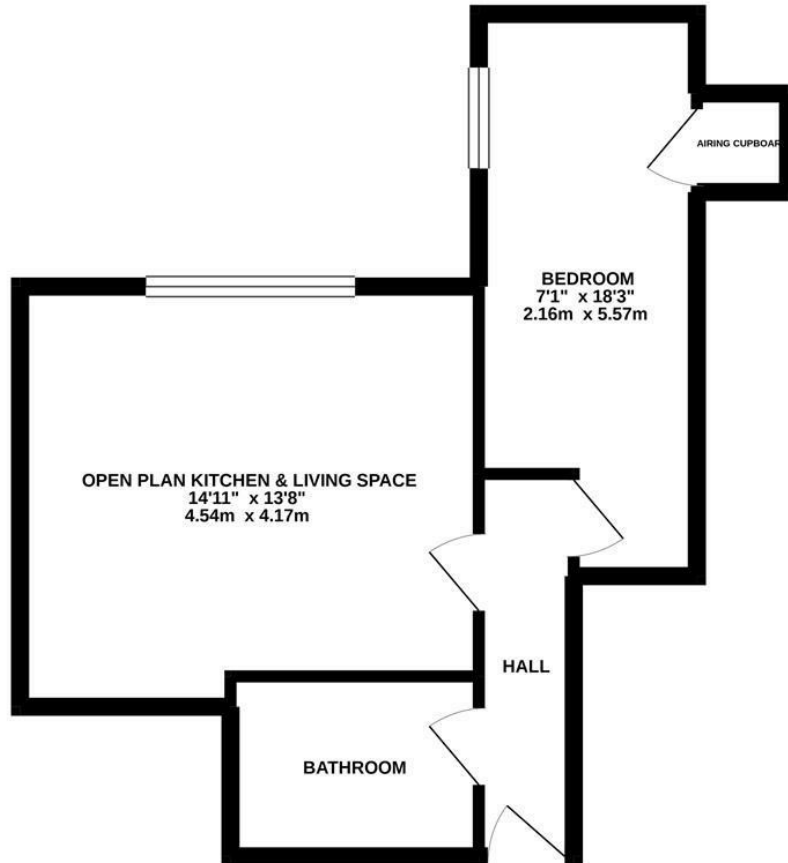

TOTAL FLOOR AREA : 410 sq.ft. (38.1 sq.m.) approx.

Whilst every attempt has been made to ensure the accuracy of the floorplan contained here, measurements of doors, windows, rooms and any other items are approximate and no responsibility is taken for any error, omission or mis-statement. This plan is for illustrative purposes only and should be used as such by any prospective purchaser. The services, systems and appliances shown have not been tested and no guarantee as to their operability or efficiency can be given.

Made with Metroplan ©2021

