



Windsor Road, Bexhill-On-Sea TN39 3PE

Offers in excess of £260,000



Fantastic home made for a FAMILY, set on the periphery of Bexhill town centre this home is ideally positioned for easy access to the range of shopping facilities, railway station and beach. Arranged over THREE FLOORS, the accommodation here offers the perfect space for those seeking a spacious family home. The ground floor enjoys an entrance lobby and bay fronted living room, this leads through to a well proportioned EAT-IN KITCHEN which acts as the hub of the home, boasts a UTILITY/cloakroom and gives access to the REAR AND SIDE GARDENS. To the first floor is the master bedroom, STUDY/MUSIC ROOM and family bathroom. Sat on the upper floor there are a further two double bedrooms with a handy separate W.C. There is a TANDEM DRIVEWAY offering off road parking to the front which is a complete rarity this close to the Town centre.

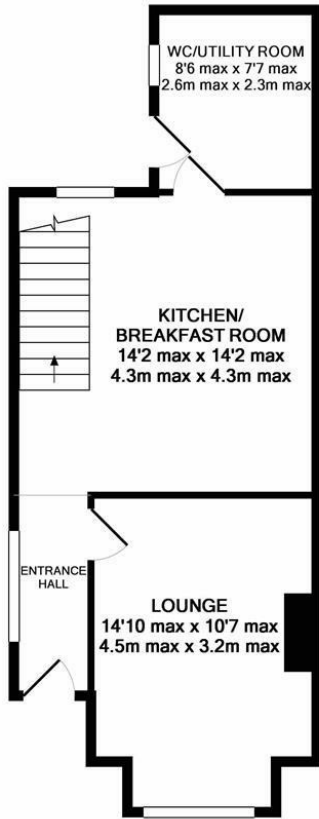

GROUND FLOOR
APPROX. FLOOR
AREA 442 SQ.FT.
(41.1 SQ.M.)

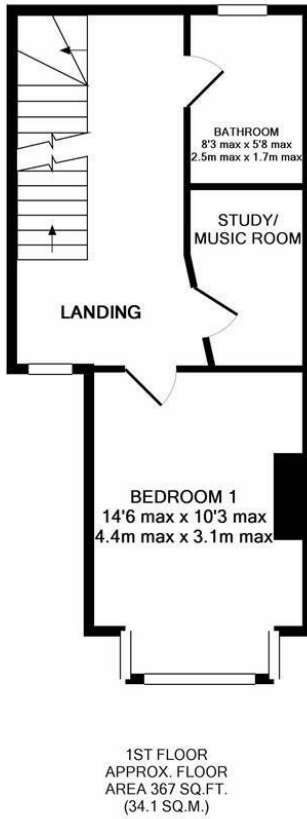

1ST FLOOR
APPROX. FLOOR
AREA 367 SQ.FT.
(34.1 SQ.M.)

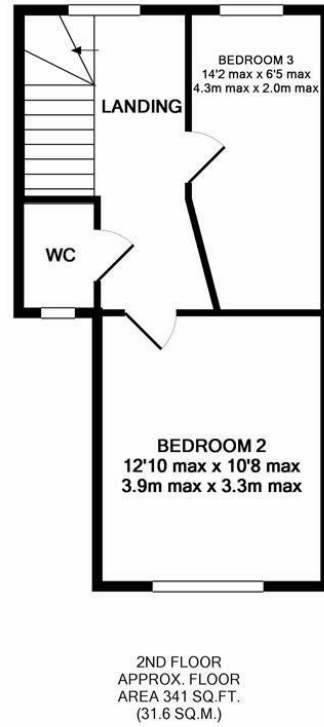

2ND FLOOR
APPROX. FLOOR
AREA 341 SQ.FT.
(31.6 SQ.M.)

TOTAL APPROX. FLOOR AREA 1150 SQ.FT. (106.8 SQ.M.)

Whilst every attempt has been made to ensure the accuracy of the floor plan contained here, measurements of doors, windows, rooms and any other items are approximate and no responsibility is taken for any error, omission, or mis-statement. This plan is for illustrative purposes only and should be used as such by any prospective purchaser. The services, systems and appliances shown have not been tested and no guarantee as to their operability or efficiency can be given
Made with Metropix ©2018

