



## Beaconsfield Road, Hastings TN34 3TW

Offers in excess of £265,000



This beautiful NEWLY BUILT two bedroom home enjoys a modern open plan feel with a CONTEMPORARY FINISH. The accommodation here spans two storeys, accessed via an entrance hall with a DOWNSTAIRS CLOAKROOM there is an open plan, dual aspect living and dining space with sliding doors leading out to the rear garden and a STYLISH KITCHEN WITH INTEGRATED APPLIANCES. There are two well proportioned double bedrooms on the first floor along with a NEWLY FITTED BATHROOM. The level rear garden is mostly laid to lawn with a large patio area which creates the PERFECT SPACE TO ENTERTAIN. To the front of the house there is a DOUBLE DRIVEWAY providing off road parking for vehicles. Presented to an exceptional standard throughout and being sold with NO ONWARD CHAIN this fantastic property would make the perfect first time home with a 10 year warranty.

GROUND FLOOR  
428 sq.ft. (39.8 sq.m.) approx.

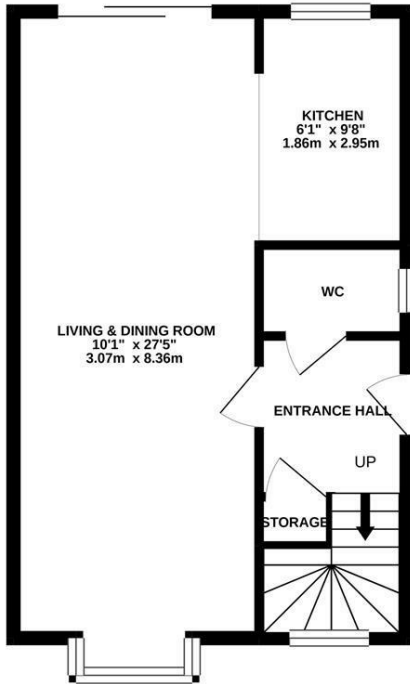

1ST FLOOR  
401 sq.ft. (37.3 sq.m.) approx.

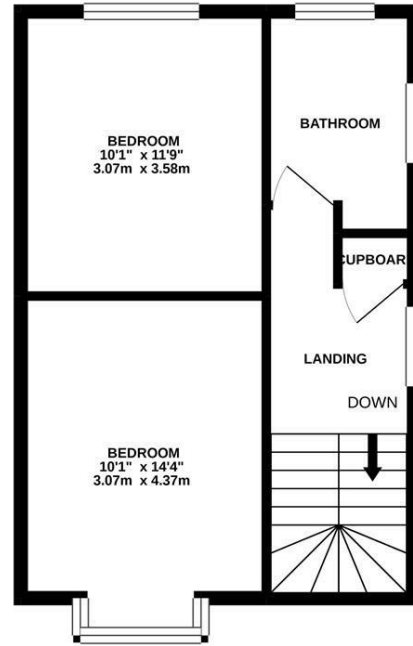

TOTAL FLOOR AREA : 829 sq.ft. (77.0 sq.m.) approx.

Whilst every attempt has been made to ensure the accuracy of the floorplan contained here, measurements of doors, windows, rooms and any other items are approximate and no responsibility is taken for any error, omission or mis-statement. This plan is for illustrative purposes only and should be used as such by any prospective purchaser. The services, systems and appliances shown have not been tested and no guarantee as to their operability or efficiency can be given.  
Made with Metropix ©2020

