

Luxury+Prestige

AURA

6 BRUDENELL AVENUE, SANDBANKS, POOLE, BH13 7NW



















TAKE A STEP INSIDE



Simply click on the thumbnail above to let one of our team give you a guided tour of the highlights.

vimeo

Floorplan

Aura, 6 Brudenell Avenue,
Sandbanks, Poole, BH13 7NW

GROSS INTERNAL AREA

House: 5,062 sq. ft / 470 m²

Overall Total: 5,062 sq. ft / 470 m²

Sizes and dimensions are approximate, actual may vary.

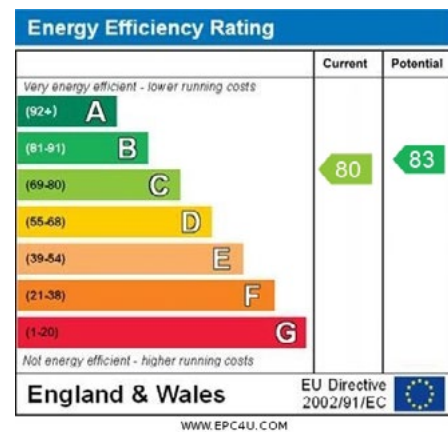
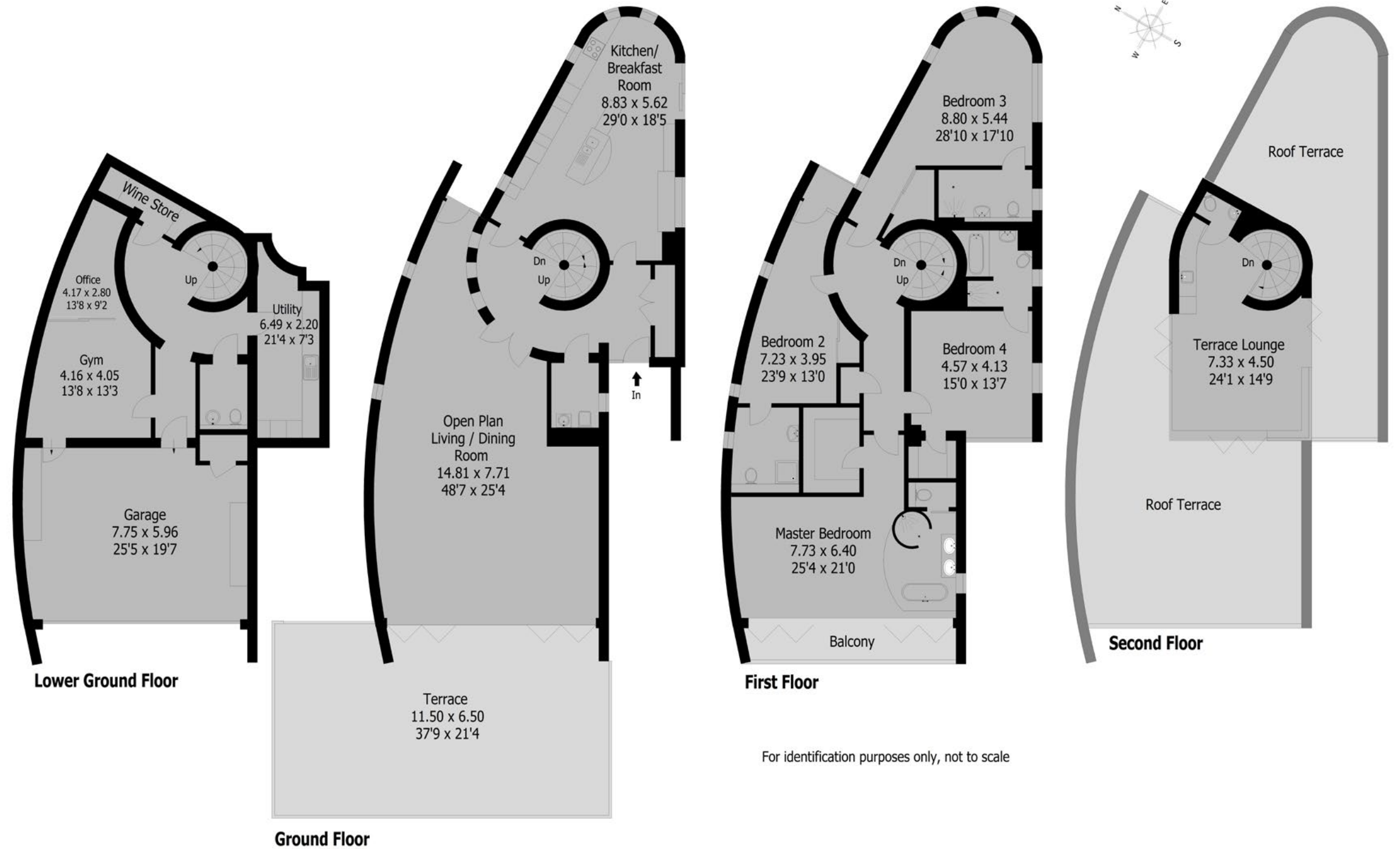

Summary

Aura is a 5,000 square feet contemporary home located in one of the most exclusive avenues on the south coast.

Properties nearby have sold for almost £7M reflecting the close proximity to Poole Harbour, which is literally at the bottom of the road, and the short walk of little more than 0.5 miles to the beaches at Sandbanks. Despite of all this, Brudenell Avenue is a quiet road that retains a strong residential feel with a mixture of mainly large and impressive luxury villas. Aura was built by one of the area's most highly reputed developers and designed by a leading architect so the combination of the two has resulted in a stunning home. There is a total of four bedrooms, each with en suite facilities and the principal suite opens onto a private sun terrace with harbour views. The house was designed for entertaining so there is a huge private sun terrace connecting to the main living area - also with harbour views - but on the top floor the pièce de résistance must surely be the terrace lounge complete with its own kitchen and a spectacular dedicated roof terrace which is perfectly positioned to take advantage of the sun as well as the beautiful harbour views on offer. Other attractions include a beautiful contemporary kitchen by Siematic, a combined gymnasium / home office, wine store and a generous double garage connecting to the generous gated driveway. If you are looking to buy a beautiful home and to elevate your lifestyle at the same time then look no further.

Details

Guide Price:	£2,995,000
Tenure:	Freehold
Lease Length:	N/A
Maintenance:	N/A
Ground Rent:	N/A* * Ground Rents can increase over time and advice should always be sought from your solicitor before exchange of contracts.
Local Authority:	BCP Council
Council Tax:	Band H 2026/2027 £4,799.98pa*** *** Amount shown is for a main home, please seek advice for additional home.
Services:	Mains gas, electricity, water and drainage

Key features

- + Circa 5,000 square feet
- + Sought after location
- + Beautiful harbour views
- + Top floor terrace lounge and roof terrace
- + Huge living area with dedicated sun terrace
- + Four bedrooms, feach with en suite facilities
- + Just over 0.5 miles from the beach
- + Oversize double garage
- + Gymnasium / home office
- + Planning permission for a lift

Our team



Steve Isaacs
Managing Director

07970 878106
steve@luxuryandprestige.com



Harriet Towing
Head of Sales

07809 908718
harriet@luxuryandprestige.com



Adrianna Ciereszko
Lead Photographer

07944 986977
adrianna@luxuryandprestige.com



Thomas Powner
Residential Sales

07437 491094
tom@luxuryandprestige.com



Valentina Morana
Residential Sales

07366 799790
valentina@luxuryandprestige.com



Jane Honour
Administrator

01202 007373
jane@luxuryandprestige.com

Get in touch

In person:	28A Haven Road Canford Cliffs Poole BH13 7LP
By phone:	01202 007373
By email:	info@luxuryandprestige.com
Online:	luxuryandprestige.com
Facebook:	facebook.com/luxuryandprestige
Instagram:	@luxuryprestigerealty
Property ref:	0996
Published:	June 2026



Important notice

Luxury and Prestige Realty Ltd, its clients and any joint agents give notice that 1: They are not authorised to make or give any representations or warranties in relation to the property either here or elsewhere, either on their own behalf or on behalf of their client otherwise. They assume no responsibility for any statement that may be made in these particulars. These particulars do not form part of any offer or contract and must not be relied upon as statements or representations of fact. 2: Any areas, measurements or distances are approximate. The text, photographs and plans are for guidance only and are not necessarily comprehensive. It should not be assumed that the property has all necessary planning, building regulation or other consents and Luxury and Prestige have not tested any services, equipment or facilities. Purchasers must satisfy themselves by inspection or otherwise.

Luxury+Prestige