

Whilst every attempt has been made to ensure the accuracy of the floor plan contained here, measurements of doors, windows, rooms and any other items are approximate and no responsibility is taken for any omission, or mis-statement. This plan is for illustrative purposes only and should be used as such by any prospective purchaser. The services, systems and appliances shown have not been tested and no guarantee as to their operability or efficiency can be given
 Made with Metropix ©2015

TOTAL APPROX. FLOOR AREA 576 SQ.FT. (53.5 SQ.M.)

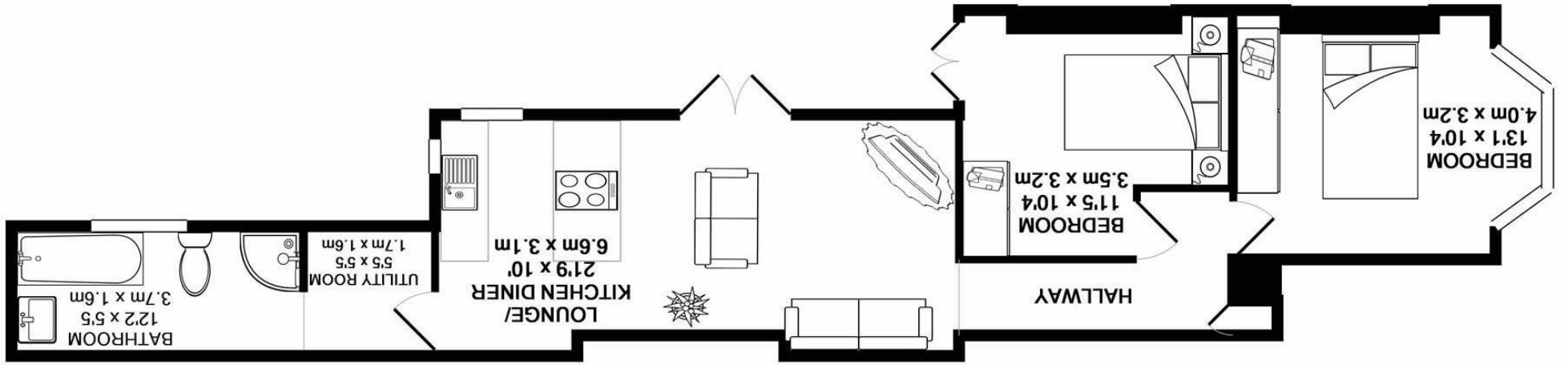



Ground Floor Flat Westcroft Road

, SM5 2TG

£1,250 Per Calendar Month

A beautifully presented two double bedroom Victorian ground floor maisonette with its own garden area. Two good size double bedrooms, open plan kitchen/diner/living room, a spacious fully tiled modern bathroom with separate shower and utility area. Situated on a quiet no through road in the heart of Carshalton village within a two minute walk to the High Street, the Westcroft Leisure centre and just a ten minute walk to Carshalton BR. Available end September 2019. No pets.

- A beautiful two Bedroom Maisonette
- Situated close to Carshalton High Street and BR Station
- Ground Floor with access to own garden
- Open plan kitchen/diner/living room
- A spacious fully tiled modern bathroom
- Available End of September 2019
- No Pets

