

Whilst every attempt has been made to ensure the accuracy of the floor plan contained here, measurements of doors, windows, rooms and any other items are approximate and no responsibility is taken for any error, omission, or mis-statement. This plan is for illustrative purposes only and should be used as such by any prospective purchaser. The services, systems and appliances shown have not been tested and no guarantee as to their operability or efficiency can be given

Made with Metropix ©2021

TOTAL APPROX. FLOOR AREA 456 SQ.FT. (42.4 SQ.M.)

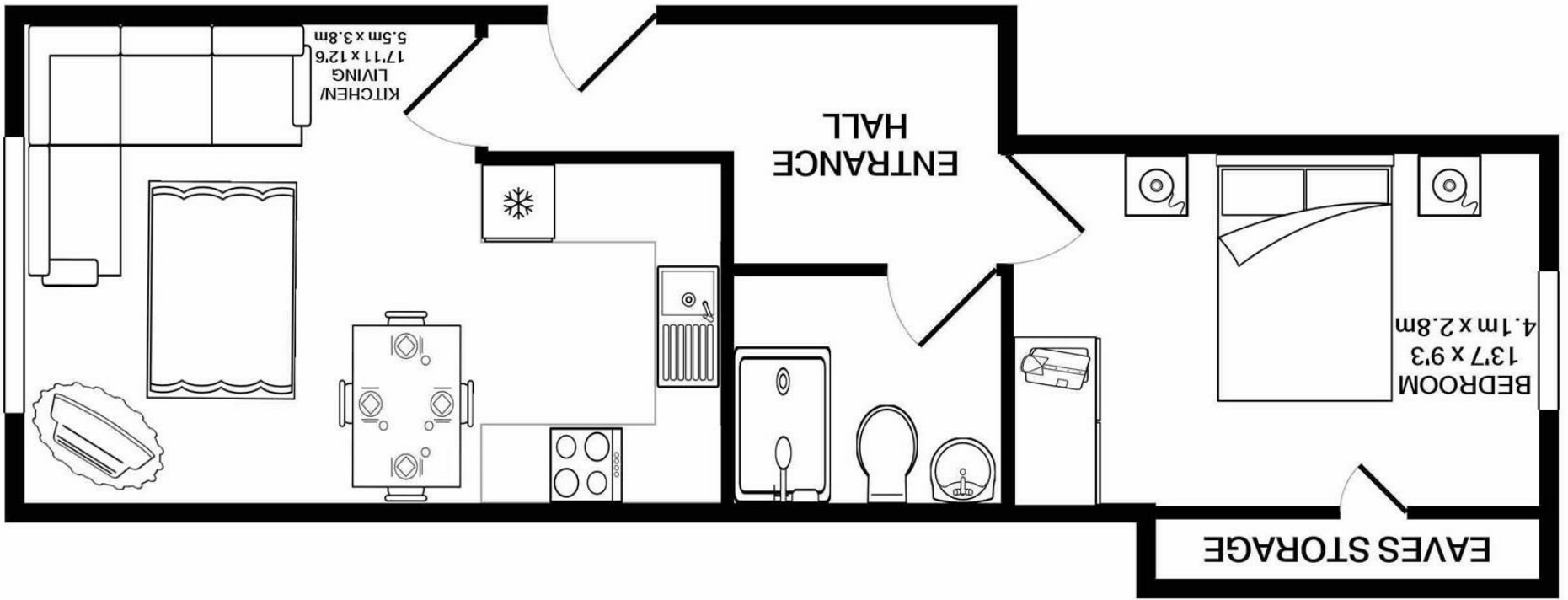

SILVERMAN
BLACK
 PROPERTY SPECIALISTS





Flat 4 53 Park Hill

Carshalton, SM5 3BE

£1,300 Per Calendar Month

Silverman Black are delighted to offer to the rental market A Luxury One Bedroom Apartment - Available April 2026. Located only yards away from Carshalton Beeches BR station (approx 2 mins walk). This beautifully decorated One bedroom apartment on the first floor of a substantial detached Victorian residence offers an amazing location in a prime residential area. The apartment features a well-proportioned and airy Living Room which incorporates a luxury integrated kitchen suite, a generously proportioned Double Bedroom and a tiled white Bathroom. Externally, there will be one allocated parking space Viewing is highly recommended . No pets.

- Available Mid April 2026
- Luxury One Bedroom First Floor Apartment
- The apartment features a well-proportioned and airy Living Room which incorporates a luxury integrated kitchen suite
- A generously proportioned Double Bedroom and a tiled white Bathroom.
- Parking on the Development, Council Tax Band C
- No Pets
- Non Smokers
- Viewing Highly Recommended

