

What every attempt has been made to ensure the accuracy of the floorplan contained here. Measurements of rooms and any other areas are approximate and no responsibility is taken for any errors, omissions or misstatements. This plan is for illustrative purposes only and should be used as such by any prospective purchaser. The services, systems and appliances have not been tested and no guarantee as to their operation or efficiency can be given.
 Plans with Misurex 02022
 TOTAL FLOOR AREA : 544 sq.ft. (50.5 sq.m.) approx.

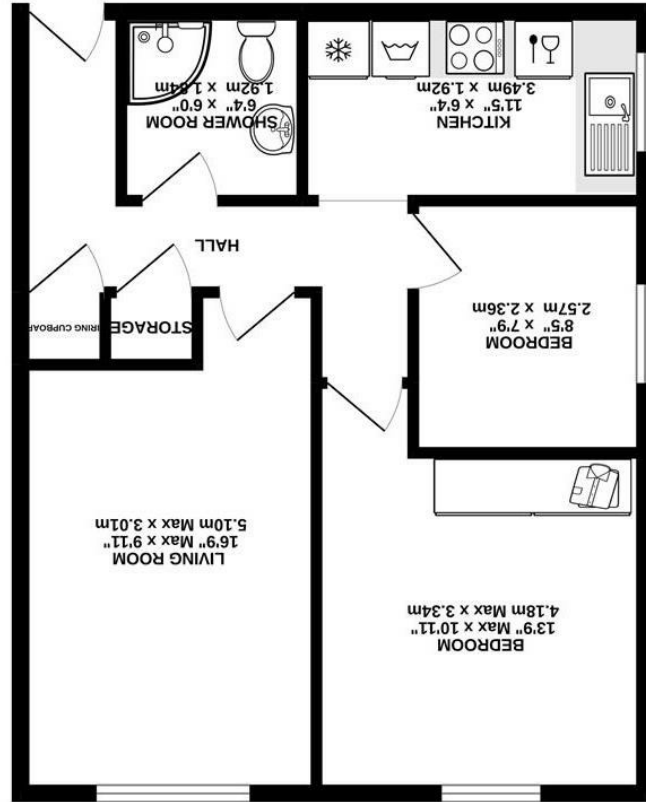

SILVERMAN
BLACK
 PROPERTY SPECIALISTS

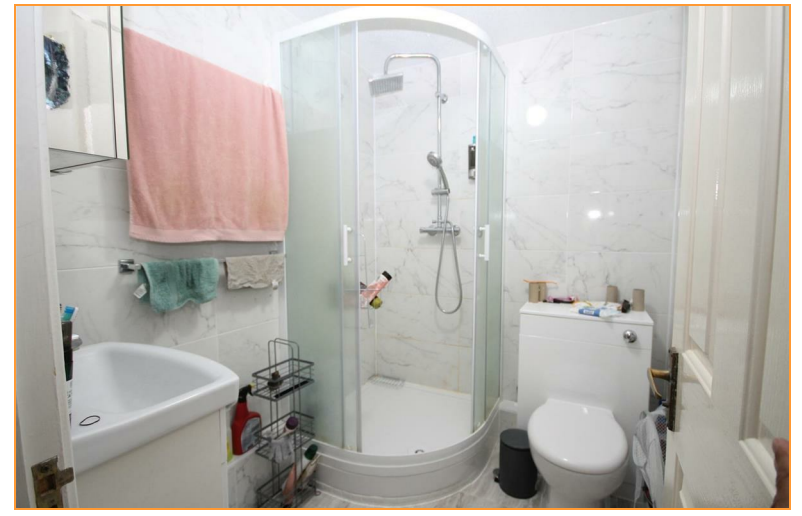



7 Hatfield Close

Sutton, SM2 5BH

£1,700 Per Calendar Month

Available Beginning April 2025 - Unfurnished. Silverman Black is delighted to offer this two bedroom first floor apartment located in a quiet private development, close to Sutton BR Station and Sutton Town Centre. The flat affords spacious and well-appointed accommodation, comprising a generous living room, a well-equipped kitchen with a fridge, washing machine and dishwasher, two bedrooms and a bathroom with shower enclosure. In addition the property benefits from double glazing and electric heating. There is also allocated parking and a spacious hallway with a large double cupboard which provides good storage facilities. No pets. Viewing is highly recommended.

- Available Beginning April 2025
- Unfurnished Two bedroom first floor flat
- Spacious lounge/reception room and two good sized bedrooms
- Allocated parking
- Close to Sutton BR Mainline Station
- EPC Band B
- Countail tax Band D
- No pets
- Viewing highly recommended

