

Whilst every attempt has been made to ensure the accuracy of the floor plan contained here, measurements of doors, windows, rooms and any other items are approximate and no responsibility is taken for any omission, or mis-statement. This plan is for illustrative purposes only and should be used as such by any prospective purchaser. The services, systems and appliances shown have not been tested and no guarantee as to their operability or efficiency can be given

Made with Metropix ©2017

TOTAL APPROX. FLOOR AREA 546 SQ.FT. (50.7 SQ.M.)

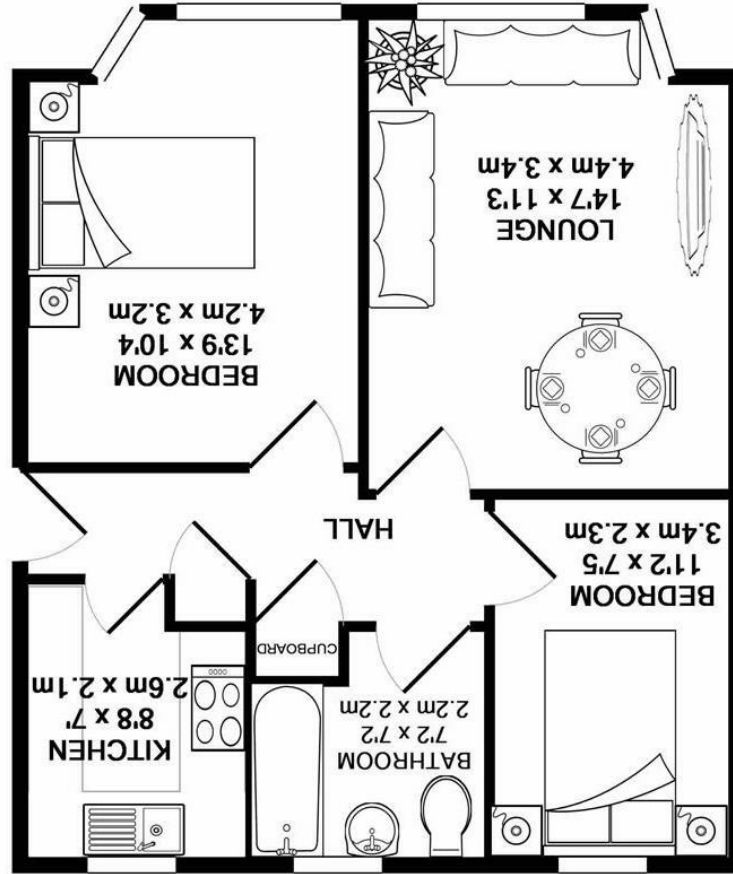

SILVERMAN
BLACK
 PROPERTY SPECIALISTS





2 Stanley Court Stanley Park Road

CARSHALTON, SM5 3JF

£1,350 Per Calendar Month

Available Immediately

Silverman Black is delighted to offer this spacious and well equipped two bedroom first (top) floor maisonette located within walking distance of Carshalton Village and Carshalton Beeches BR Stn. Benefitting from a lovely Kitchen and Bathroom, the apartment affords two good size Double Bedrooms and a generous Living Room, with further advantages including communal garden shared with flat below. Full Double Glazing, Gas/Radiator Central Heating. Early viewing is highly recommended. No Pets or Smokers.

- Available Immediately
- A two bedroom apartment near Stanley park Junior and Secondary School
- First Floor maisonette, double glazed
- Walking distance to Wallington Town Centre & BR station
- Well equipped kitchen
- No pets, no smokers
- Viewing highly recommended
- EPC D Rating
- Council Tax Band C

