



www.kings-group.net

488 Bethnal Green Road

London E2 0EA

Tel: 0207 613 2121

Prestons Road, London, E14 9EL



£1,700 Per Month

****Modern One-Bedroom Apartment near Canary Wharf****

Situated on the 12th floor of the highly sought-after ****Wharfside Point**** development, this contemporary one-bedroom apartment offers stylish urban living in a prime location.

The property benefits from a ****24-hour concierge service**** and access to a ****communal rooftop terrace**** on the same floor, providing breathtaking panoramic views of London's skyline.

Conveniently located adjacent to ****Blackwall DLR station****, residents enjoy seamless connectivity to ****Canary Wharf**** and beyond.

****Enquire today to secure your viewing and avoid disappointment.****



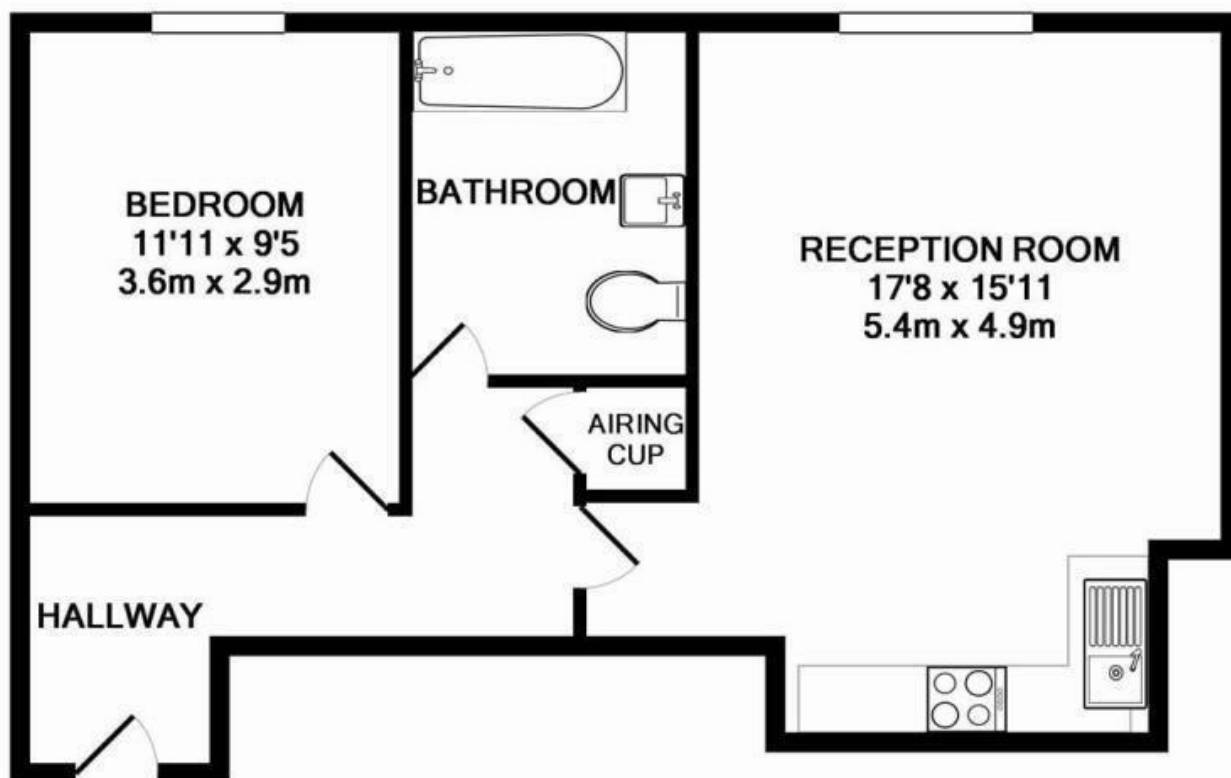

TOTAL APPROX. FLOOR AREA 487 SQ.FT. (45.2 SQ.M.)

Whilst every attempt has been made to ensure the accuracy of the floor plan contained here, measurements of doors, windows, rooms and any other items are approximate and no responsibility is taken for any error, omission, or mis-statement. This plan is for illustrative purposes only and should be used as such by any prospective purchaser. The services, systems and appliances shown have not been tested and no guarantee as to their operability or efficiency can be given

Made with Metropix ©2015



Energy Efficiency Rating		Current	Potential
Very energy efficient - lower running costs			
(92 plus) A			
(81-91) B			
(69-80) C			
(55-68) D			
(39-54) E			
(21-38) F			
(1-20) G			
Not energy efficient - higher running costs			
England & Wales		67	68
		EU Directive 2002/91/EC	

Environmental Impact (CO ₂) Rating		Current	Potential
Very environmentally friendly - lower CO ₂ emissions			
(92 plus) A			
(81-91) B			
(69-80) C			
(55-68) D			
(39-54) E			
(21-38) F			
(1-20) G			
Not environmentally friendly - higher CO ₂ emissions			
England & Wales		76	77
		EU Directive 2002/91/EC	



Associated Offices in London, Essex and Hertfordshire
Kings Head Office Tudor Lodge, Burton Lane, Goffs Oak, Hertfordshire EN7 6SY Tel: 01707-872000

