

Harrier Way, London, E6 5YP

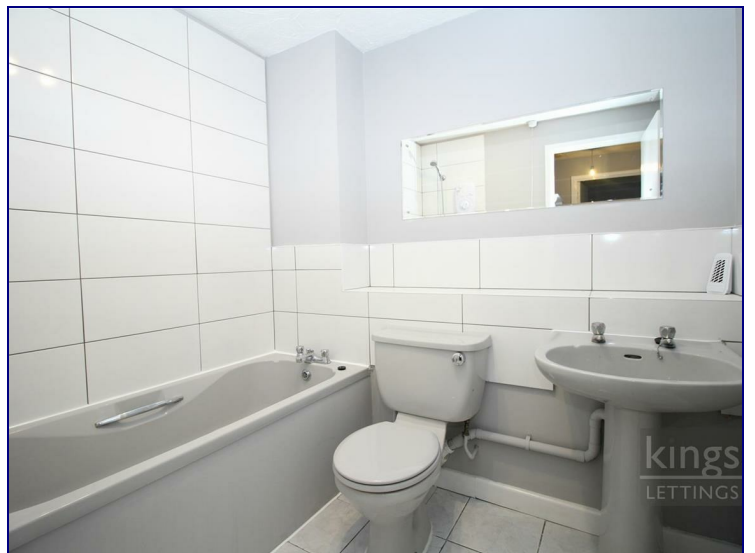

£1,450 Per Month

This larger than average one bedroom modern apartment is available for rent from 17/01, comprises of one double bedroom, fully fitted open plan kitchen, reception and large modern bathroom.

The property is conveniently located on the 3rd floor of the purpose-built block in residential district in Beckton, with close proximity to shops such Liddle, Asda, Tesco and Sainsbury's as well as Gallions Reach shopping park. The property is located only 5 mins walking distance from Beckton DLR station taking you to Canary Wharf within 20 mins and Tower Gateway/Bank.

Please contact us now to book your viewing;



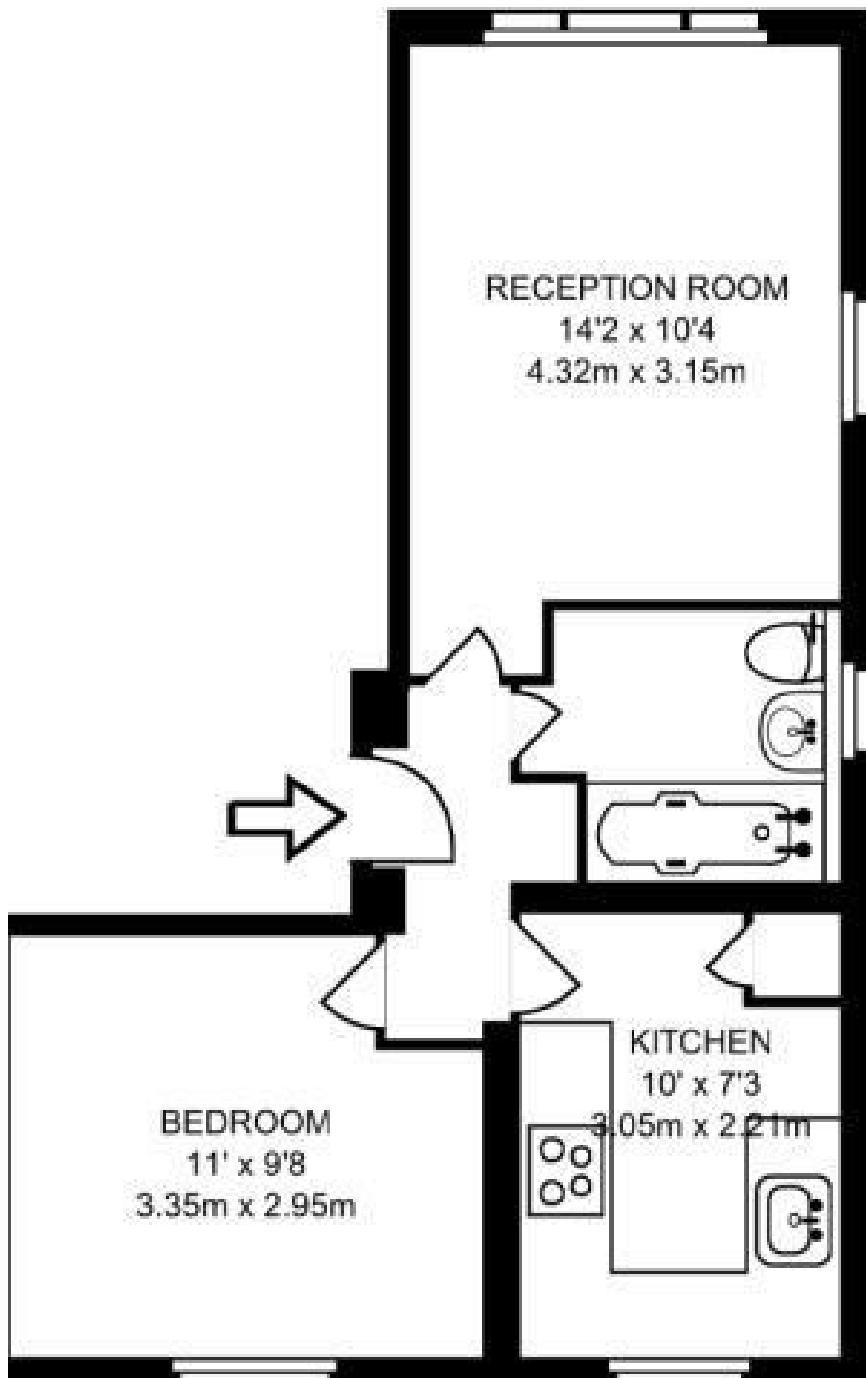

Energy Efficiency Rating		
	Current	Potential
Very energy efficient - lower running costs		
(92 plus) A		
(81-91) B		
(69-80) C		
(55-68) D		
(39-54) E		
(21-38) F		
(1-20) G		
Not energy efficient - higher running costs		
England & Wales	69	79
EU Directive 2002/91/EC		

Environmental Impact (CO ₂) Rating		
	Current	Potential
Very environmentally friendly - lower CO ₂ emissions		
(92 plus) A		
(81-91) B		
(69-80) C		
(55-68) D		
(39-54) E		
(21-38) F		
(1-20) G		
Not environmentally friendly - higher CO ₂ emissions		
England & Wales		
EU Directive 2002/91/EC		

