



**16 Deauville Close,
London**

£275,000 Leasehold



16 Deauville Close, London

326 Mare Street, Hackney, London, E8
1HA

0208 510 0808
www.kings-group.net

- One Bedroom Studio
- Fourth Floor
- Immaculate Condition Throughout
- Private Balcony
- Open Plan Living/Kitchen
- Lots of Natural Light
- Lease : 140 Years
- Excellent Location
- 0.7 Miles to Canning Town Station
- EPC Rating : B

Don't miss this opportunity to secure a fantastic property in one of East London's most desirable locations.

Council Tax Band B
Lease - 140 Years Remaining
Service Charge - £1,655.66 Per Annum
Construction Type - Standard (Brick)
Flood Risk - Rivers & Seas: Very Low, Surface Water:
Very low

Kings Group are delighted to present this modern studio apartment, ideal for first-time buyers or investors alike.

This well-presented property offers a bright and spacious open-plan living area, complete with a sleek fitted kitchen and contemporary finishes throughout. The large windows provide plenty of natural light, creating an airy and welcoming atmosphere. A stylish bathroom and ample storage space add to the appeal of this well-designed home.

The property also comes with the option to purchase a secure allocated parking space, offered separately at an additional cost. This space is to be sold to the same buyer as the apartment, providing added convenience and value in this prime location.

Situated in a sought-after riverside development, residents benefit from secure entry, lift access, and excellent transport links, including nearby DLR and bus services, making commuting into the City or Canary Wharf convenient and efficient.

FOURTH FLOOR
38.0 sq.m. (409 sq.ft.) approx.

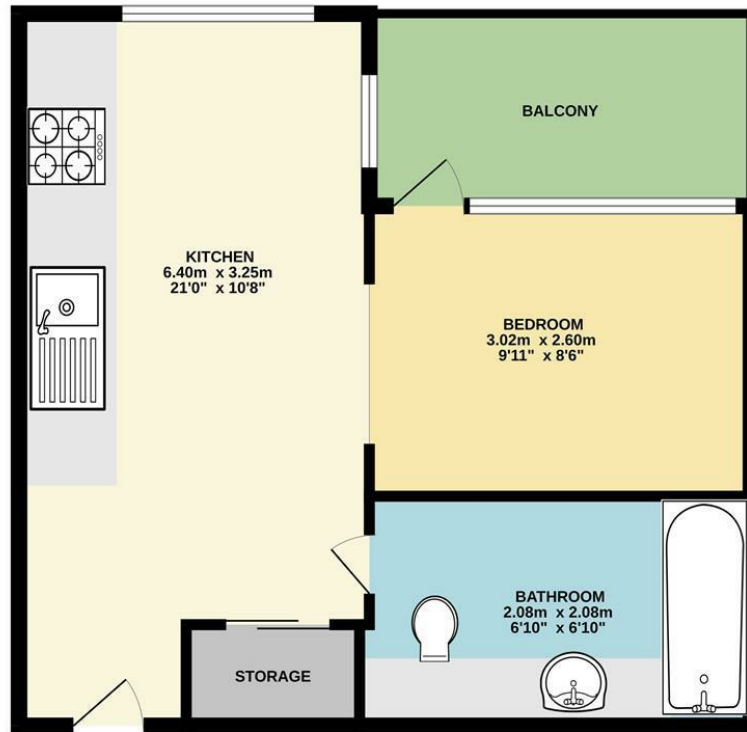

TOTAL FLOOR AREA : 38.0 sq.m. (409 sq.ft.) approx.
Whilst every attempt has been made to ensure the accuracy of the floorplan contained here, measurements of doors, windows, rooms and any other items are approximate and no responsibility is taken for any error, omission or mis-statement. This plan is for illustrative purposes only and should be used as such by any prospective purchaser. The services, systems and appliances shown have not been tested and no guarantee as to their operability or efficiency can be given.
Made with Metropix ©2025



THE PROPERTY MISDESCRIPTIONS ACT 1991. The agent has not tested any apparatus, equipment, fixtures or services and so cannot verify that they are in working order, or fit for the purpose. References to the Tenure of a property are based on information supplied by the vendor. The agent has not had sight of the Title documents. A buyer is advised to obtain verification from their Solicitor or Surveyor



326 Mare Street, Hackney, London, E8
1HA

0208 510 0808
www.kings-group.net



Zoopla.co.uk



rightmove.co.uk
The UK's number one property website

