



## Garden Flat, 381 Crookesmoor Road, Crookesmoor, Sheffield, S10 1BD

Rent: £720.00 pcm – excludes utilities & council tax

Rent Schedule: Monthly in advance

Security Deposit: Total £720.00

Bills Package: Unihomes package available for gas, electricity, water, internet & TV licence (optional)

Council Tax: Band A - not applicable for full-time students

EPC Rating: D

Tenancy Dates: 2nd September 2026 – 31st August 2027

- Garden Flat
- On Street Permit Parking
- Double Bedroom
- Large Kitchen Diner
- Bathroom with shower over bath
- Patio Space
- Deposit – One Months Rent
- Available - 2nd September 2026 - 31st August 2027
- Rent - £720 pcm
- Unihomes Bills package available upon request

**£720 PCM**

**Available: 2nd September 2026**

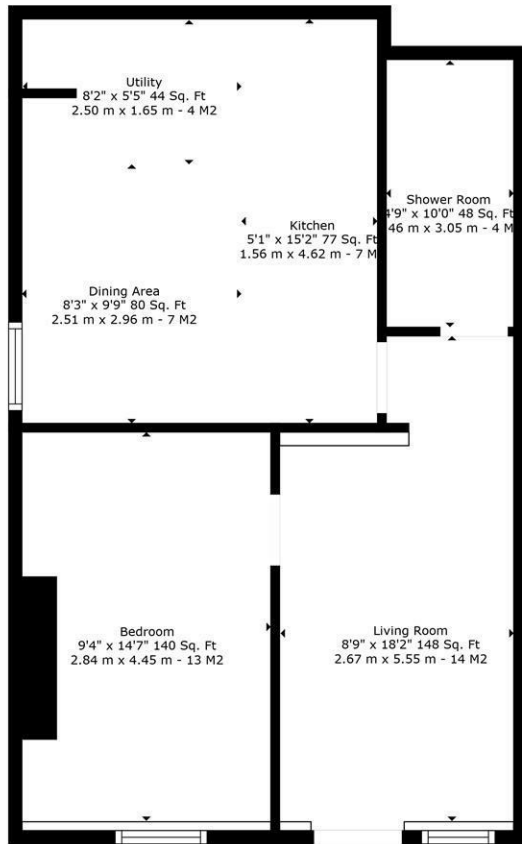

**TOTAL: 554 sq. ft, 52 m2**  
 381 CROOKESMOOR ROAD, GARDEN FLAT: 554 sq. ft, 52 m2

Sizes And Dimentions Are Approximate. Actual May Vary

Energy Efficiency Rating		Current	Potential
Very energy efficient - lower running costs			
(92 plus) A			
(81-91) B			
(69-80) C			
(55-68) D		68	78
(39-54) E			
(21-38) F			
(1-20) G			
Not energy efficient - higher running costs			
<b>England &amp; Wales</b>	EU Directive 2002/91/EC		

Environmental Impact (CO <sub>2</sub> ) Rating		Current	Potential
Very environmentally friendly - lower CO2 emissions			
(92 plus) A			
(81-91) B			81
(69-80) C			
(55-68) D		67	
(39-54) E			
(21-38) F			
(1-20) G			
Not environmentally friendly - higher CO2 emissions			
<b>England &amp; Wales</b>	EU Directive 2002/91/EC		