

TO LET

231 Milliners Wharf, 2 Munday Street, Manchester, Greater Manchester, M4 7BG

£775 PCM



RESIDE
MANCHESTER

- One Double Bedroom
- Private Balcony
- Available 4th May
- 24 Hour Concierge
- Video Tour Available
- Sixth Floor
- Furnished
- EPC Rating C
- Seconds away from New Islington Metrolink

Sixth Floor
Approx. 470.8 sq. feet

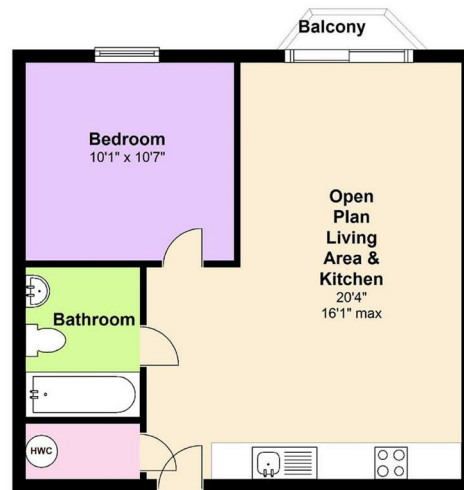

Total area: approx. 470.8 sq. feet

Directions

THE PROPERTY

VIDEO TOUR AVAILABLE. A furnished one bedroom apartment located on the 6th floor of the Milliners Wharf development in the heart of New Islington, on the banks of the Ashton Canal. The apartment is superbly presented and benefits from a private balcony and 24 hour concierge. Available 4th May.

SITUATION



Fees

Please contact the office for further details on holding deposits and the Tenant Fee Act 2019.