



01452 690553



sales@applebys.estate



www.applebysestateagents.co.uk



### **3 White Hart Cottages , Aston Crews, HR9 7LW**

**£325,000**

This is one of those “one in a million” properties, if you are searching for a rural home with views this one is it!

As a modern THREE bedroom cottage there is OPEN PLAN living space and VIEWS over the Herefordshire countryside. (Planning permission has been granted to extend if required) \*\*\*CHAIN FREE\*\*\*

Entrance/Sitting Room 15'9 x 7'8 (4.80m x 2.34m)

Kitchen/Dining Room 18'4 x 15'9 (5.59m x 4.80m)

Bedroom 2 10'5 x 9'5 (3.18m x 2.87m)

Bedroom 1 13'8 x 11'0 (4.17m x 3.35m )

Bedroom 13'8 x 11'0 (4.17m x 3.35m)

Bathroom

## OUTSIDE

The driveway is opposite the property providing an abundance of OFF ROAD PARKING.

The main entrance, accessed via a shared walkway, also leads to the rear of the property. The SOUTH WESTERLY facing rear garden is all enclosed, mostly laid to lawn, with a large decking area, the stunning views from here can be enjoyed over the countryside.

## Services

Mains water, gas central heating.

Shared Treatment plant treatment plant the two neighbouring properties at a shared cost of approx. £150.00 PA.

Herefordshire County Council tax band C

## Useful info

The treatment plant has been replaced

A new flat roof has been recently upgraded.

Planning permission for the extension can be viewed online on the Herefordshire County Council website ref number (P200763/AM)

The footings have already been laid in readiness.

## Tenure

Freehold

Floor Plan

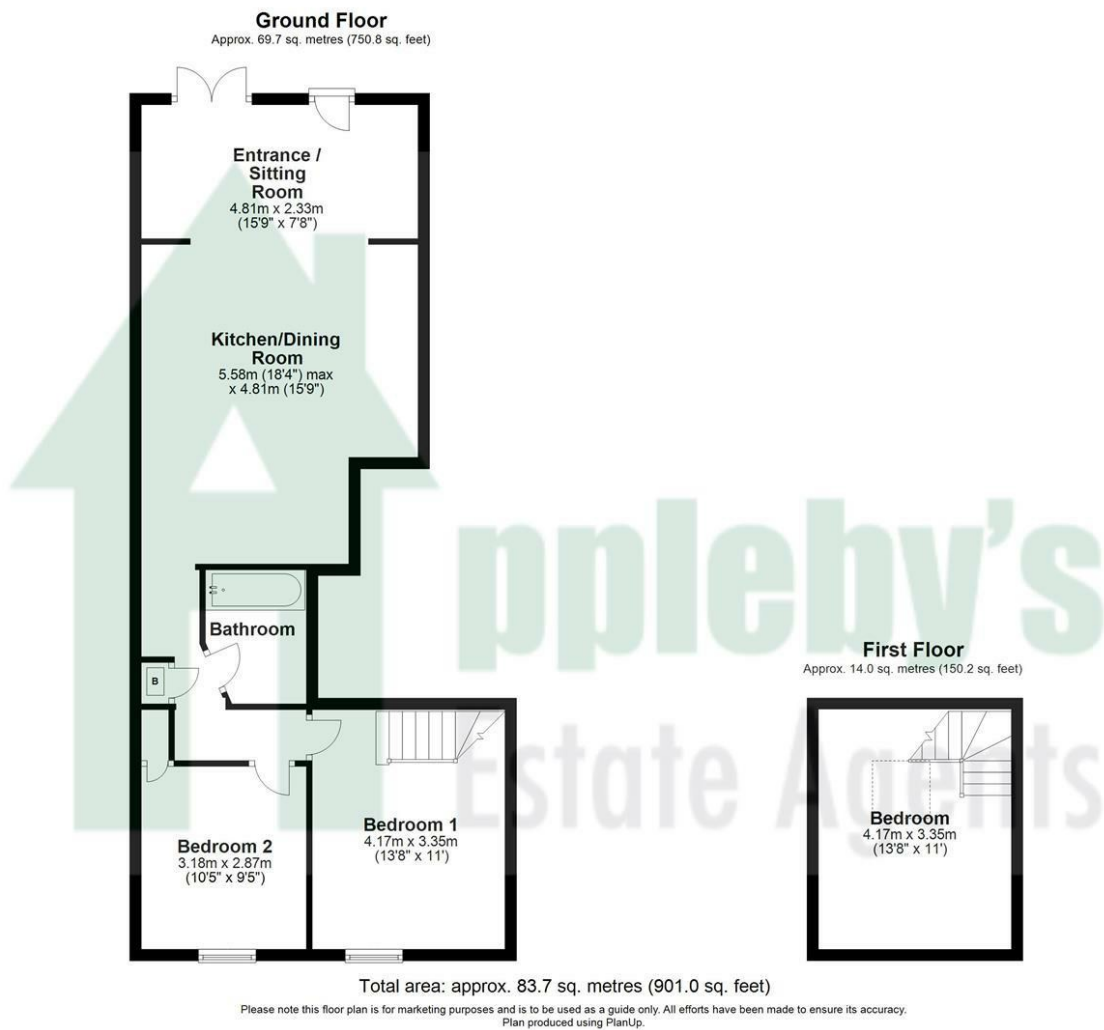

Area Map



Energy Efficiency Graph

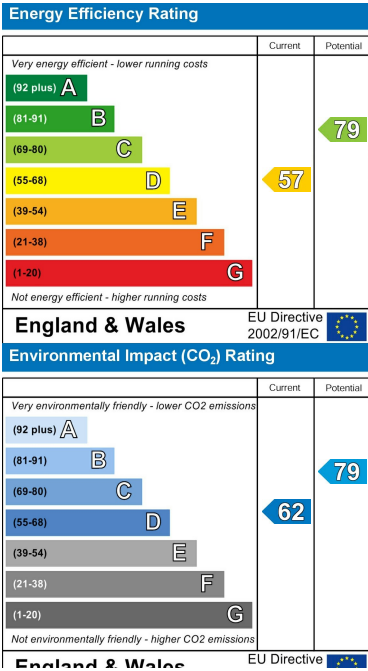

These particulars, whilst believed to be accurate are set out as a general outline only for guidance and do not constitute any part of an offer or contract. Intending purchasers should not rely on them as statements of representation of fact, but must satisfy themselves by inspection or otherwise as to their accuracy. No person in this firms employment has the authority to make or give any representation or warranty in respect of the property.