



5 Claridge Close, Abbeydale, GL4 4AT
£450,000



This extended four-bedroom detached house is ideal for a growing family!

The property has been thoughtfully extended to include a spacious en suite master bedroom. Additionally, the home boasts two reception rooms, which can be tailored to suit your family's needs, whether that be for entertaining guests or creating a comfortable workspace for those who work from home.

The location is particularly appealing, situated off the well-regarded Wheatridge in no-through road.

The surrounding area offers a variety of shops, schools, and recreational facilities, catering to all aspects of family life.



- Porch
- Cupboard
- Living Room
14'8 x 9'11 (4.47m x 3.02m)
- Kitchen/Breakfast Room
16'7 x 10'11 (5.05m x 3.33m)
- Family Room
10'5 x 9'11 (3.18m x 3.02m)
- Dining Room
10'1 x 9'0 (3.07m x 2.74m)
- Bathroom



- Bedroom 1
11'9 x 10'3 (3.58m x 3.12m)
- Ensuite
- Bedroom 2
12'10 x 10'1 (3.91m x 3.07m)
- Bedroom 3
12'1 x 8'2 (3.68m x 2.49m)
- Bedroom 4
9'0 x 8'4 (2.74m x 2.54m)
- Shower Room

OUTSIDE
Situating just off the Wheatridge in a no through road, driveway provides parking for numerous vehicle's with further double gates to more parking and garage. The landscaped rear garden is all enclosed a large patio and pathway leads to a further seating area to the rear the rest of the garden is laid to Astro turf. personnel door leads into the garage.

- Services**
Mains drainage , gas central heating
Gloucester City Council tax band C
- Tenure**
Freehold

Floor Plan

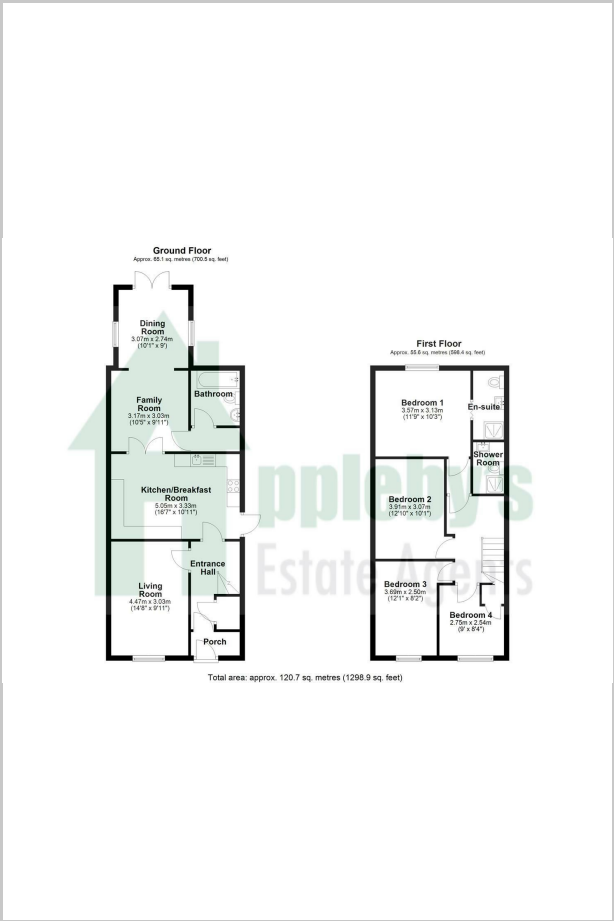

Energy Efficiency Graph

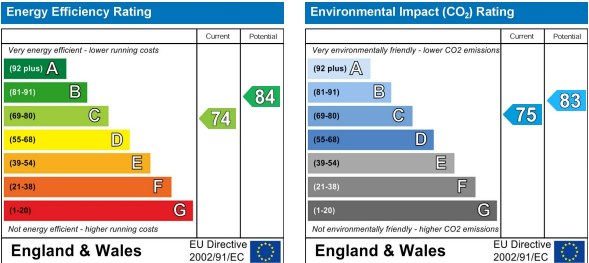

These particulars, whilst believed to be accurate are set out as a general outline only for guidance and do not constitute any part of an offer or contract. Intending purchasers should not rely on them as statements of representation of fact, but must satisfy themselves by inspection or otherwise as to their accuracy. No person in this firms employment has the authority to make or give any representation or warranty in respect of the property.