



01452 690553



sales@applebys.estate



www.applebysestateagents.co.uk



14 Typhoon Way

, Brockworth, GL3 4DY

£135,000



An Ideal first time buy in Coopers Edge !

Offered for sale within this purpose built ground floor self contained apartment. The property has two entrances (one from the street and one from the rear) and offers a well configured accommodation of a double bedroom, bathroom, fitted kitchen and lounge/diner and a single garage***CHAIN FREE***



Entrance Hall

Lounge/Dining Room 16'10 x 13'6 (5.13m x 4.11m)

Kitchen 8'0 x 6'9 (2.44m x 2.06m)

Bedroom 10'7 x 10'3 (3.23m x 3.12m)

Bathroom

OUTSIDE

Access to the property is via the main front entrance
there is also a rear access into the communal hall
Garage is to the rear of the property

Services

Maintenance and Service charges-Guinness
Partnership £76.00 PCM approx
Stroud District Council Tax band A

Tenure

Leasehold-107 years remaining

Area Map



Floor Plans

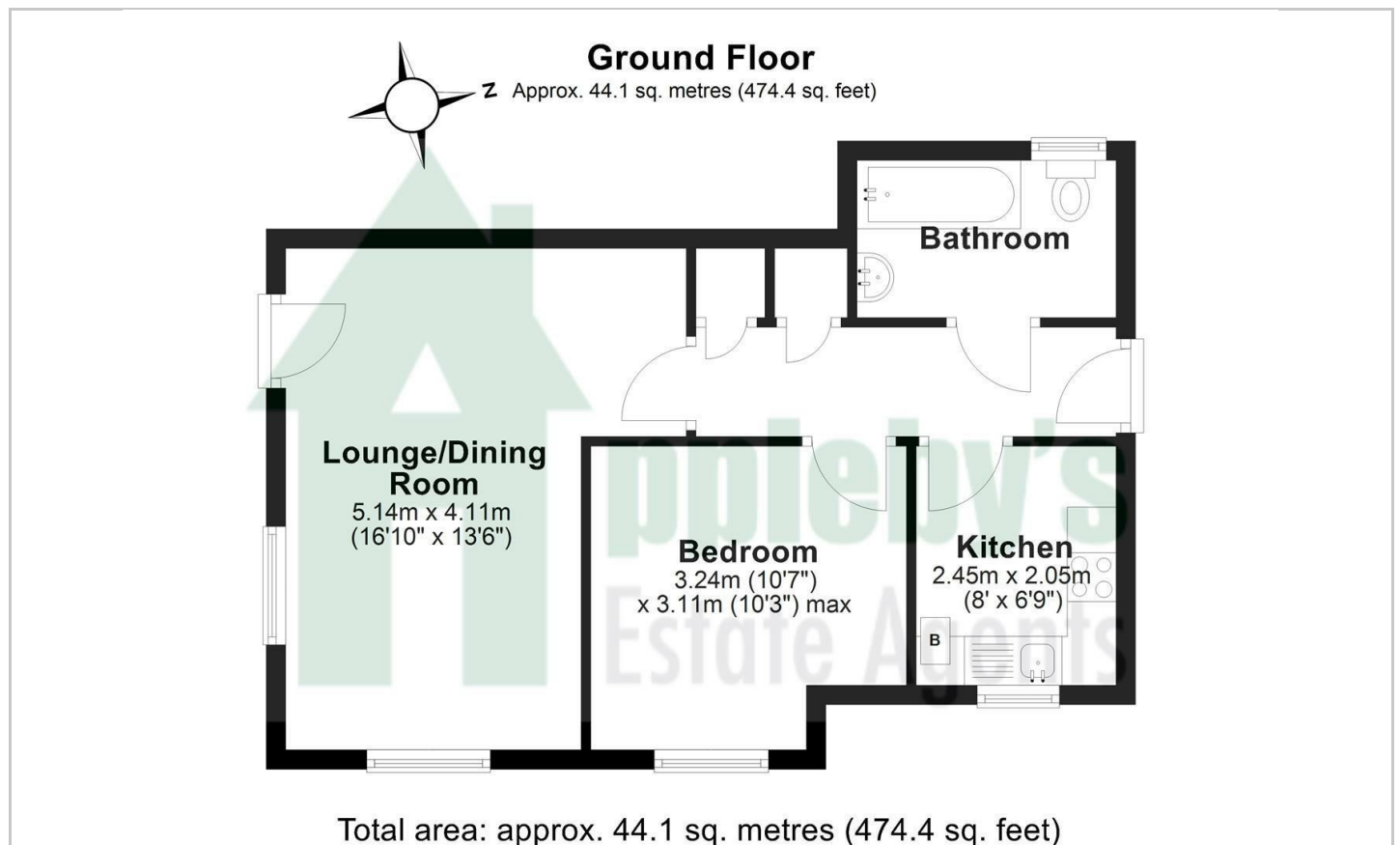

Energy Efficiency Graph

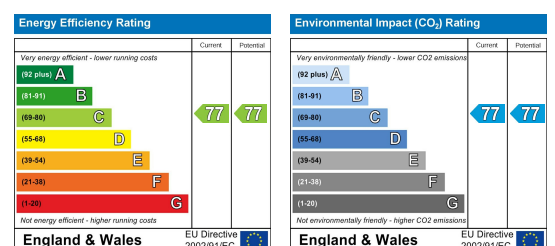

These particulars, whilst believed to be accurate are set out as a general outline only for guidance and do not constitute any part of an offer or contract. Intending purchasers should not rely on them as statements of representation of fact, but must satisfy themselves by inspection or otherwise as to their accuracy. No person in this firm's employment has the authority to make or give any representation or warranty in respect of the property.