



01452 690553

sales@applebys.estate

www.applebysestateagents.co.uk



Flat 1, Hubbards Place Russell Street

, Gloucester, GL1 1NE

£145,000



This charming basement flat on Russell Street presents an excellent opportunity for first-time buyers or those seeking a buy-to-let investment.

The property boasts a prime location, offering easy access to Gloucester Train Station, the vibrant new Forum development, and the popular Gloucester Quays, making it an ideal choice for those who appreciate convenience and urban living***CHAIN FREE***



Sitting Room 18'3 x 12'8 (5.56m x 3.86m)
Kitchen 6'8 x 6'7 (2.03m x 2.01m)
Bedroom 15'1 x 13'7 (4.60m x 4.14m)
Ensuite Shower Room
OUTSIDE
The property benefits its own court yard garden.
Services
Main drainage, gas central heating
Gloucester City Council tax band A
Tenure
Leasehold 999 years remaining

Area Map



Floor Plans

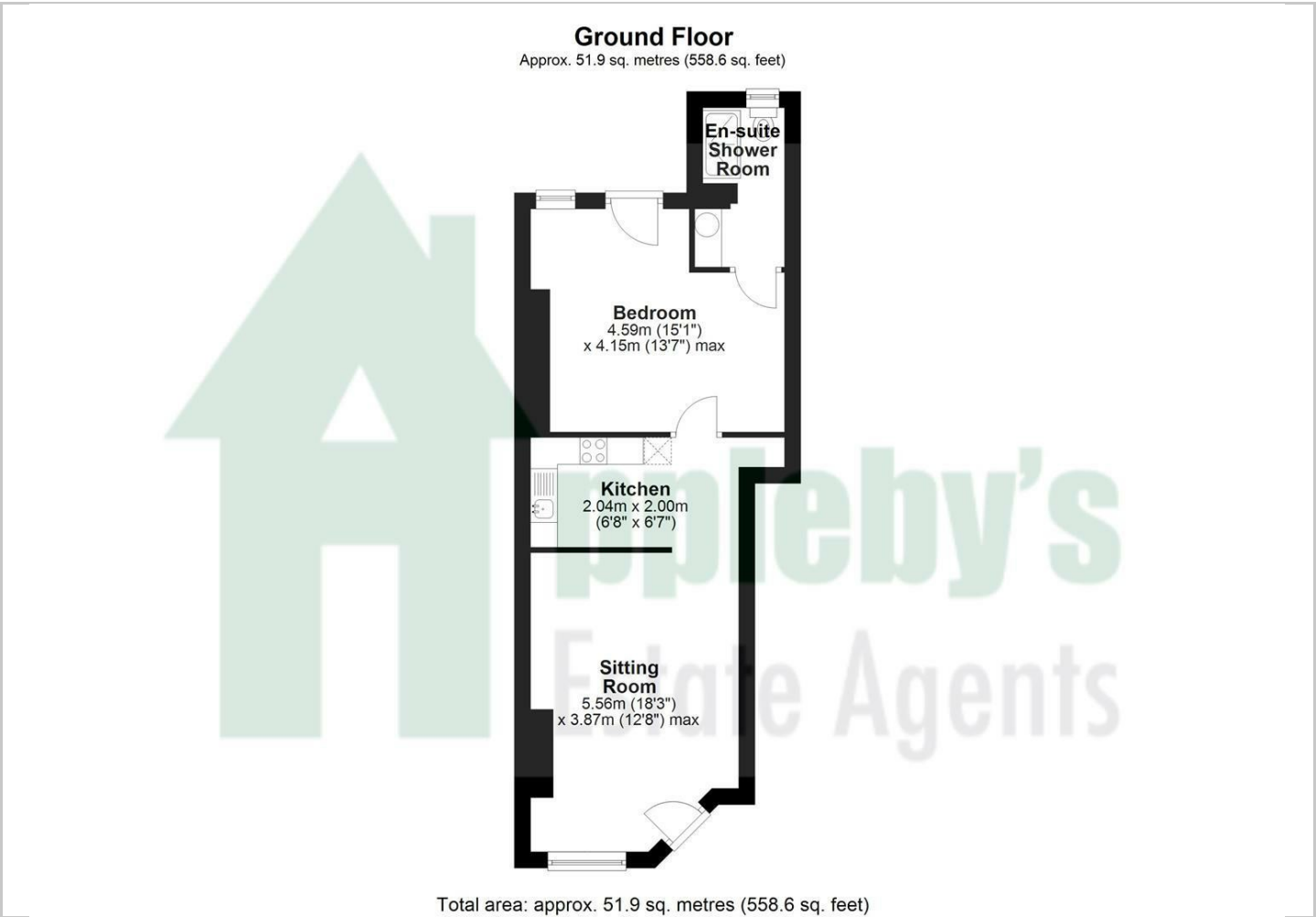

Energy Efficiency Graph

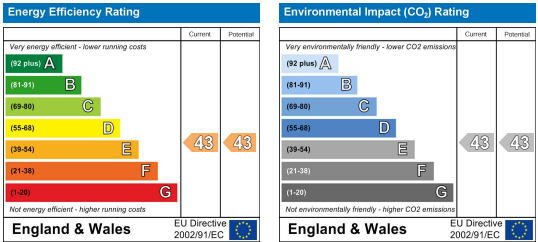

These particulars, whilst believed to be accurate are set out as a general outline only for guidance and do not constitute any part of an offer or contract. Intending purchasers should not rely on them as statements of representation of fact, but must satisfy themselves by inspection or otherwise as to their accuracy. No person in this firms employment has the authority to make or give any representation or warranty in respect