



01452 690553



sales@applebys.estate



www.applebysestateagents.co.uk



Hopeswood Park Gloucester Road

, Longhope, GL17 0LF

£110,000



This very well presented TWO bedroom DETACHED park home is for the OVER 55's situated on a POPULAR RESIDENTIAL site, Whether you're looking for a permanent residence, this park home in Longhope presents a fantastic opportunity to embrace a more relaxed way of living. ****CHAIN FREE****

Don't miss out on the chance to make this charming property your own and experience the beauty of village life.



Living Room 17'11 x 11'7 (5.46m x 3.53m)

Kitchen 11'7 x 9'8 (3.53m x 2.95m)

Bedroom 1 11'8 x 10'6 (3.56m x 3.20m)

Bedroom 2 9'3 x 6'4 (2.82m x 1.93m)

Bathroom

OUTSIDE

To the front there is gated access leading into the garden having paving and artificial grass, flower borders, young fruit trees and trellis fencing. At the side is a storage area with shed. The rear garden has patio and artificial grass, side access gate and hedged boundaries.

Services

Mains water, electric, private drainage. and LPG heating.

Forest of Dean District Council tax band A

Tenure

Leasehold

Ground rent is payable at £200.00 (approx.)

NO PETS

Area Map

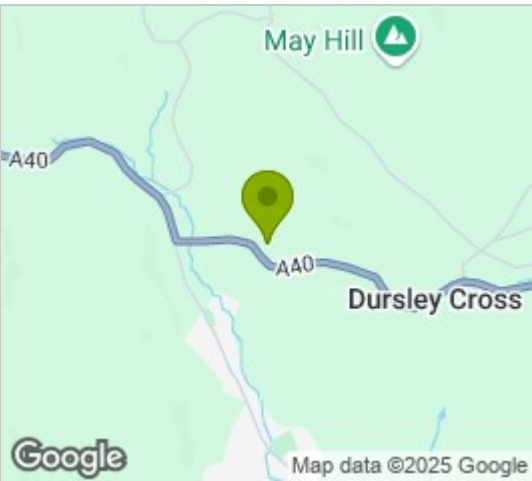

Floor Plans

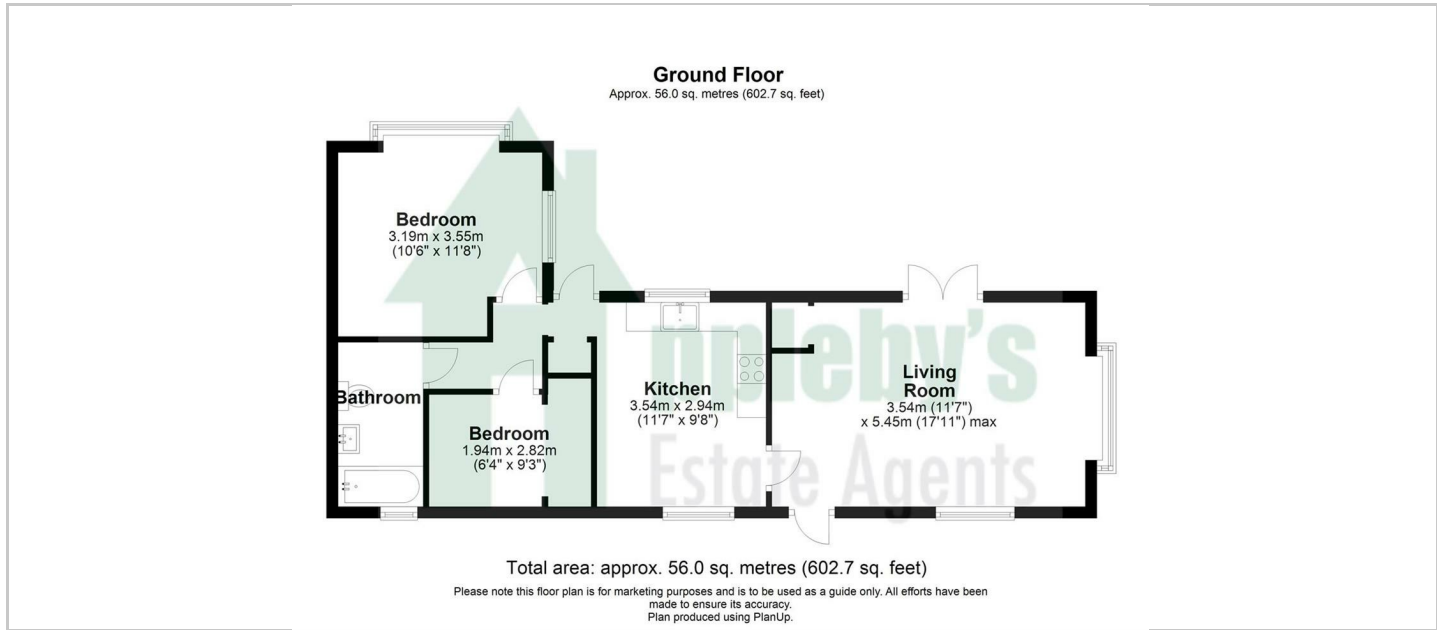

Energy Efficiency Graph

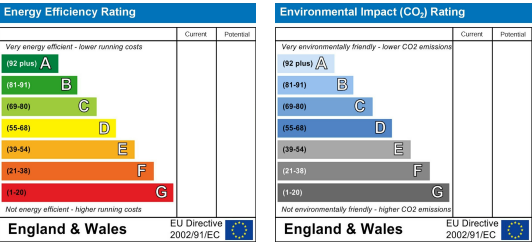

These particulars, whilst believed to be accurate are set out as a general outline only for guidance and do not constitute any part of an offer or contract. Intending purchasers should not rely on them as statements of representation of fact, but must satisfy themselves by inspection or otherwise as to their accuracy. No person in this firms employment has the authority to make or give any representation or warranty in respect of the property.