



01452 690553



sales@applebys.estate



www.applebysestateagents.co.uk



**26 Palmer Avenue, Abbeymead, GL4 5BH**

**£385,000**

Are you searching for a FOUR bedroom DETACHED home in ABBEYMEAD?

This is a very well presented family home. Benefits include ENSUITE TO MASTER BEDROOM, downstairs WC, conservatory and SOUTH facing garden.

Located in the sought-after area of Abbeymead, this property offers easy access to local amenities.

## Entrance Hall

Lounge 14'5 x 12'0 (4.39m x 3.66m)

Kitchen/Dining Room 15'1 x 9'10 (4.60m x 3.00m)

Conservatory 15'1 x 9'0 (4.60m x 2.74m)

## Cloakroom

Garage 16'0 x 8'1 (4.88m x 2.46m)

Bedroom 1 16'5 x 8'1 (5.00m x 2.46m)

## Shower Room

Bedroom 2 12'10 x 9'2 (3.91m x 2.79m)

Bedroom 3 9'4 x 8'1 (2.84m x 2.46m)

Bedroom 4 6'11 x 5'8 (2.11m x 1.73m)

## Bathroom

## OUTSIDE

The front driveway has ample off road parking leading to the single garage and gated side access to the rear garden.

The SOUTH FACING garden is all enclosed, large patio with a pathway, small lawned area either side leading to the garden shed.

## Services

Mains drainage, gas central heating

Solar Panels (owned) The panels benefit a feed in tariff of approx 0.74p Per KW per annum a return of up to £3000.00 has been received (approximate)

Gloucester City Council tax band C

## Tenure

Freehold

# Floor Plan

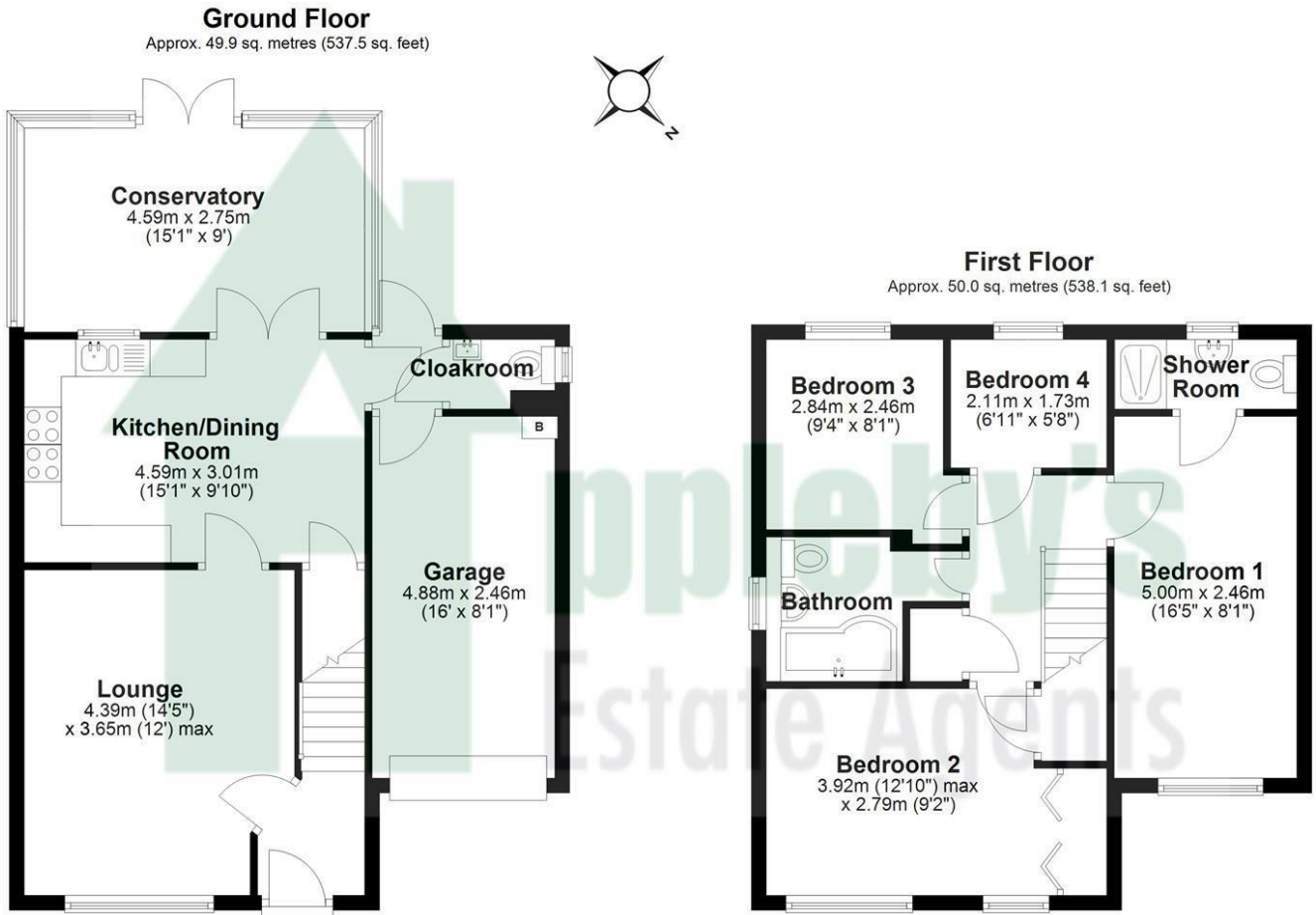

Total area: approx. 99.9 sq. metres (1075.6 sq. feet)

# Area Map

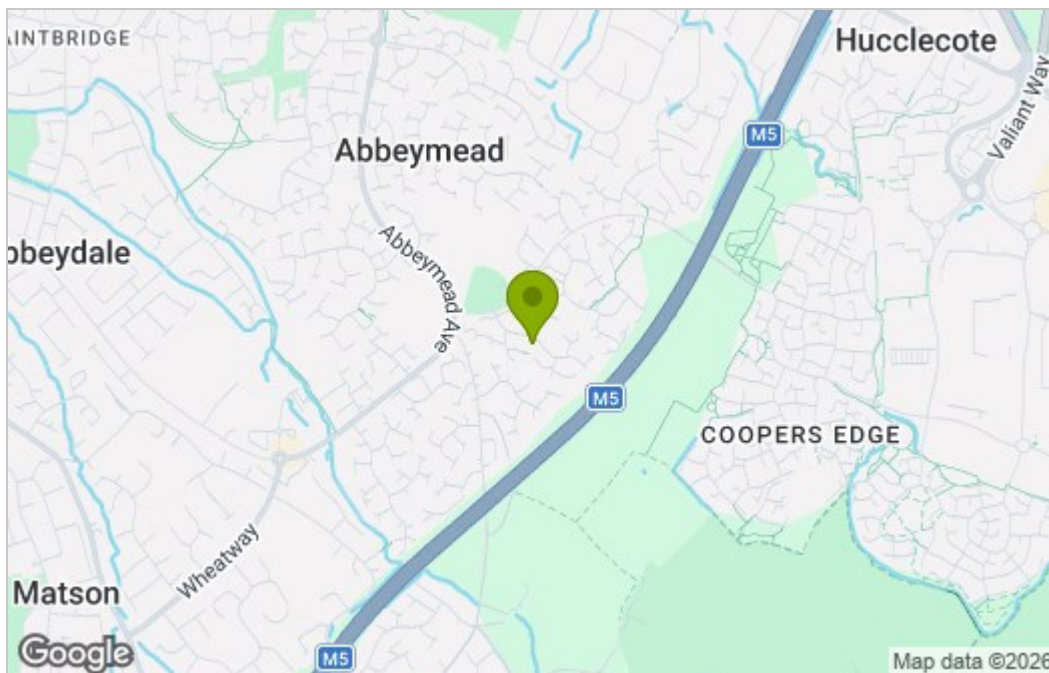

# Energy Efficiency Graph

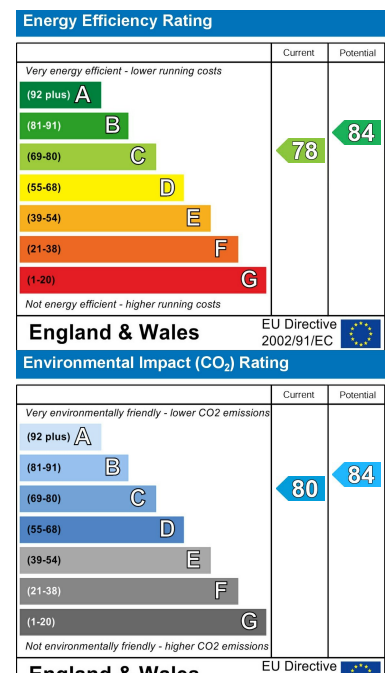

These particulars, whilst believed to be accurate are set out as a general outline only for guidance and do not constitute any part of an offer or contract. Intending purchasers should not rely on them as statements of representation of fact, but must satisfy themselves by inspection or otherwise as to their accuracy. No person in this firm's employment has the authority to make or give any representation or warranty in respect of the property.