



01452 690553



sales@applebys.estate



www.applebysestateagents.co.uk



31 Shawbury Avenue

Kingsway, Quedgeley, GL2 2BD

£135,000



This very well presented first-floor apartment ideal for those seeking a modern living space, the property is located near local amenities and key commuter routes , this is an ideal first time buy or buy to let investment.



Entrance Hall

Lounge 13'8 x 13'7 (4.17m x 4.14m)

Kitchen 9'11 x 5'10 (3.02m x 1.78m)

Bedroom 12'1 x 10'4 (3.68m x 3.15m)

Bathroom

OUTSIDE

Allocated parking space(110)to the rear of the building

Services

Mains Drainage, Gas Central Heating.
Gloucester City Council tax band A

Tenure

Leasehold-150 Years from 2006-131 years remaining
Maintenance Charges-Approximately £1,548.00 PA.
Ground Rent-Approximately £134.26 PA.

Area Map



Floor Plans

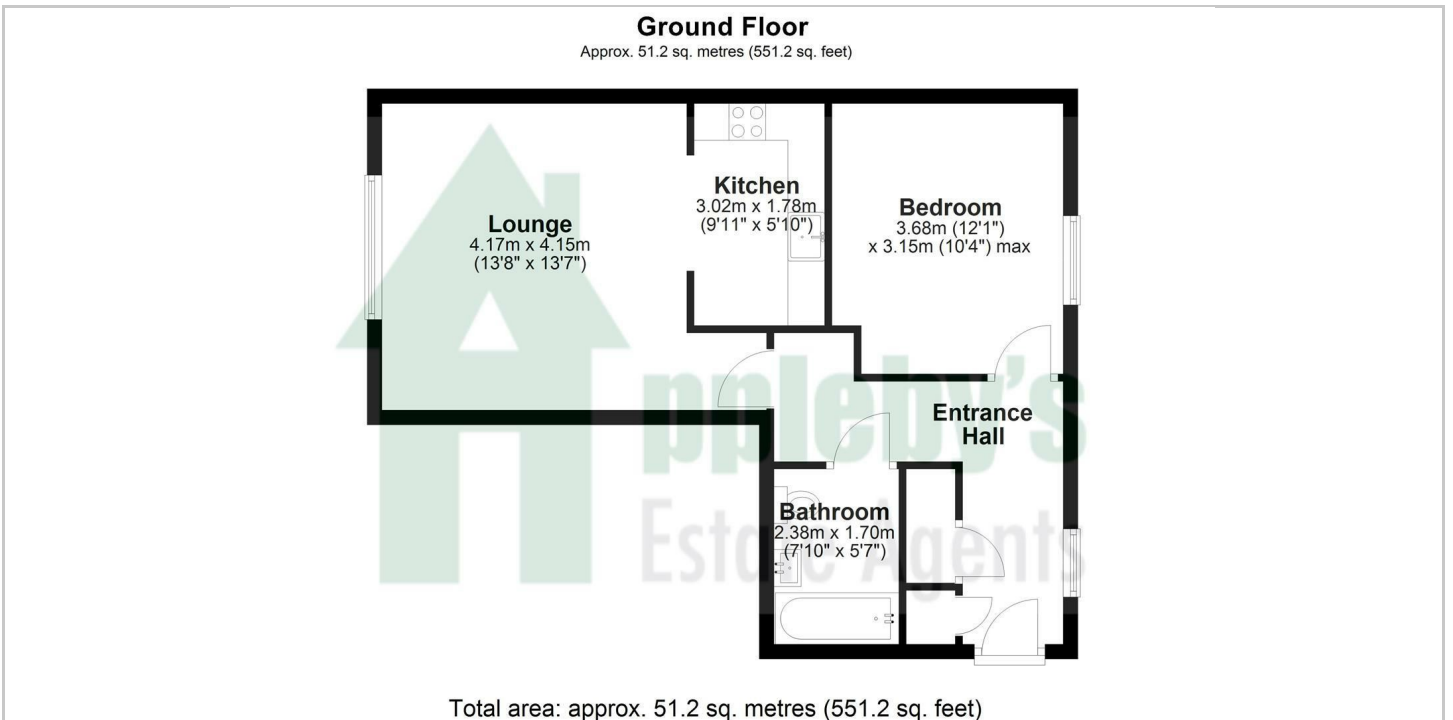

Energy Efficiency Graph

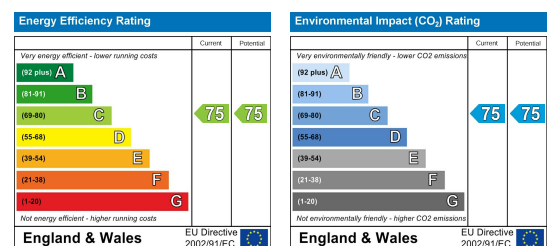

These particulars, whilst believed to be accurate are set out as a general outline only for guidance and do not constitute any part of an offer or contract. Intending purchasers should not rely on them as statements of representation of fact, but must satisfy themselves by inspection or otherwise as to their accuracy. No person in this firm's employment has the authority to make or give any representation or warranty in respect of the property.