



April Cottage Old Hill
, Longhope, GL17 0PF

£575,000



This stunning country home has been beautifully extended and fully renovated to offer the perfect blend of character and contemporary living.

At the heart of the home is a spacious kitchen/dining/family room, designed for modern lifestyles and ideal for both everyday living and entertaining. Bi-fold doors overlook the picturesque views of the garden and surrounding countryside, bringing the outdoors in.

Set in a charming rural village, this property offers peace and privacy. If you're looking for a home with views in a tranquil, countryside location—this is the one.

Entrance Hall

Lounge
15'1 x 12'2 (4.60m x 3.71m)

Kitchen/Dining/Family Room
23'9 x 20'10 (7.24m x 6.35m)

Utility Room
10'8 x 7'7 (3.25m x 2.31m)

Bedroom 1
18'10 x 11'3 (5.74m x 3.43m)

Ensuite

Bedroom 2
13'9 x 13'5 (4.19m x 4.09m)

Bedroom 3
12'0 x 10'11 (3.66m x 3.33m)





Bathroom

OUTSIDE

The front of property has a large gravelled driveway with an abundance of off road parking, side access to the rear garden. The Garden has been completely landscaped a large patio with the sleepers edges and wide steps up lead to the first lawn and then the top lawn, a fantastic view of the surrounding countryside can be enjoyed at all angles.

Services

Mains drainage, Air source heat pump.
Forest Of Dean district council tax band D

What3Words:
windmills.dried.automatic

Tenure
Freehold



Floor Plan

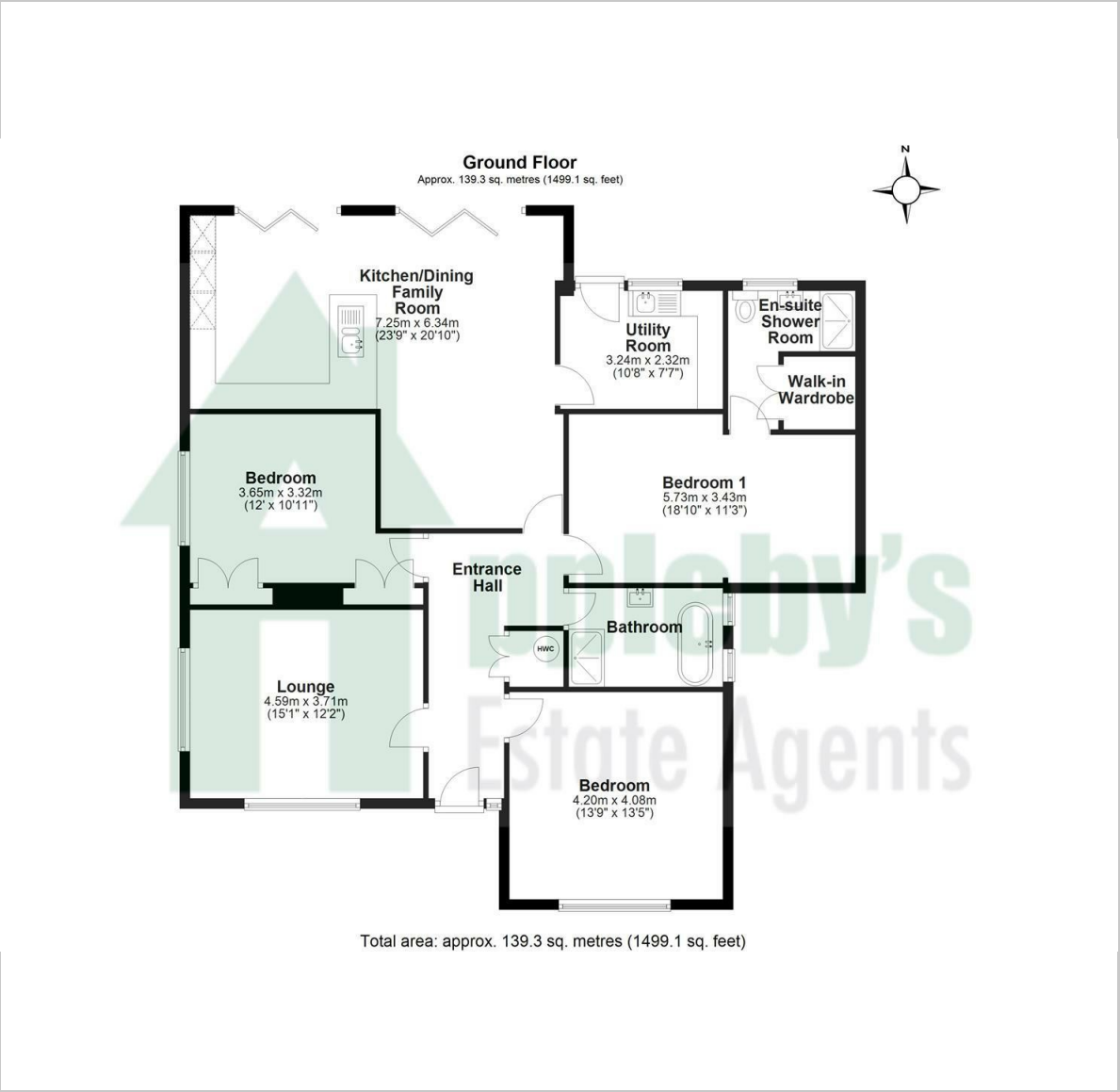

Viewing

Please contact our Appleby`s Office on 01452 690553 if you wish to arrange a viewing appointment for this property or require further information.

These particulars, whilst believed to be accurate are set out as a general outline only for guidance and do not constitute any part of an offer or contract. Intending purchasers should not rely on them as statements of representation of fact, but must satisfy themselves by inspection or otherwise as to their accuracy. No person in this firms employment has the authority to make or give any representation or warranty in respect of the property.

Area Map

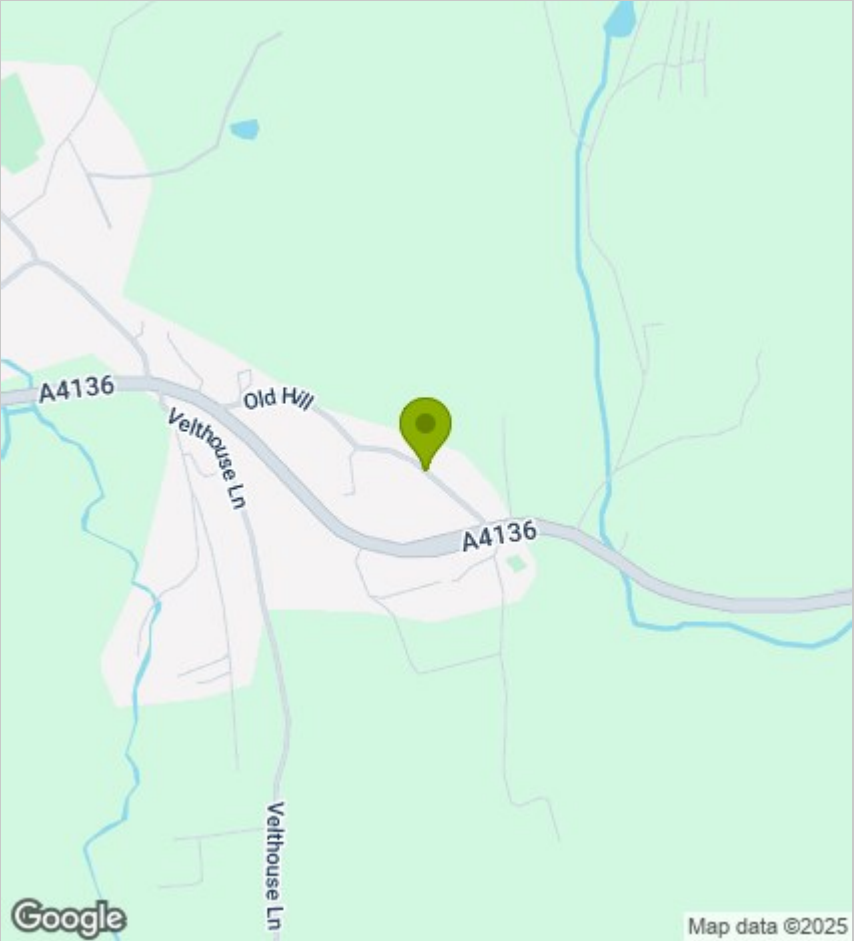

Energy Efficiency Graph

