



01452 690553



sales@applebys.estate



www.applebysestateagents.co.uk



20 Rectory Close, Ashleworth, GL19 4JT

£290,000

This modern two double bedroom house on Rectory Close is an opportunity for an affordable starter home in the sought after village of Ashleworth.

As you step inside, you will be greeted by a spacious and inviting entrance hall, leading to Kitchen & Lounge, the two double bedrooms are generously sized benefitting a recently landscaped rear garden.

Entrance Hall

Cloakroom

Lounge 14'4 x 13'0 (4.37m x 3.96m)

Kitchen 12'5 x 7'6 (3.78m x 2.29m)

Bedroom 1 14'4 x 10'10 (4.37m x 3.30m)

Bedroom 2 14'4 x 10'0 (4.37m x 3.05m)

Bathroom

OUTSIDE

The front of the property benefits from TWO allocated parking spaces.

The garden has been recently landscaped to a high standard, a composite decking with a small step up to the astroturf there is a garden shed fenced off at the rear benefitting gated access.

Services

Mains drainage and LPG gas communal supply metered.

Tewkesbury Borough Council tax band B
Community charge payable PA TBC.

Tenure

The property is currently owned as a 40% Shared Ownership, so is currently a leasehold property.

We will be selling the property as 100% ownership- FREEHOLD

Floor Plan

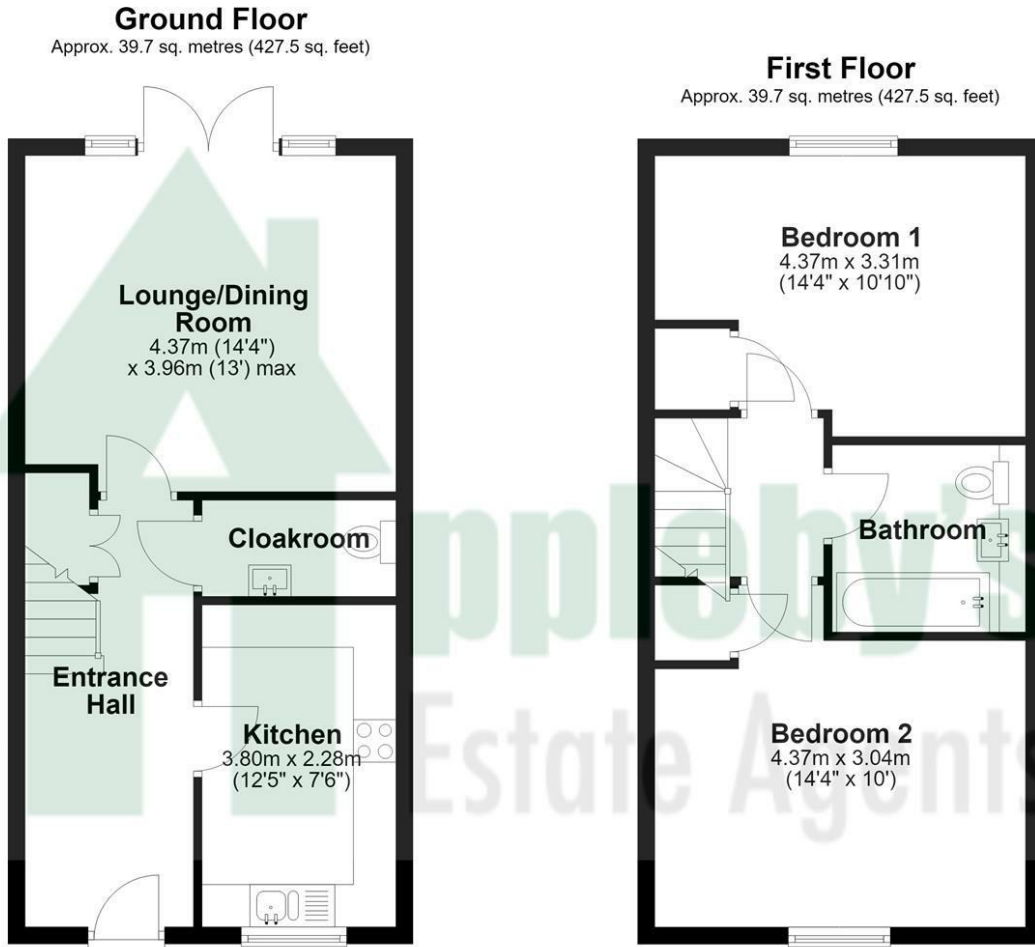

Total area: approx. 79.4 sq. metres (854.9 sq. feet)

Area Map



Energy Efficiency Graph

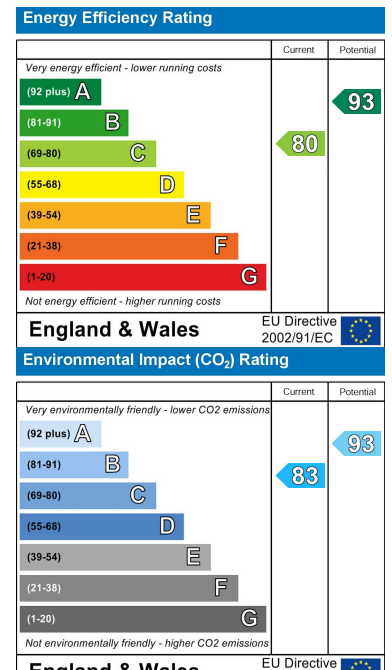

These particulars, whilst believed to be accurate are set out as a general outline only for guidance and do not constitute any part of an offer or contract. Intending purchasers should not rely on them as statements of representation of fact, but must satisfy themselves by inspection or otherwise as to their accuracy. No person in this firm's employment has the authority to make or give any representation or warranty in respect of the property.