



01452 690553



sales@applebys.estate



www.applebysestateagents.co.uk



Albion House, Alkerton, Eastington, GL10 3AA

£330,000

This charming three-bedroom cottage is a delightful blend of original character and modern living. As you step inside, you are welcomed into a spacious lounge/dining room, this area boasts a feature fireplace, an exposed brick wall, and a cosy log burner, creating a warm and inviting atmosphere perfect for family gatherings or quiet evenings in.

This property is brimming with charm and character, making it a wonderful family home. To fully appreciate the unique features and warm ambiance this cottage has to offer, we highly recommend scheduling a viewing. Don't miss the opportunity to make this delightful home your own in the heart of Eastington.

The Situation

Eastington offers rural village life with excellent communications with major routes leading to the principal towns and cities in the region. Eastington primary is close by, It is well served with village shops, and two public houses including the award winning 'The Badger'. The J.13 of the M5 is just one mile away. Stonehouse Railway station(3 miles) has direct train links to London (Paddington) approx. 90 minutes. Cam and Dursley railway station (5 miles) has a direct line to Bristol (Parkway & Temple Meads).

Entrance Hall

Lounge 21'4 x 12'1 (6.50m x 3.68m)

Kitchen/Dining Room 19'0 x 10'3 (5.79m x 3.12m)

Bedroom 1 10'10 x 12'3 (3.30m x 3.73m)

Bedroom 2 10'4 x 11'9 (3.15m x 3.58m)

Bedroom 3 9'6 x 6'9 (2.90m x 2.06m)

Bathroom

OUTSIDE

Gated side access leads to the court yard garden which is laid to patio with flower borders, mature trees and shrubs all enclosed.

Services

Mains drainage and gas central heating
Stroud District council tax band C

Tenure

Freehold

Floor Plan

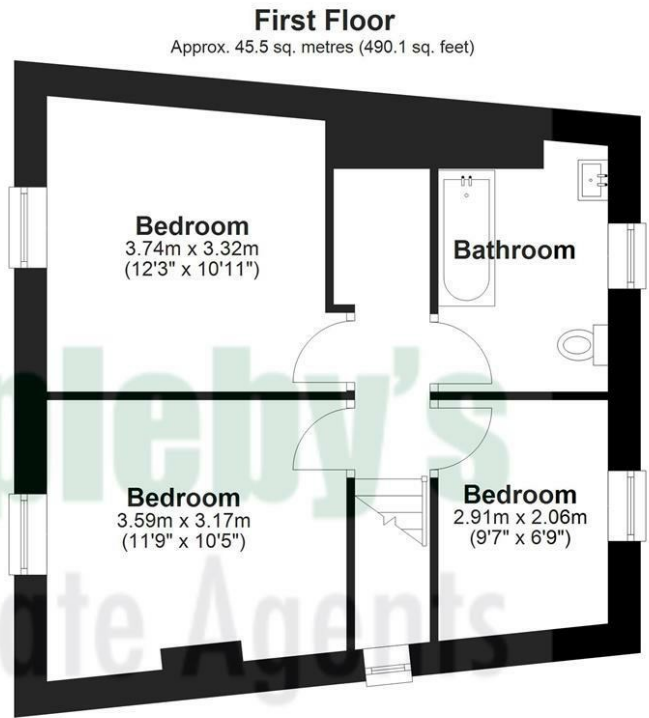
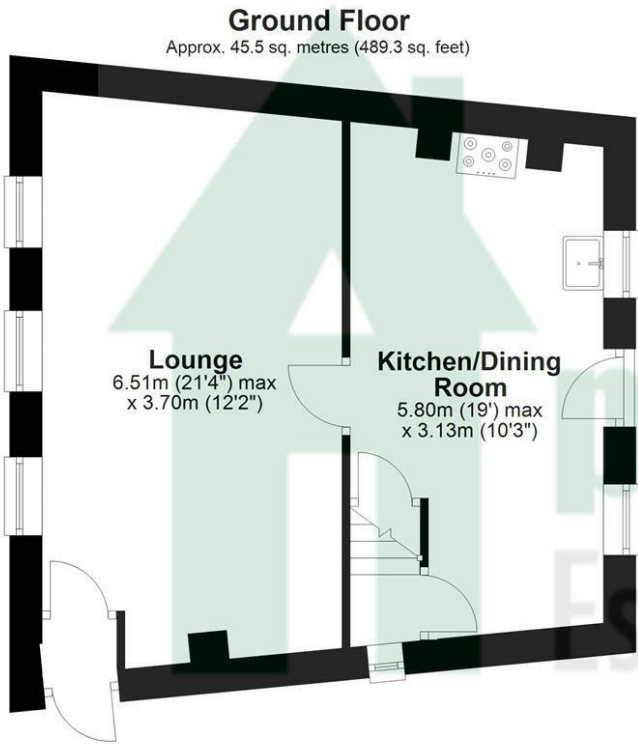

Total area: approx. 91.0 sq. metres (979.4 sq. feet)

Area Map

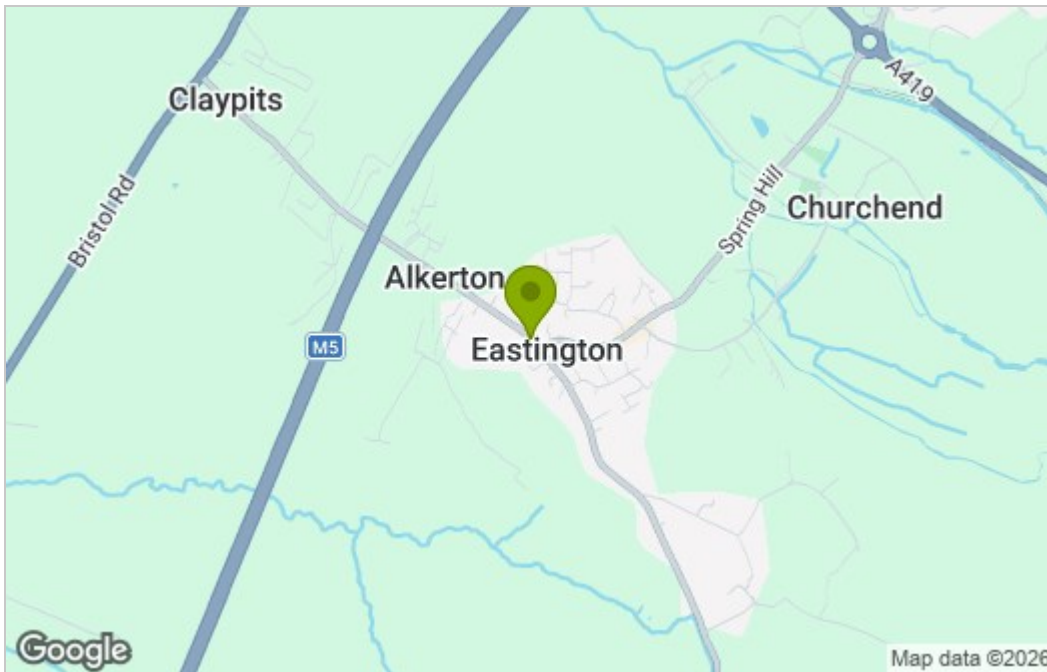

Energy Efficiency Graph

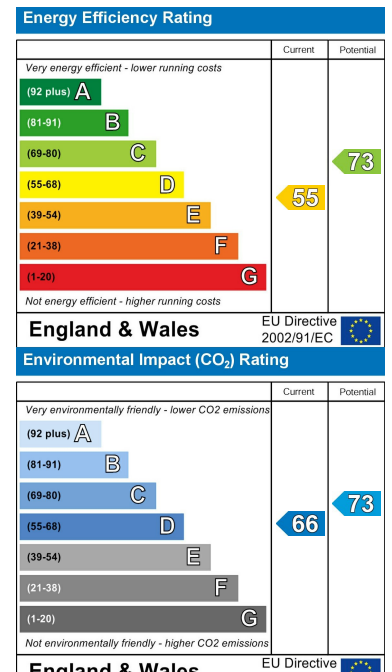

These particulars, whilst believed to be accurate are set out as a general outline only for guidance and do not constitute any part of an offer or contract. Intending purchasers should not rely on them as statements of representation of fact, but must satisfy themselves by inspection or otherwise as to their accuracy. No person in this firm's employment has the authority to make or give any representation or warranty in respect of the property.