



01452 690553



sales@applebys.estate



www.applebysestateagents.co.uk



**105 Southgate Street, Gloucester, GL1 1UT**

**£475,000**

An opportunity to acquire a mixed use versatile investment buy which includes a SHOP & FOUR FLATS.

The shop and flats are all let out so an ideal turn key investment right next to Gloucester Quays!

Total gross yield at asking price 10.7%

## Summary

The shop is on a long lease currently as a barber shop Rental £1200.00

The Flats are accessed via Norfolk Street, GL1 1US address's :

2 Norfolk Street GL1 1US

Flat 1,2 & 3 Norfolk Street, GL1 1US.

There is 2 x 1 beds and 2 x 2 beds Rental total £3250.00

Total gross rental £53,400 PA

Total gross yield at asking price 10.7% return

Shop Floor 19'8 x 19'0 (5.99m x 5.79m)

With rest room, WC & utility Area

## Ground Floor Flat

Two Bedroom Flat

## First Floor flat

Two one bed flats

## Second Floor

Two Bedroom flat

## OUTSIDE

Situated opposite Gloucester Quays on Southgate Street.

one parking space to the rear

## Services

Mains Drainage, Electric

Grade II listed.

Gloucester City Council

## Tenure

Freehold

## Floor Plan

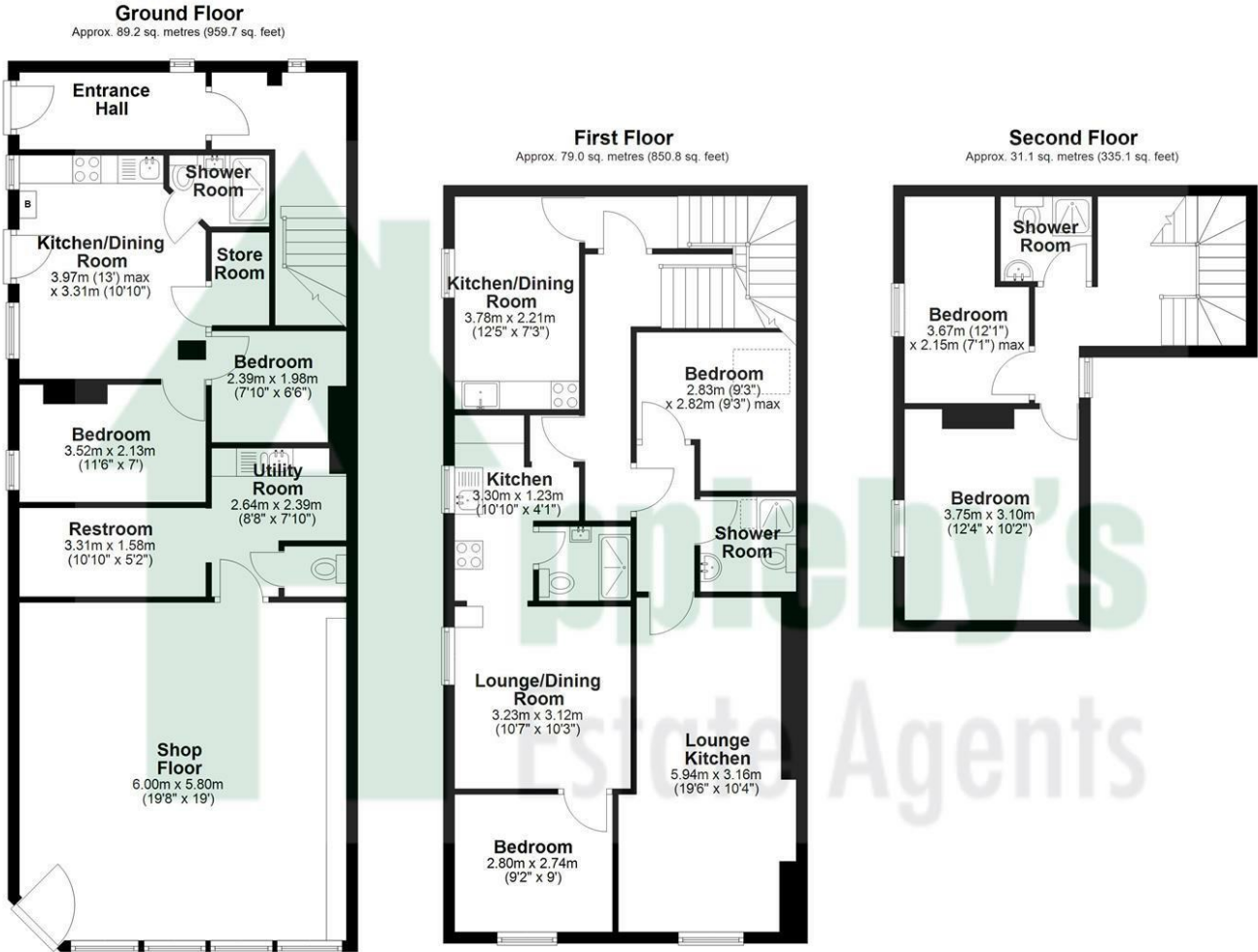

Total area: approx. 199.3 sq. metres (2145.6 sq. feet)

## Area Map



These particulars, whilst believed to be accurate are set out as a general outline only for guidance and do not constitute any part of an offer or contract. Intending purchasers should not rely on them as statements of representation of fact, but must satisfy themselves by inspection or otherwise as to their accuracy. No person in this firm's employment has the authority to make or give any representation or warranty in respect of the property.