



01452 690553



sales@applebys.estate



www.applebysestateagents.co.uk



6 Ashmead, Longlevens, GL2 9RU

£275,000

This delightful home presents an excellent opportunity for first-time buyers, offering the potential to put your own stamp on the property.

Situated in the popular Longlevens close to all amenities.

Entrance Hall

Kitchen 8'6 x 8'0 (2.59m x 2.44m)

Lounge/Dining Room 14'10 x 13'9 (4.52m x 4.19m)

Bedroom 1 10'11 x 8'6 (3.33m x 2.59m)

Bedroom 2 10'9 x 8'6 (3.28m x 2.59m)

Bedroom 3 6'6 x 6'0 (1.98m x 1.83m)

Shower Room

Garage 16'4 x 7'10 (4.98m x 2.39m)

OUTSIDE

Driveway to the front of the property leading to the garage.

The rear garden is mostly laid to lawn with a patio area and personnel door to the garage(There is potential to extend into the garage as it is attached to the house (subject to relevant permissions)

Services

Mains drainage and gas central heating

Gloucester City Council tax band C

Floor Plan

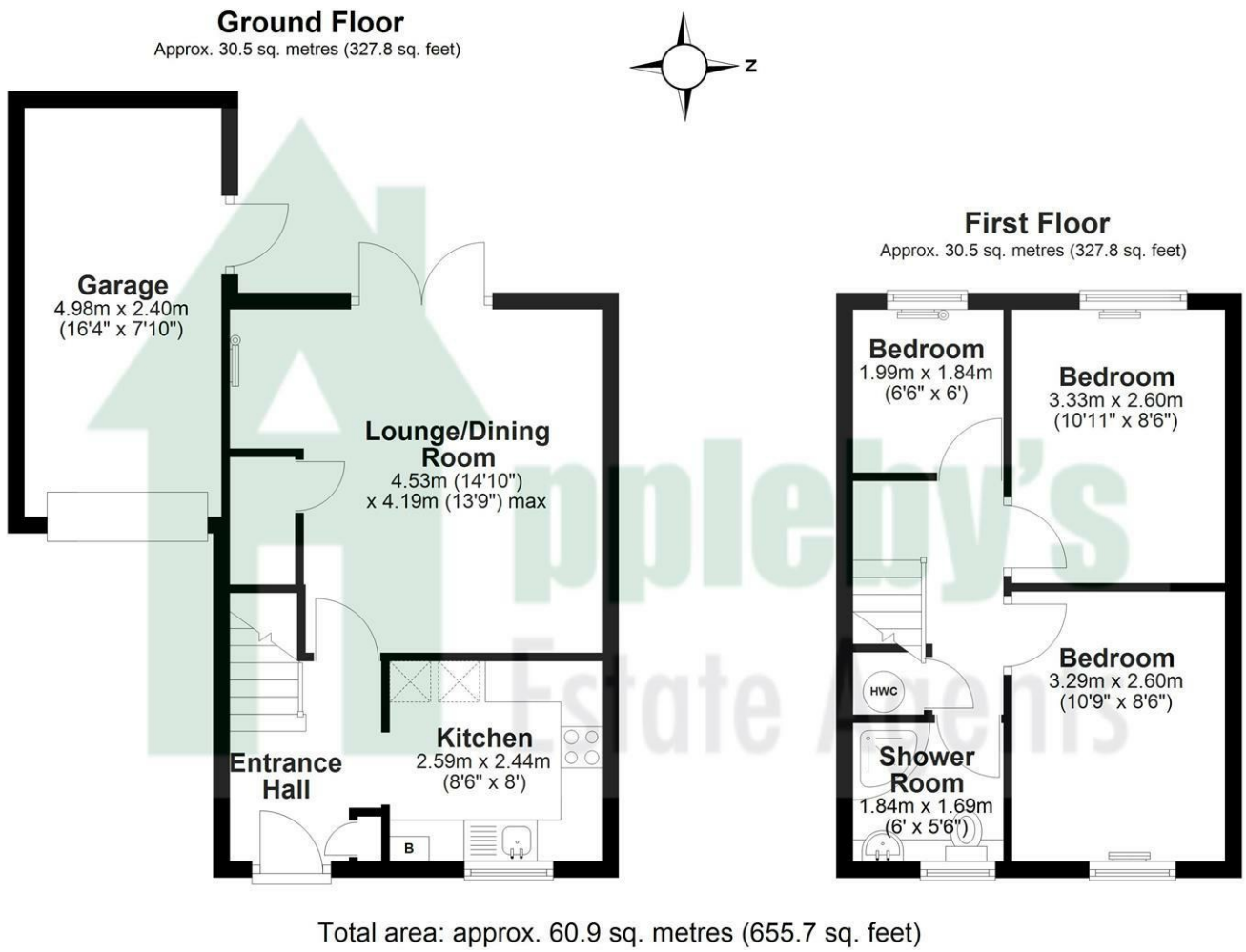

Area Map

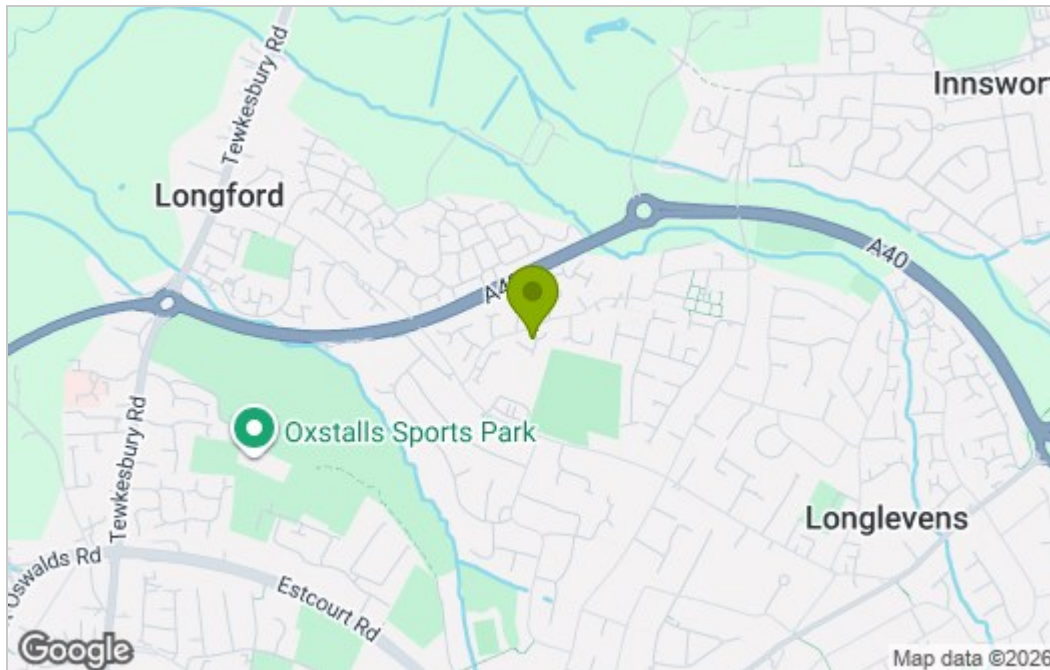

Energy Efficiency Graph

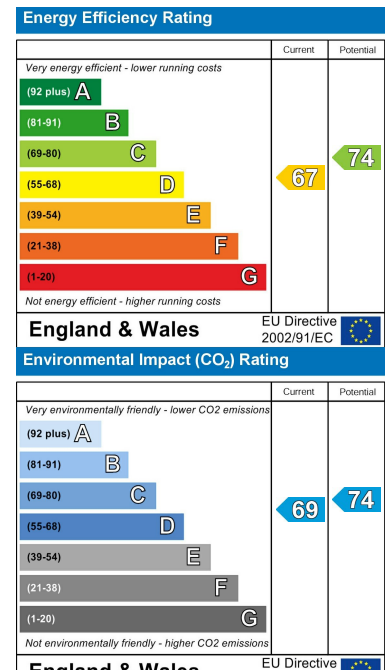

These particulars, whilst believed to be accurate are set out as a general outline only for guidance and do not constitute any part of an offer or contract. Intending purchasers should not rely on them as statements of representation of fact, but must satisfy themselves by inspection or otherwise as to their accuracy. No person in this firm's employment has the authority to make or give any representation or warranty in respect of the property.