



MAGGS
& ALLEN

46c Bishopthorpe Road, Horfield,
Bristol, BS10 5AD
£800 PCM

**** UNFURNISHED GROUND FLOOR APARTMENT FOR SINGLE OCCUPIER ****

Newly renovated ground floor apartment which offers well planned living accommodation for the single professional.

The UNFURNISHED accommodation briefly comprises: entrance hall with access to open plan living/kitchen area with wood flooring and integrated appliances, inner hall with separate WC and utility cupboard housing space for washing machine and DOUBLE bedroom with en suite shower and access to rear shared space

Further benefits include double glazing, modern slimline electric heating and ample parking to the front. SINGLE TENANT PLEASE

In order to apply for this property you will need a salaried income in excess of £24,000 per annum, a clear credit history and valid right to rent documents at the time of application including a share code from the UK Government if not a UK passport holder (for referencing purposes)



- GROUND FLOOR APARTMENT
- 1 DOUBLE BEDROOM
- OPEN PLAN LIVING SPACE
- FITTED KITCHEN
- SHOWER ROOM
- CONVENIENT LOCATION
- SINGLE PERSON ONLY
- AVAILABLE NOW

Price Per Month: £800 PCM

Council Tax Band: A

Local Authority: BRISTOL CC

Viewing: By appointment only.

Contact Us: 0117 949 9000

Important Notice: This information was provided at the time of instruction and may be incorrect or liable to change. Please contact the office to confirm any details.



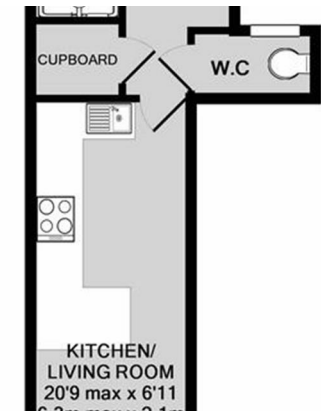
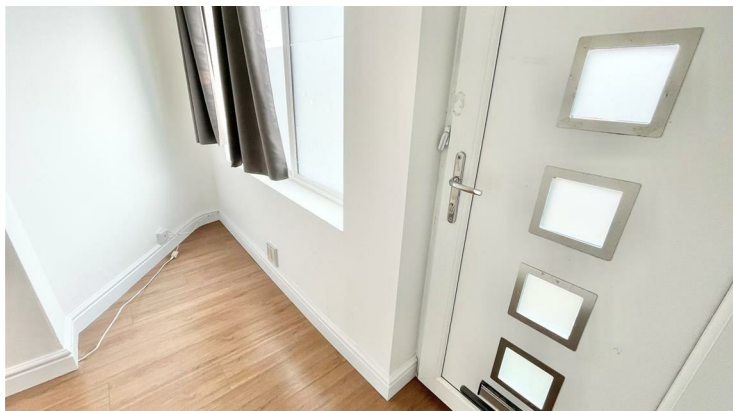

60 Northumbria Drive, Henleaze, Bristol, BS9 4HW
0117 949 9000
www.maggsandallen.co.uk | lettings@maggsandallen.co.uk



Maggs & Allen use all reasonable endeavours to supply accurate property information in line with the Consumer Protection from Unfair Trading Regulations 2008. These property details do not constitute any part of the offer or contract and all measurements are approximate. It should not be assumed that this property has all the necessary Planning, Building Regulations or other consents. Any services, appliances and heating system(s) listed have not been checked or tested. Please note that in some instances the photographs may have been taken using a wide angled lens and please be advised that any site plans used within our particulars are for illustrative purposes only and may not be to scale. Any distance from schools are for guidance only and you should make your own enquiries with the local authority.